

F.A.I. RTE.	SECTION	COUNTY	TOTAL SHEETS	SHEET NO.
80	06-BHBR	BUREAU	165	53
STA. 3699+50.00		TO STA. 3705+50.00		
FED. ROAD DIST. NO. 3 ILLINOIS FED. AID PROJECT				

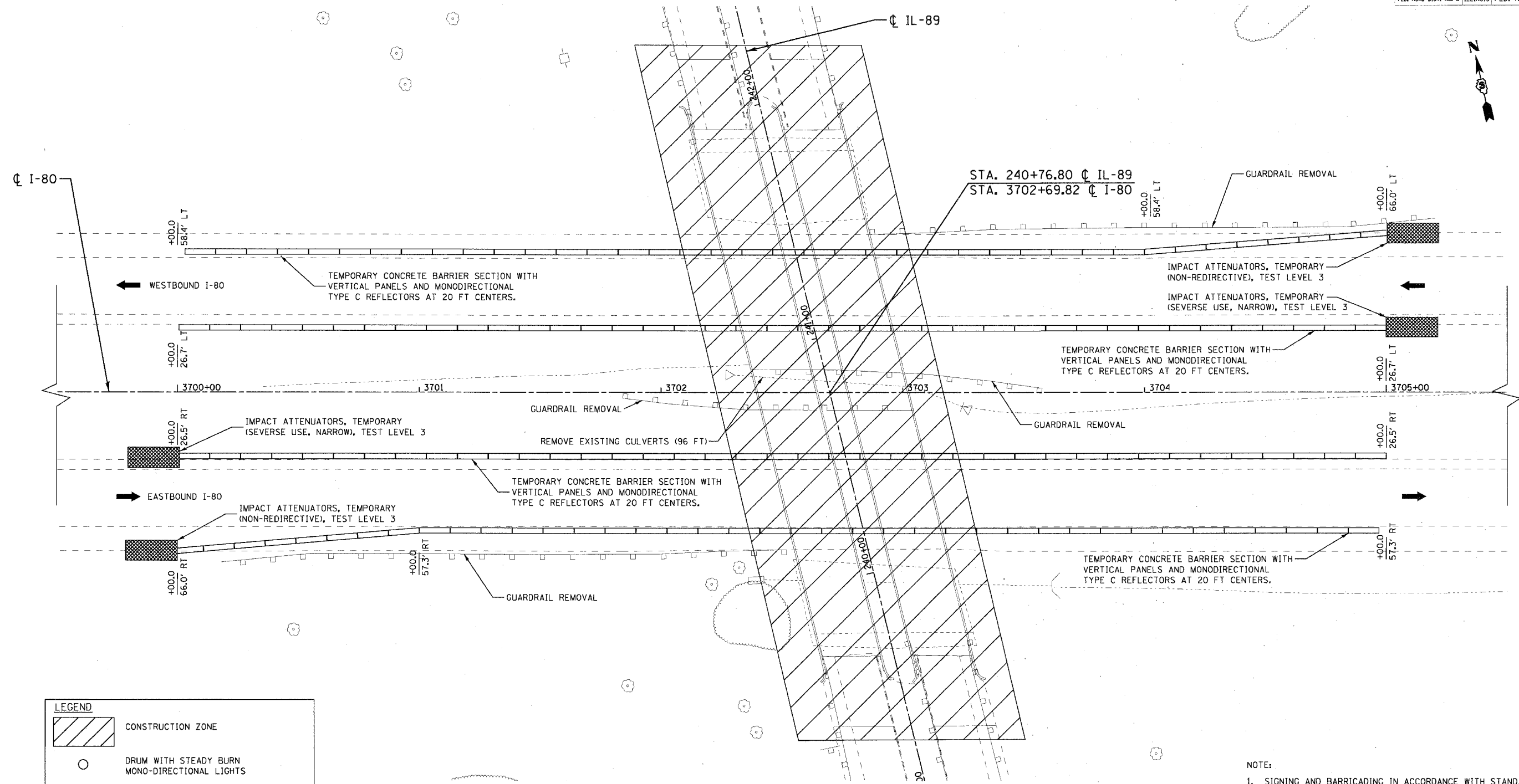

LEGEND	
	CONSTRUCTION ZONE
	DRUM WITH STEADY BURN MONO-DIRECTIONAL LIGHTS
	TRAFFIC DIRECTION
	TEMPORARY CONCRETE BARRIER WALL
	TYPE III BARRICADE

- NOTE:
- SIGNING AND BARRICADING IN ACCORDANCE WITH STANDARDS: 701101, 701400, 701406, DIST STND 701-1
  - TO BE PAID FOR AS TRAFFIC CONTROL INTERSTATE

REVISIONS	
NAME	DATE

ILLINOIS DEPARTMENT OF TRANSPORTATION  
 IL ROUTE 89 OVER I-80  
**MAINTENANCE OF TRAFFIC**  
**INTERSTATE 80**

VERT. NONE  
 SCALE: HORIZ. 1" = 20'  
 DATE: 08/10/07

DRAWN BY ACE/CAD  
 CHECKED BY TMH

PLOT DATE = 8/9/2007  
 FILE NAME = g:\proj\sect\285\089\_002\add\B9M1381.ras  
 PLOT SCALE = 20.00 / IN.  
 USER NAME = zbrand

