

STATE OF ILLINOIS
DEPARTMENT OF TRANSPORTATION

PROJECT NO.	SECTION	COUNTY	SHEET NO.	SHEET NO.
FAI 80	06-8HBR	BUREAU	165	80
FED. ROAD DIST. NO. 7		SHEET NO.		22 SHEETS
Contract # 66641				

WEST GUTTER LINE

Location	Station	Offset	Theoretical Grade Elevations
Bk N' Abut	241+91.62	-31.00	677.33
A	242+01.62	-31.00	677.26
B	242+11.62	-31.00	677.19
End N Appr Pav't	242+21.62	-31.00	677.11

PG SOUTHBOUND

Location	Station	Offset	Theoretical Grade Elevations
Bk N' Abut	241+86.28	-9.00	677.75
A	241+96.28	-9.00	677.69
B	242+06.28	-9.00	677.61
End N Appr Pav't	242+16.28	-9.00	677.54

PG NORTHBOUND

Location	Station	Offset	Theoretical Grade Elevations
Bk N' Abut	241+81.90	-9.00	677.78
A	241+91.90	9.00	677.72
B	242+01.90	9.00	677.65
End N Appr Pav't	242+11.90	9.00	677.57

EAST GUTTER LINE

Location	Station	Offset	Theoretical Grade Elevations
Bk N' Abut	241+76.55	31.00	677.43
A	241+86.55	31.00	677.37
B	241+96.55	31.00	677.30
End N Appr Pav't	242+06.55	31.00	677.23

WEST SHOULDER LINE

Location	Station	Offset	Theoretical Grade Elevations
Bk N' Abut	241+89.68	-23.00	677.51
A	241+99.68	23.00	677.44
B	242+09.68	23.00	677.37
End N Appr Pav't	242+19.68	-23.00	677.29

IL ROUTE 89 AND STAGE CONSTRUCTION LINE

Location	Station	Offset	Theoretical Grade Elevations
Bk N' Abut	241+84.09	0.00	677.91
A	241+94.09	0.00	677.84
B	242+04.09	0.00	677.77
End N Appr Pav't	242+14.09	0.00	677.69

EAST SHOULDER LINE

Location	Station	Offset	Theoretical Grade Elevations
Bk N' Abut	241+78.49	23.00	677.58
A	241+88.49	23.00	677.52
B	241+98.49	23.00	677.45
End N Appr Pav't	242+08.49	23.00	677.38

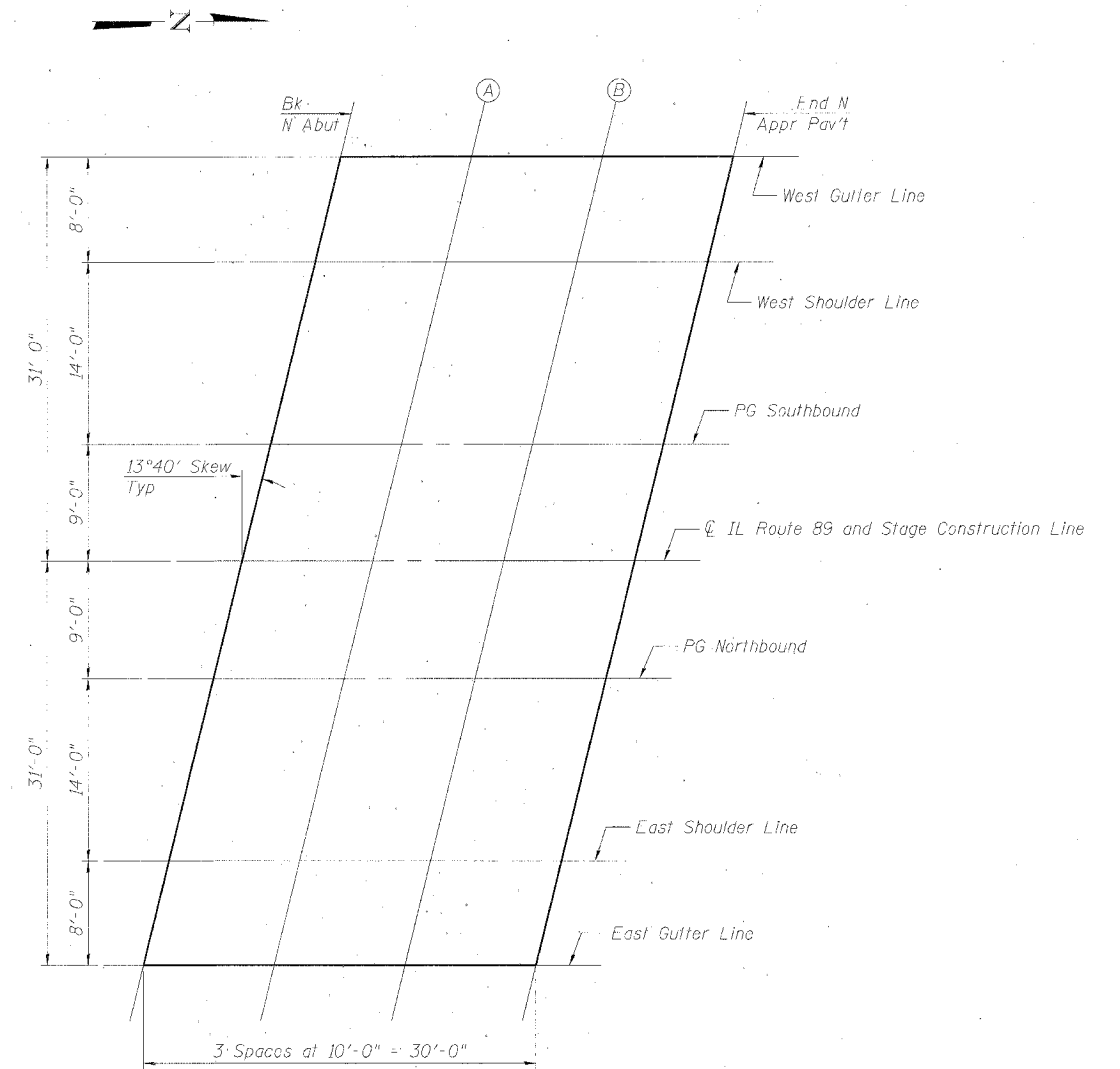

DESIGNED	BPS
CHECKED	BHS
DRAWN	RRG
CHECKED	GSP

TOP OF NORTH APPROACH
SLAB ELEVATIONS
IL ROUTE 89 OVER
FAI ROUTE 80 (I-80)
SECTION 06-8HBR
BUREAU COUNTY
STATION 3702+69.82
STRUCTURE NO. 006-0178

PLOT DATE = 7/30/2007
FILE NAME = g:\projects\2004\802\addatl\8HBR.DWG
PLOT SCALE = 1/4"=1'-0"
USER NAME = zhangrb

