

STATE OF ILLINOIS
DEPARTMENT OF TRANSPORTATION
212'-0"

ROUTE NO.	SECTION	COUNTY	POST MILES	SHEET	SHEET NO. 13 22 SHEETS
FAI 80	06-8HBR	BUREAU	165	84	
FED. ROAD DIST. NO. 7		BUILDING	FED. AID PROJECT		Contract # 66641

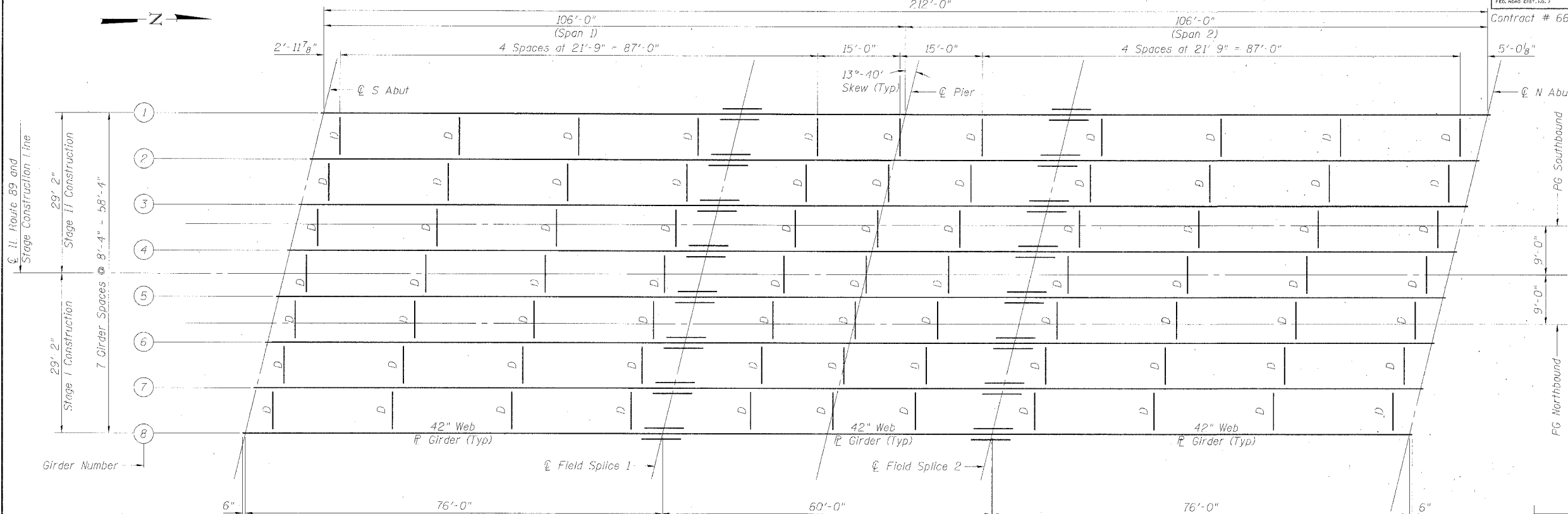

FRAMING PLAN

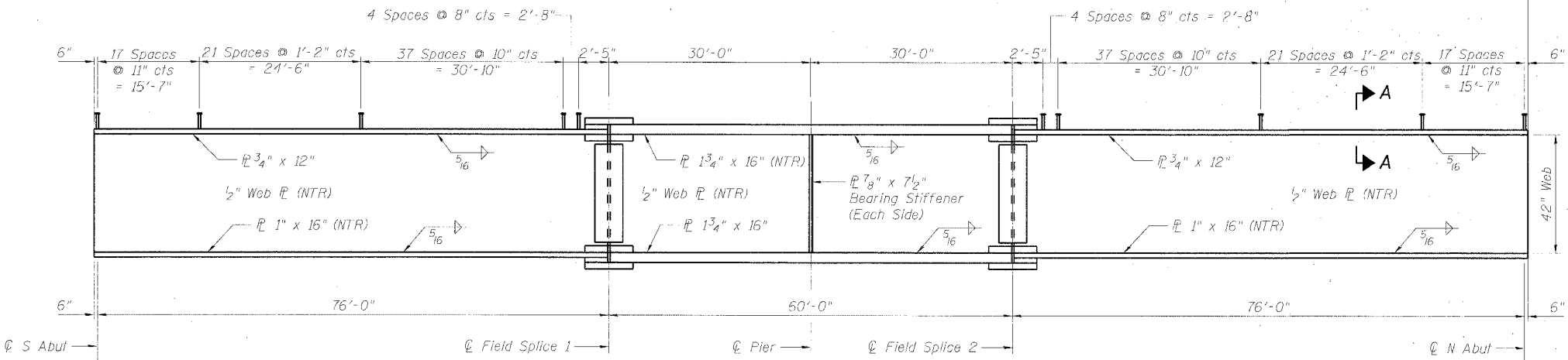

GIRDER ELEVATION

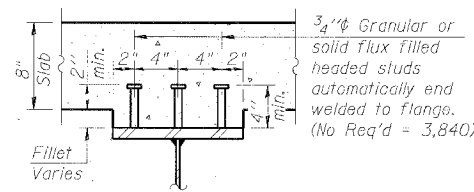

SECTION A-A

NOTES:
All structural steel shall be AASHTO M 270 Grade 50, unless otherwise noted.
See Sheet No. 14 for Field Splice details, Diaphragm details and Table of Moments and Shears.
All diaphragms shall be installed as steel is erected and secured with erection pins and bolts except as otherwise noted. Individual diaphragms at supports may be temporarily disconnected to install bearing anchor rods.
Load carrying components designated "NTR" shall conform to the Supplemental Requirements for Notch Toughness, Zone 2.

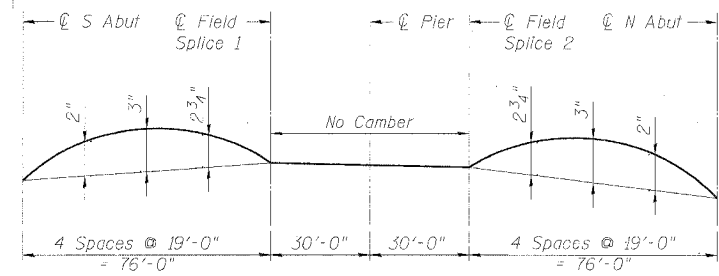

CAMBER DIAGRAM
(Upward Camber is Positive)

TOP OF WEB ELEVATION TABLE
(For Fabrication Use Only)

Girder	℄ S Abut	℄ Field Splice 1	℄ Pier	℄ Field Splice 2	℄ N Abut
1	676.62	676.86	676.86	676.85	676.57
2	676.77	677.02	677.02	677.02	676.75
3	676.88	677.15	677.15	677.15	676.89
4	677.00	677.28	677.28	677.29	677.03
5	676.99	677.27	677.28	677.29	677.05
6	676.84	677.14	677.15	677.16	676.93
7	676.70	677.00	677.02	677.03	676.81
8	676.52	676.84	676.85	676.87	676.66

DESIGNED	BPS
CHECKED	BHS
DRAWN	RRG
CHECKED	GSP

FRAMING PLAN
IL ROUTE 89 OVER
FAI ROUTE 80 (I-80)
SECTION 06-8HBR
BUREAU COUNTY
STATION 3702+69.82
STRUCTURE NO. 006-0178

PLOT DATE = 7/28/2007
FILE NAME = N:\Projects\2006-08-01-002\roads\IL 89BR FRAMING.dwg
PLOT SCALE = N/A
USER NAME = zhangarb

