

STATE OF ILLINOIS  
DEPARTMENT OF TRANSPORTATION

ROUTE NO.	SECTION	COUNTY	SHEET NO.	TOTAL SHEETS
FAI 80	06-8HBR	BUREAU	165	106
FED. ROAD DIST. NO. 7	ILLINOIS	FOR AID PROJECT		

Contract # 66641

STATE OF ILLINOIS  
DEPARTMENT OF TRANSPORTATION

DATE	BY	CHKD.	APP'D.	SHEET NO.	TOTAL SHEETS
				4	10

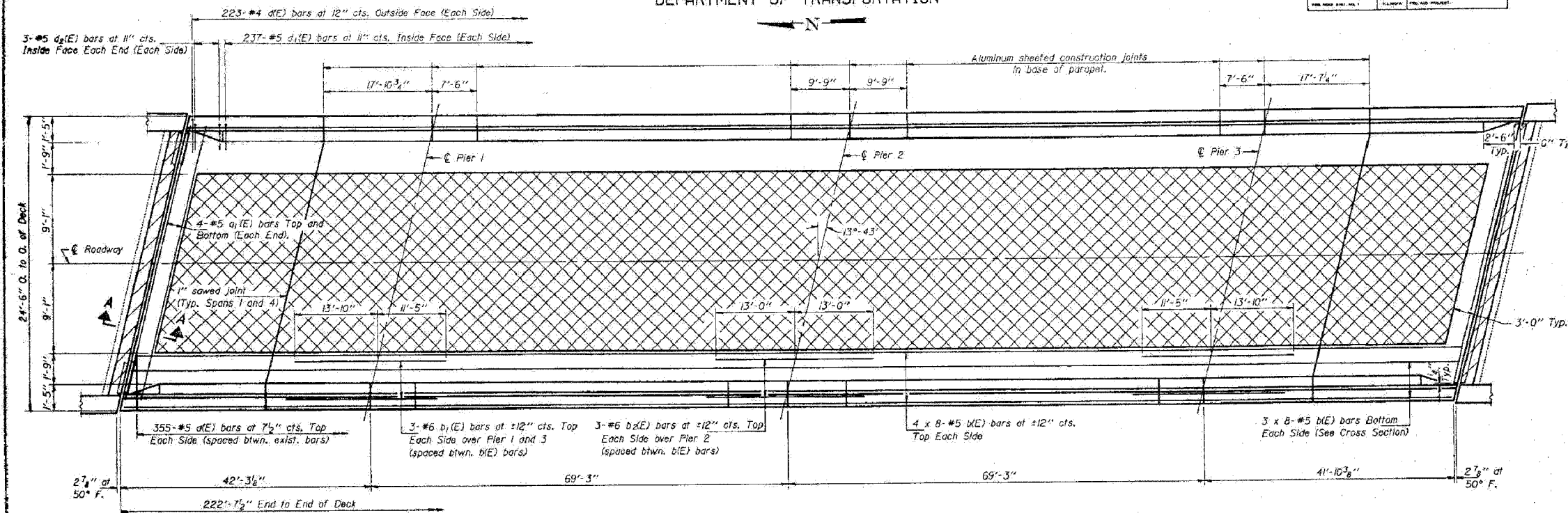

PLAN

Notes: Cut b(E) & b<sub>1</sub>(E) bars as required to miss floor drains in Spans 1 and 4.  
Reinforcement bars designated (E) shall be epoxy coated.  
Bars indicated thus 4 x 8-#5 etc. indicates 4 lines of bars with 8 lengths per line.  
See sheet #5 & 6 for superstructure details and Bill of Material.  
Cross hatched areas indicate limits of "Plasticized Bridge Deck Concrete Overlay".  
Minimum bar laps for #5 bars is 2'-2".

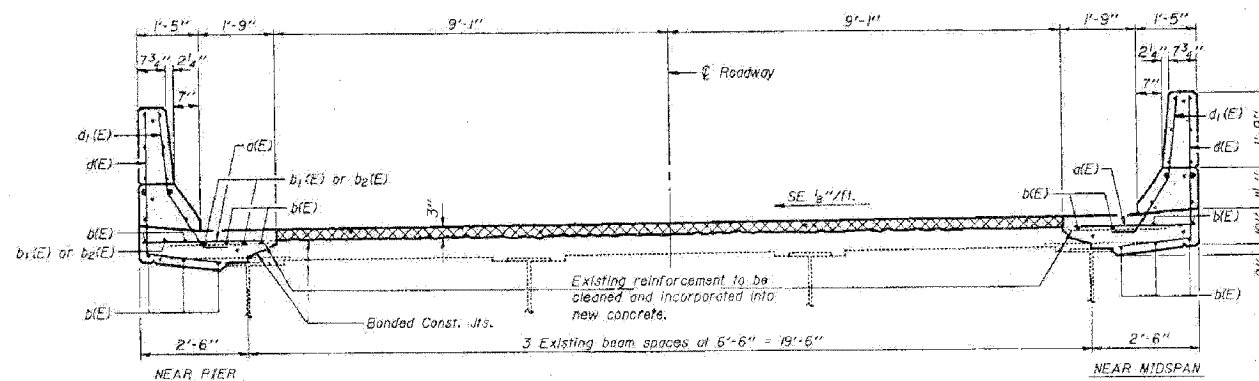

CROSS SECTION  
(North Bound Looking South)  
(South Bound Looking North)

DESIGNED: Mary Bloxdorf  
CHECKED: [Signature]  
DRAWN: Joe Sutherland  
CHECKED: [Signature]

EXAMINED: [Signature]  
PASSED: [Signature]  
APPROVED: [Signature]

SUPERSTRUCTURE  
F.A.I. RT. 80 SEC. (06-8HBM)  
BUREAU COUNTY  
STATION 312+11.90

EXISTING PLANS - 1985  
IL ROUTE 89 OVER  
FAI ROUTE 80 (I-80)  
SECTION 06-8HBR  
BUREAU COUNTY  
STATION 3702+69.82  
STRUCTURE NO. 006-0178

FOR INFORMATION ONLY

PLOT DATE = 8/1/2007  
FILE NAME = C:\PROJECT\2884889\_002\CADD\IL89.mxd  
PLOT SCALE = N/A  
USER NAME = zhangp

