

F.A.P. RTE.	SECTION	COUNTY	TOTAL SHEETS	SHEET NO.
317	(18B)	FULTON	50	4
STA. 252+75		TO STA. 262+40		
FED. ROAD DIST. NO. . ILLINOIS		FED. AID PROJECT		

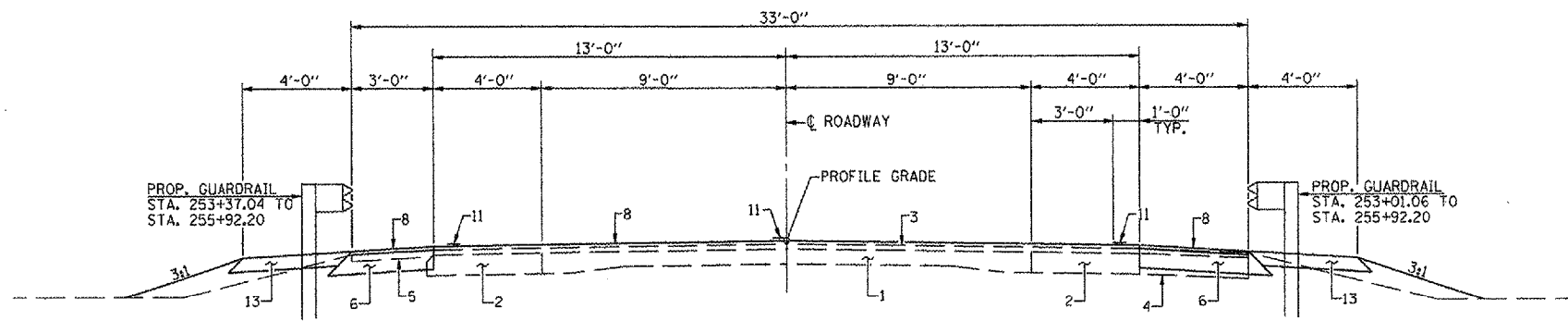

TYPICAL ROADWAY SECTION #1
(STA. 252+75 TO STA. 255+92.20)

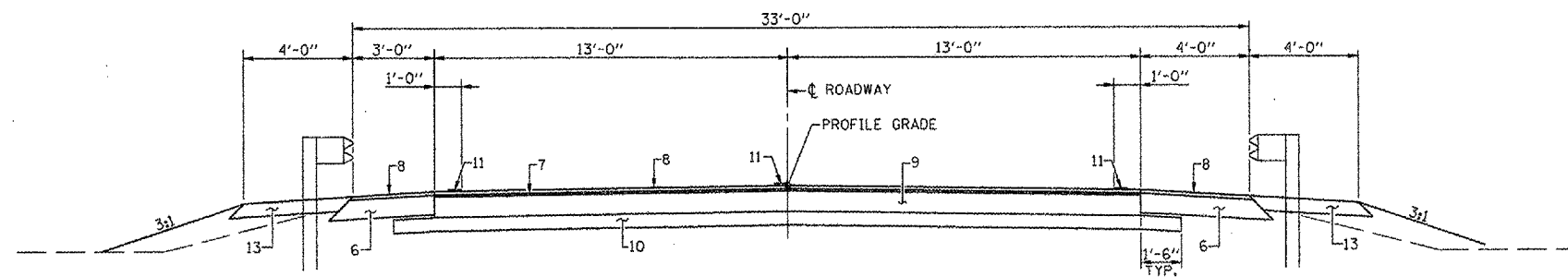

TYPICAL ROADWAY SECTION #2
(STA. 255+92.20 TO STA. 255+94.20)

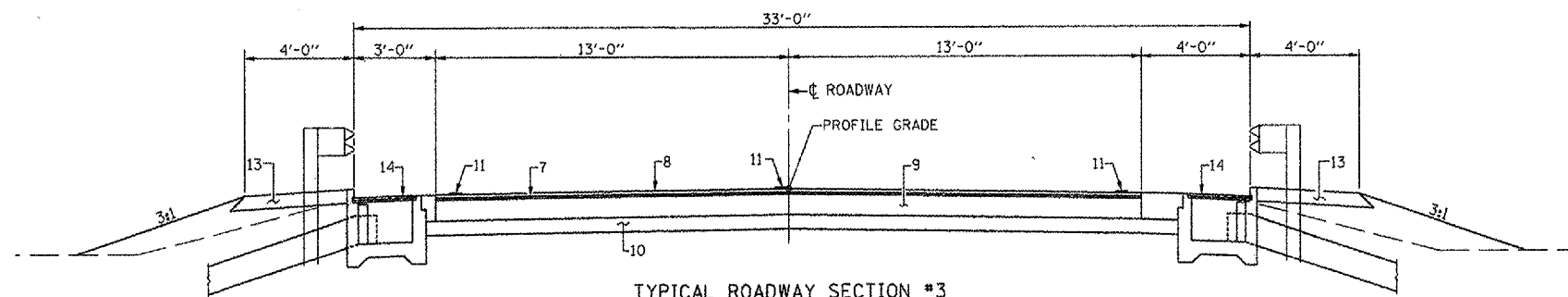

TYPICAL ROADWAY SECTION #3
(STA. 259+14.45 TO STA. 259+32.45)

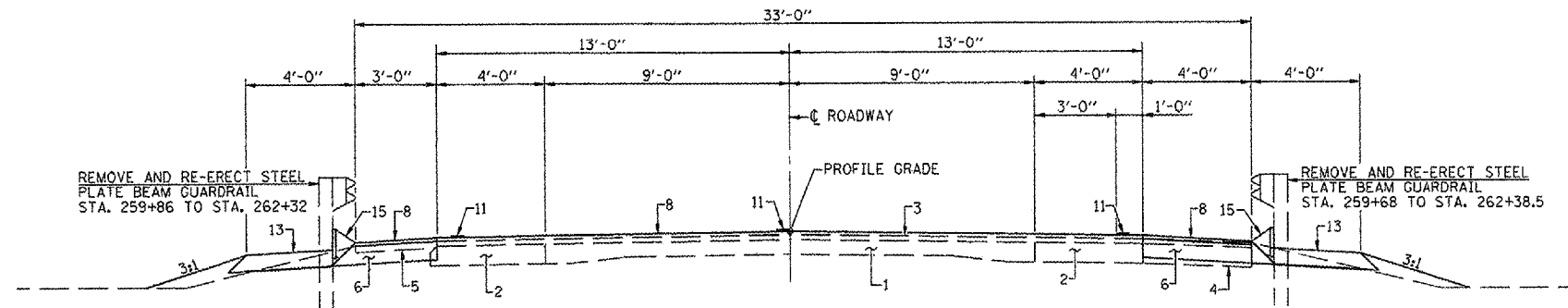

TYPICAL ROADWAY SECTION #4
(STA. 259+32.45 TO STA. 262+40)

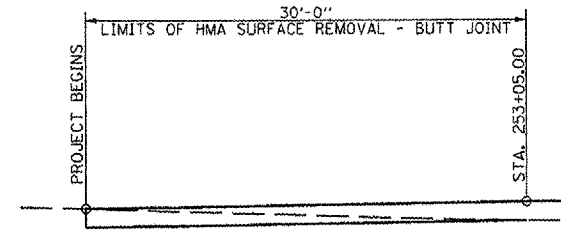

BUTT JOINT DETAIL
(STA. 252+75 TO STA. 253+05)

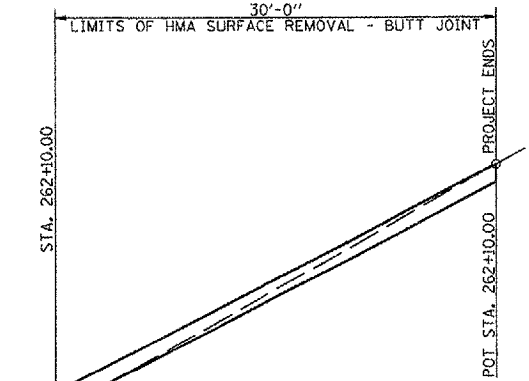

BUTT JOINT DETAIL
(STA. 262+10 TO STA. 262+40)

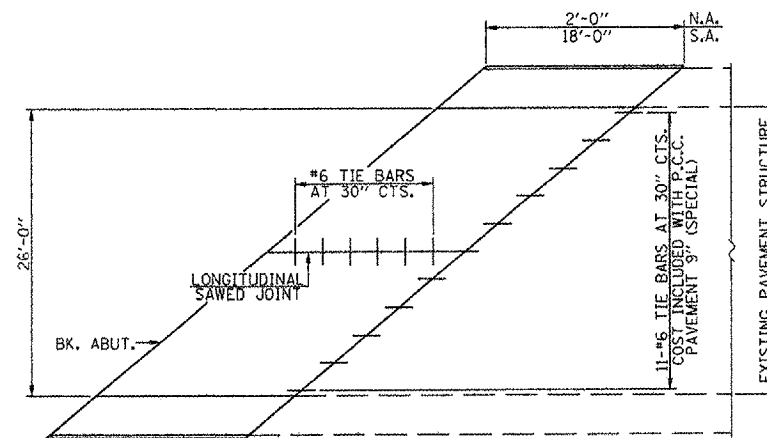

P.C.C. BASE COURSE 9''(SPECIAL) PLAN

PAVEMENT LEGEND

- EXISTING P.C.C. PAVEMENT
- EXISTING P.C.C. BASE COURSE WIDENING 9"
- EXISTING HOT MIX ASPHALT OVERLAY
- EXISTING HOT MIX ASPHALT SHOULDER 6"
- EXISTING AGGREGATE SHOULDER
- PROPOSED HOT MIX ASPHALT BASE COURSE 10"
- PROPOSED LEVELING BINDER (MACHINE METHOD), N50
- PROPOSED HOT MIX ASPHALT SURFACE COURSE, MIX "D", N50 (1 1/2")
- PROPOSED P.C.C. BASE COURSE 9" (SPECIAL)
- PROPOSED SUB-BASE GRANULAR MATERIAL TYPE A 4"
- PROPOSED PAINT PAVEMENT MARKING - LINE 4" (STRIPE FOR 12'-0" LANE)
- PROPOSED TEMPORARY PAVEMENT MARKING LINE - 4"
- PROPOSED AGGREGATE EROSION CONTROL
- PROPOSED TYPE B INLET BOX
- PROPOSED EROSION CONTROL CURB

DETAILS AND
TYPICAL ROADWAY SECTIONS
US ROUTE 24 OVER OTTER CREEK
F.A.P. RTE. 317 - SECTION (18B)
FULTON COUNTY
STA. 257+54.33
S.N. 029-2005

PLOT DATE = 04/27/05
FILE NAME = 04FILES
MODEL NAME = 04MODELNAME