

F.A.P. RTE.	SECTION	COUNTY	TOTAL SHEETS	SHEET NO.
317	(18B)	FULTON	50	6
STA. 252+75		TO STA. 262+40		
FED. ROAD DIST. NO. ILLINOIS FED. AID PROJECT				

SECTION 30, T. 4 N., R. 3 E., 4th P.M.

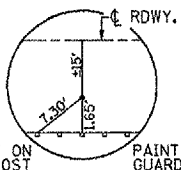

TIE #1
 STA. 255+94.20
 PK N. & W. IN SHLDR.

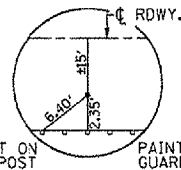

TIE #2
 STA. 259+24.14
 #5 REBAR

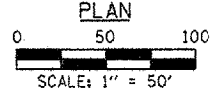
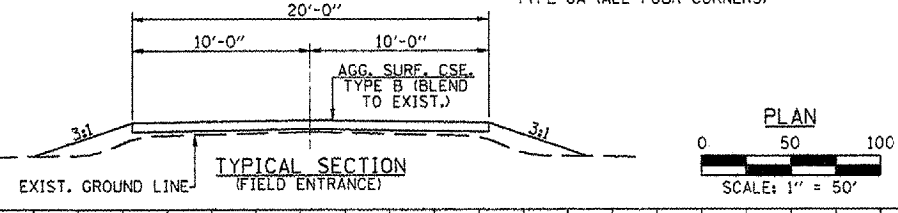
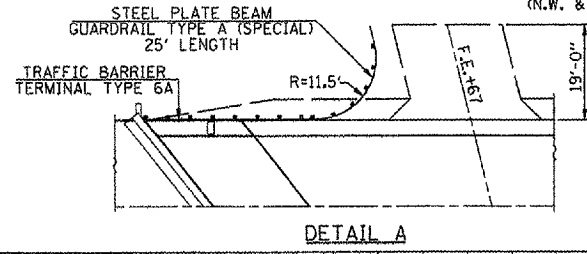
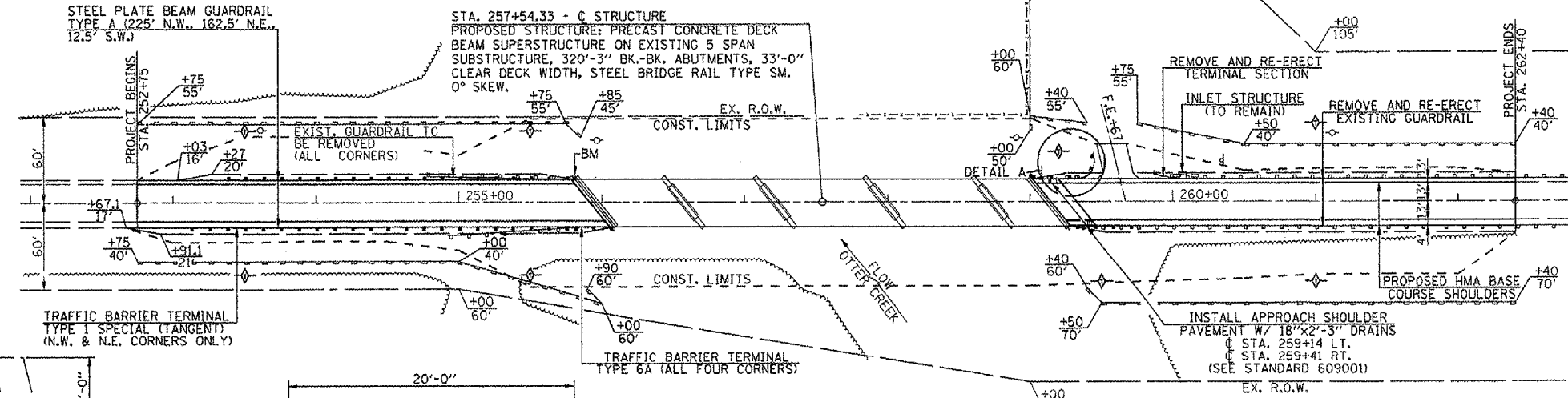

--- DENOTES PERIMETER EROSION BARRIER
 ◆ DENOTES TEMPORARY DITCH CHECK
 BM: CHISELED "□" ON NORTHEAST WINGWALL OF STRUCTURE EL. 477.56

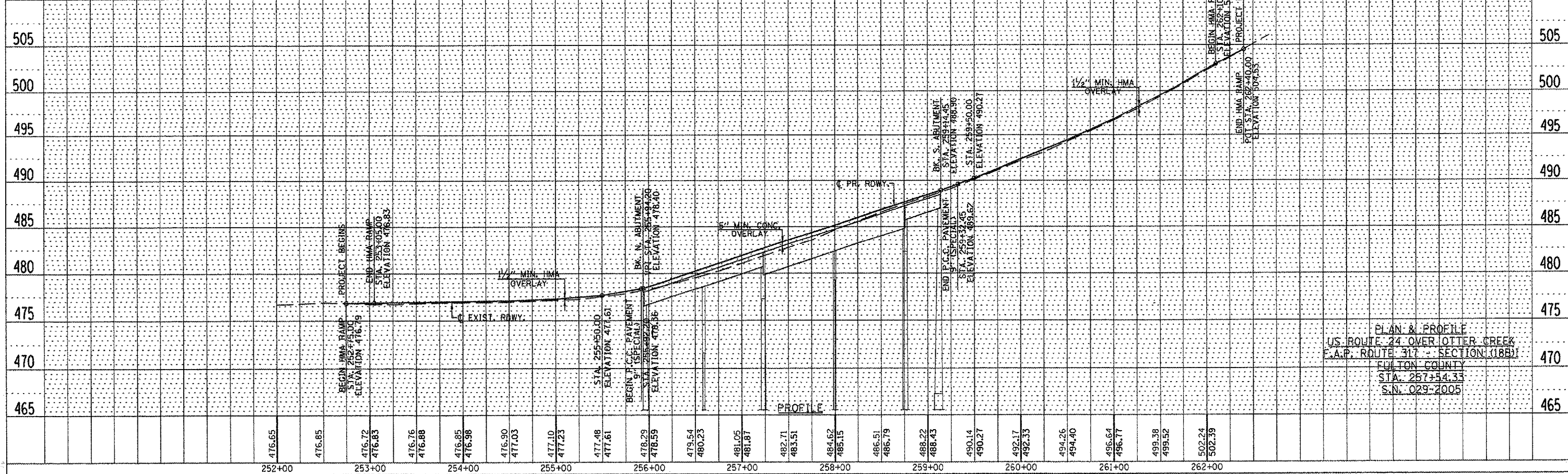

PLAN & PROFILE
 US ROUTE 24 OVER OTTER CREEK
 F.A.P. ROUTE 317 - SECTION (18B)
 FULTON COUNTY
 STA. 257+54.33
 S.N. 029-2005

PLAN	DATE	BY
SURVEYED		
PLOTTED		
CHECKED		
DATE		

PROFILE	DATE	BY
SURVEYED		
PLOTTED		
CHECKED		
DATE		

PLOT DATE = MONTHS
 LABEL NAME = BRIDGE/NAME