

Bench Mark: Chiseled "X" on top of northeast wingwall - Elev. 606.87

Existing Structure: Constructed in 1924 as SBI Route 3, Section 40-B, originally consisted of single span reinforced concrete tee beams supported on closed abutments with wingwalls. The structure was widened in 1971 with two 36" concrete deck beams on each side. Wide flange beams were added between the concrete tee beams in 1997. One lane of traffic is to be maintained at all times utilizing Stage Construction.

ROUTE NO.	SECTION	COUNTY	TOTAL SHEETS	SHEET NO.
F.A.P. 310 U.S. 67	(40BY) BR	McDonough	8	3 SHEETS
FED. ROAD DIST. NO. 7	ILLINOIS	FED. AID PROJECT		

Contract 6817

**GENERAL NOTES**

Plan dimensions and details relative to existing structure have been taken from existing plans and are subject to nominal construction variations. It shall be the Contractor's responsibility to verify such dimensions and details in the field and make necessary approved adjustments prior to construction or ordering of materials. Such variations shall not be cause for additional compensation for a change in the scope of the work, however, the Contractor will be paid for the quantity actually furnished at the unit price bid for the work.

**INDEX OF SHEETS**

1. General Plan
2. Deck Cross Section
3. Concrete Girder Repair

**SCOPE OF WORK**

1. Repair existing exterior concrete tee beams.
2. Remove existing bituminous surface.
3. Remove existing waterproofing system over deck beams.
4. Repair Keyways
5. Apply P.C. Mortar Fairing Course
6. Provide Waterproofing Membrane System and Bituminous Surface

**TOTAL BILL OF MATERIAL**

ITEM	UNIT	TOTAL
Structural Repair of Concrete (Depth Equal to or less than 5 in.)	Sq. Ft.	139
Hot-Mix Asphalt Surface Removal	Sq. Yd.	245
Epoxy Crack Sealing	Foot	10
Hot-mix Asphalt Surface Course, Mix "D", N50	Tons	28.6
Portland Cement Mortar Fairing Course	Foot	252
Waterproofing Membrane System	Sq. Yd.	247
Keyway Repair	Foot	25

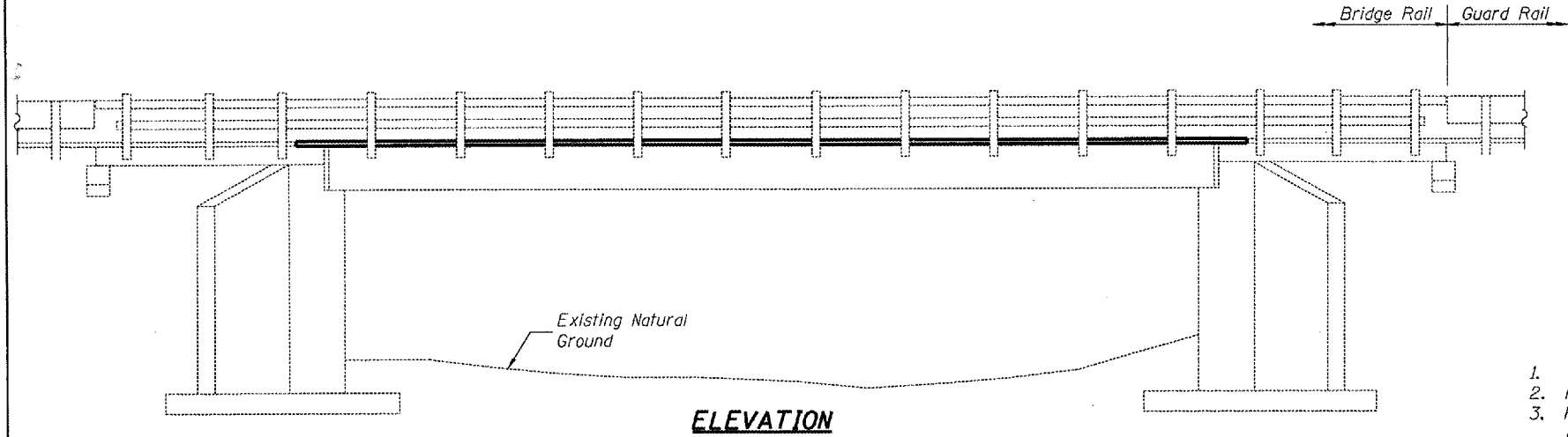

**ELEVATION**

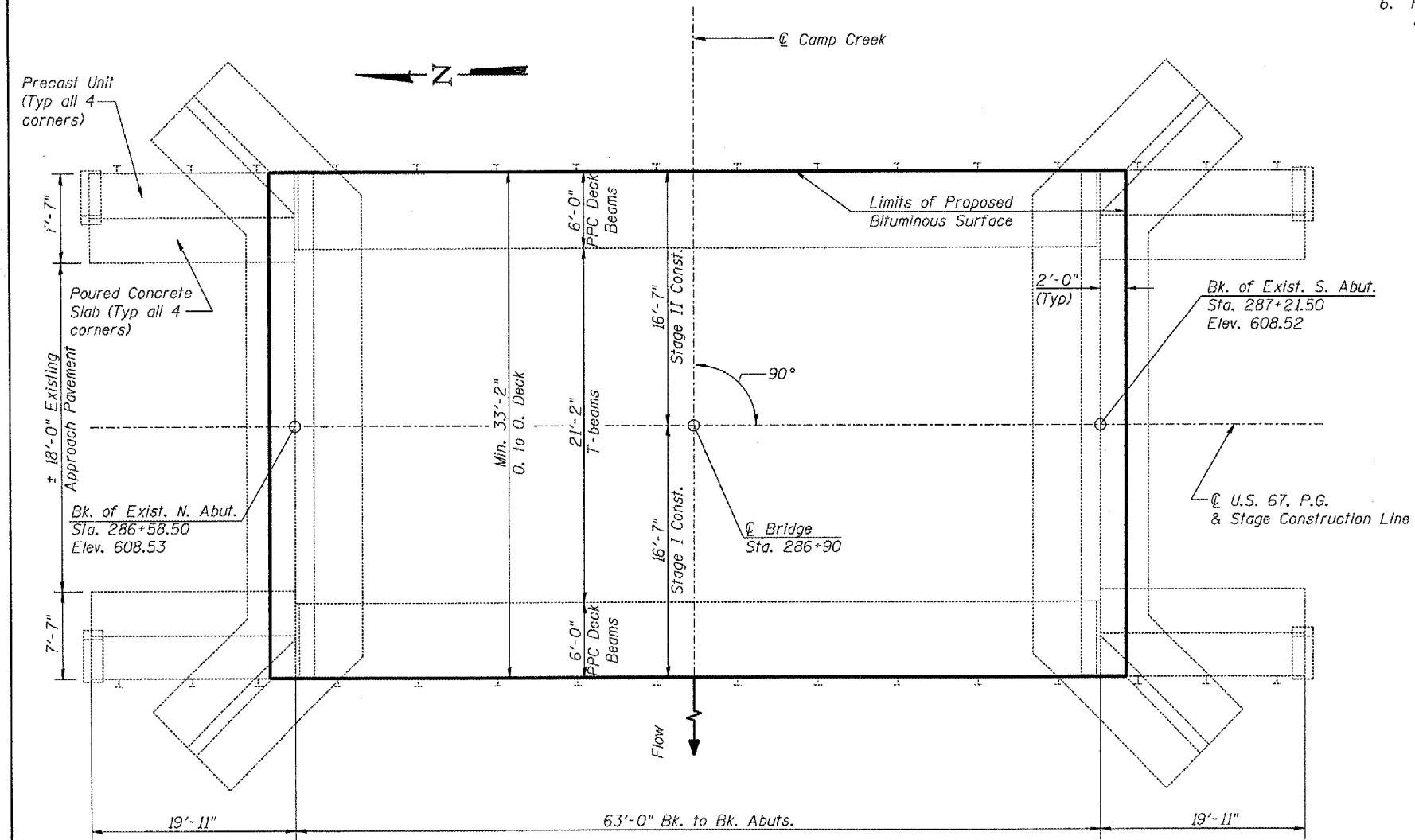

**PLAN**

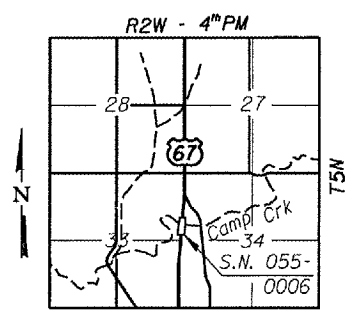
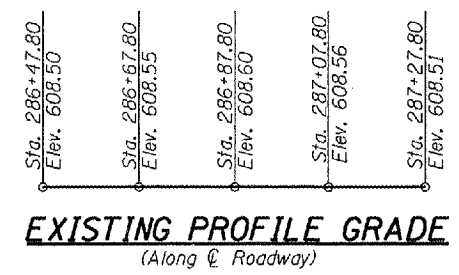

**LOCATION SKETCH**

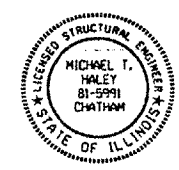

Michael J. Key 6-23-06  
 Michael T. Haley  
 Licensed Structural Engineer  
 State of Illinois No. 81-5991

**LIN ENGINEERING, LTD.**  
 201 W. Chestnut  
 Chatham, Illinois 62629  
 618-483-8888 FAX: 618-483-4708  
 Designed By: STD Checked By: ARB Drawn By: JMD

REVISIONS	
NAME	DATE

ILLINOIS DEPARTMENT OF TRANSPORTATION  
**GENERAL PLAN**  
**F.A.P. 310 (U.S. 67) OVER CAMP CREEK**  
**SECTION (40BY)BR**  
**McDONOUGH COUNTY**  
**STA. 286+90**  
**S.N. 055-0006**