

CONTRACT NO. 70232			
F.A.P. RTE.	SECTION	COUNTY	TOTAL SHEET NO.
721	(113BR)BR	DEWITT	81 55
STA. 242+00.00		TO STA. 242+00.00	
FED. ROAD DIST. NO.	ILLINOIS	FED. AID PROJECT	

FINAL SURVEY	SHOWED	DATE
NOTE BOOK	PLOTTED	
NO.	TEMPLATE	
	AREAS CHECKED	

ORIGINAL SURVEY	COMPLETED	DATE
NO.	PLOTTED	
	TEMPLATE	
	AREAS CHECKED	

PLOT DATE: 10/12/2007
 FILE NAME: s:\projects\45633002 (S)\11-10-10\10-15-07\10-15-07.dwg
 USER: NAME: [unclear]

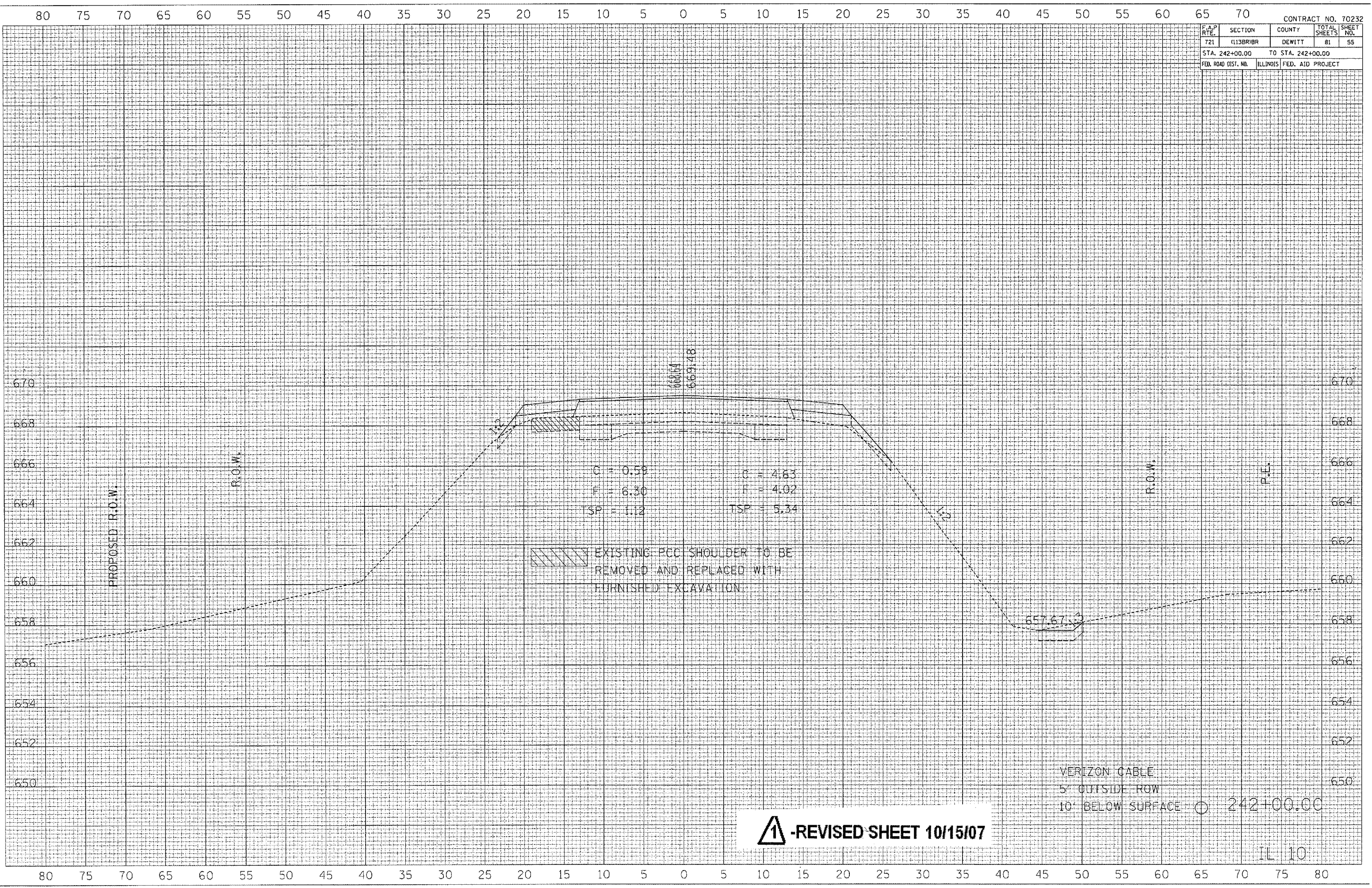

1 -REVISED SHEET 10/15/07

IL 10