

ROUTE NO.	SECTION	COUNTY	TOTAL SHEETS	SHEET NO.
FAP 693	120B	MCLEAN	31	9
STA 1212+00	TO STA 1218+00			
FED. ROAD DIST. NO.		ILLINOIS FED. AID PROJECT		

SEC. 21, T24N, R1W, 3RD P.M.

STEVEN W. & ALICE J. MUSSELMAN

PLAN	SURVEYED	BY	DATE
	PLOTTED		
	CHECKED		
	BY		
	NO. OF WAY CHECKED		
	CADD FILE NAME		

MATCH LINE - STA. 1212+00

END PROJECT
STA. 1212+50.00

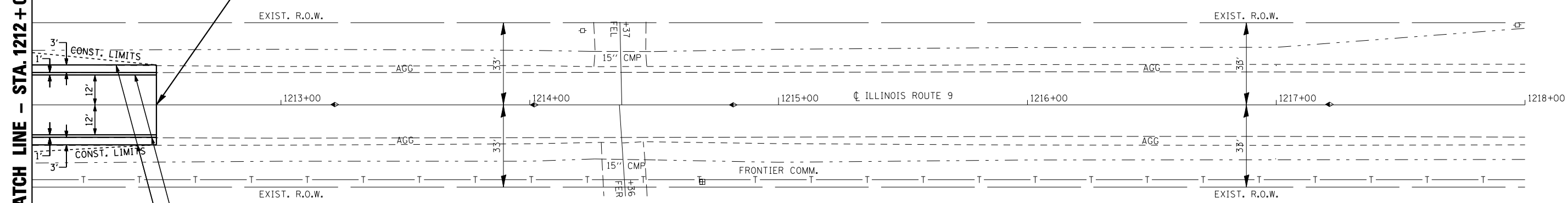

STEVEN W. & ALICE J. MUSSELMAN

PROFILE	SURVEYED	BY	DATE
	PLOTTED		
	CHECKED		
	BY		
	NO. OF WAY CHECKED		
	STRUCTURE NOTATIONS CHKD		

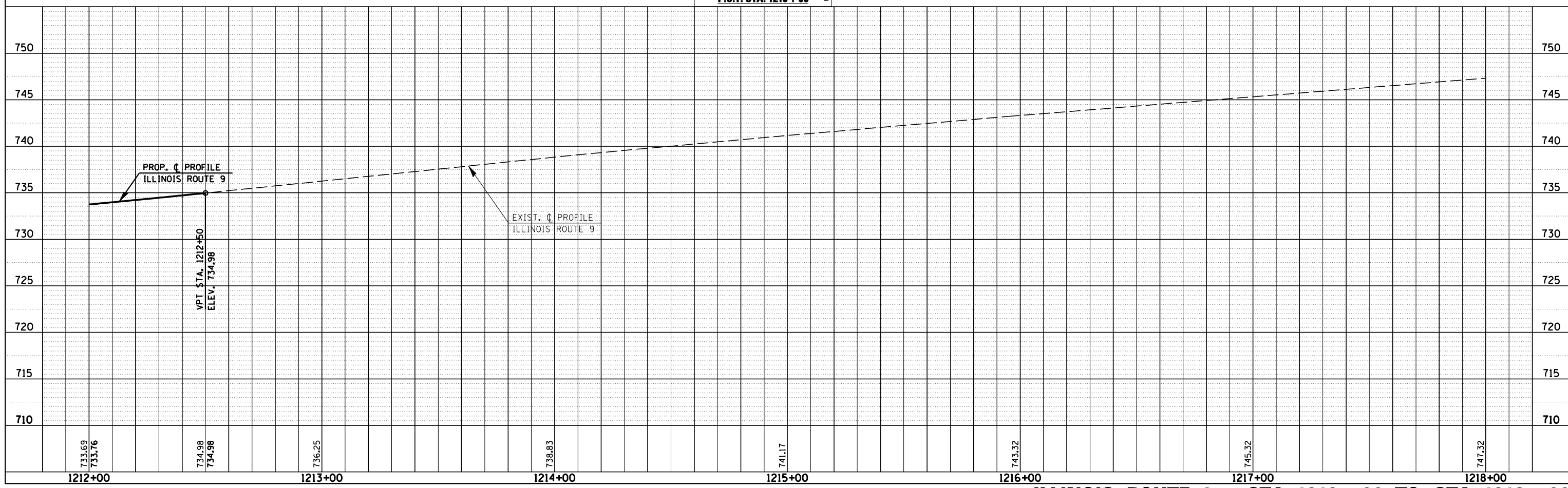

ILLINOIS ROUTE 9 - STA. 1212+00 TO STA. 1218+00