

F.A.P. RTE.	SECTION	COUNTY	TOTAL SHEETS	SHEET NO.
304	3B-1	PIKE	51	12
STA. 782+00		TO STA. 788+00		
FED. ROAD DIST. NO.	ILLINOIS	FED. AID PROJECT		

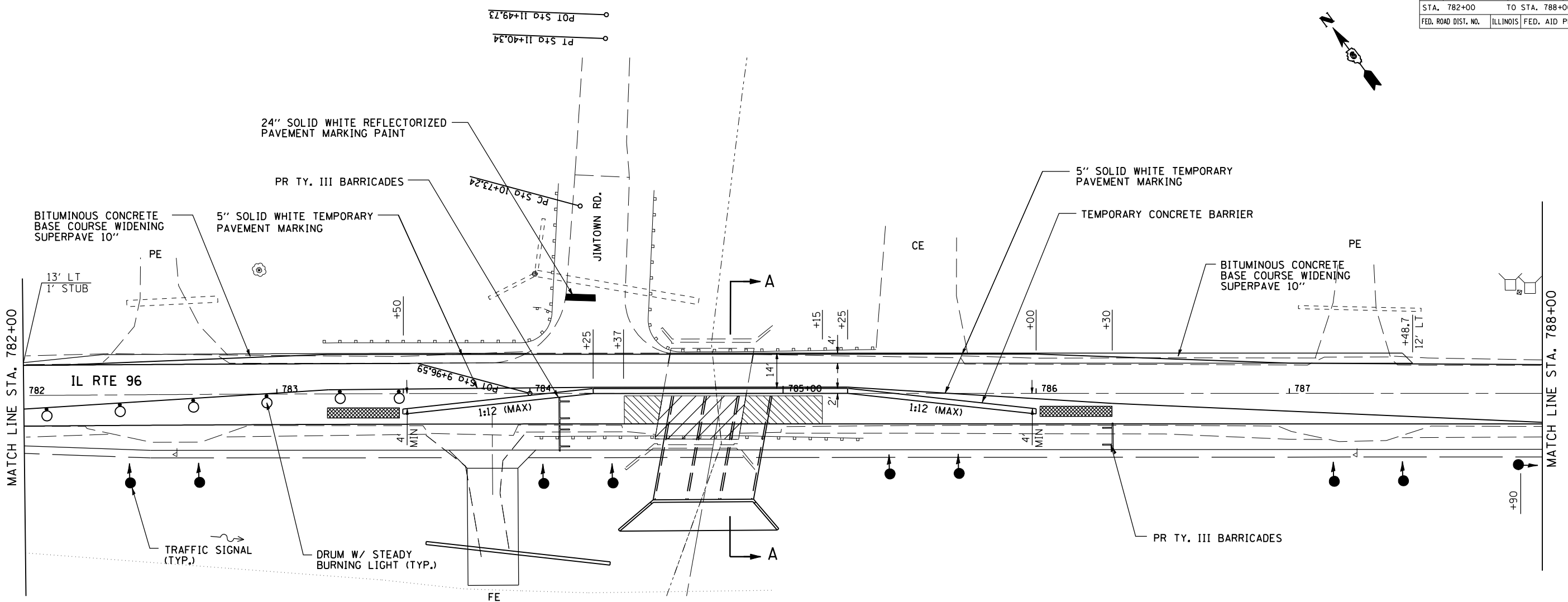
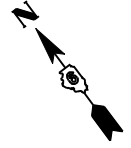

STAGE 1 CONSTRUCTION SEQUENCE

1. CONSTRUCT HMA BASE COURSE WIDENING, 10" (LT, SHOULDER, 4 FT. WIDE & VAR.) AS SHOWN IN SECTION A-A, STA. 782+00 TO STA. 787+48.7 (GO THRU SIDEROAD AND OMIT OVER EXISTING BRIDGE) USING STANDARD 701326.
2. THE BUREAU OF OPERATIONS TRAFFIC ENGINEER SHALL BE NOTIFIED 21 CALENDAR DAYS IN ADVANCE OF INSTALLING STANDARD 701321 IN ORDER TO MANUFACTURE AND ERECT MAXIMUM WIDTH SIGNING.
3. INSTALL STANDARD 701321 USING STANDARD 701201 AND 701301.
4. REMOVE STAGE 1 PORTION OF EXISTING BRIDGE AND CONSTRUCT SOUTH PORTION OF BOX CULVERT.
5. CONSTRUCT HMA BASE COURSE, 10" (RT, ROADWAY AND SHOULDER) STA 784+37 TO STA 785+15
6. CONSTRUCT HMA BASE COURSE/WIDENING, 10", (RT, SHOULDER 10 FT. WIDE AND VARIES), STA. 780+50 TO STA 789+36.5
7. RELOCATE STANDARD 701321 TO STAGE II USING STANDARD 701201 AND 701301.
8. SWITCH TRAFFIC TO STAGE 2.

NOTES

1. A WING BARRICADE, STANDARD 7020001 SHALL BE USED TO SUPPORT THE "SIGNAL AHEAD" SIGNS. TWO HIGH INTENSITY FLASHING LIGHTS PER BARRICADE SHALL BE INSTALLED INSTEAD OF TYPE A FLASHING LIGHTS.
2. THE CONTRACTOR SHALL PROVIDE AND ERECT A W12-I102, 48x48(O) LANE WIDTH SIGNS. THESE SHALL BE PLACED AS DIRECTED BY ENGINEER.

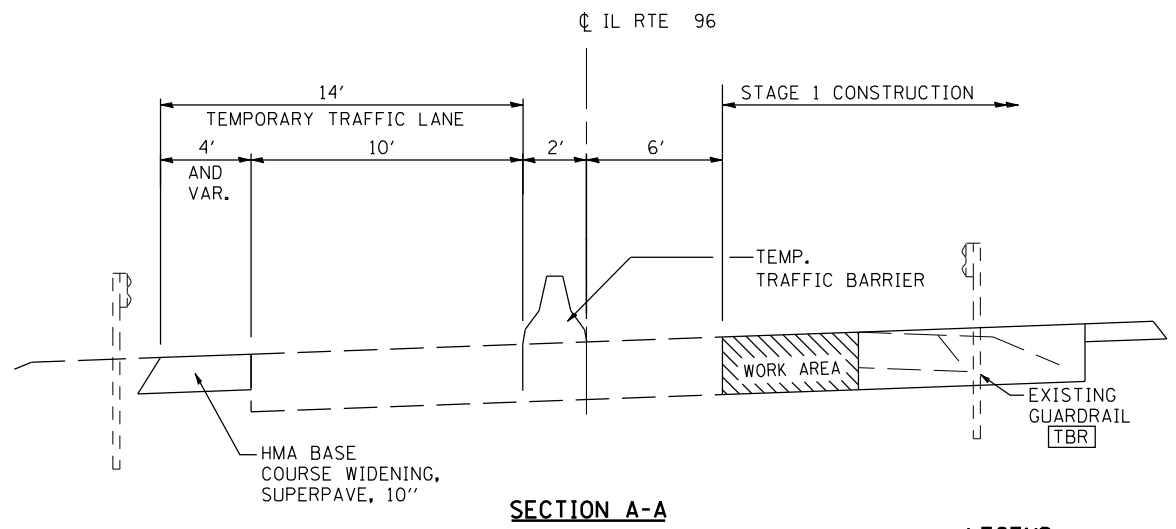

SECTION A-A

LEGEND

- PAVEMENT REMOVAL
- BRIDGE DECK REMOVAL
- IMPACT ATTENUATOR, NON-REDIRECTIVE (TEMPORARY) TEST LEVEL 3



REVISIONS	
NAME	DATE

ILLINOIS DEPARTMENT OF TRANSPORTATION

STAGE 1 CONSTRUCTION PLAN
IL 96 OVER JIMTOWN BRANCH
FAP 304 SECTION 3B-1
PIKE COUNTY

SCALE: 1"=20'
 DATE: \$DATE

DRAWN BY: GEW
 CHECKED BY: MJS

The Upchurch Group
 HILLSIDE, IL. (708) 449-2321
 MATTOON, IL. (217) 235-3177

PLOT DATE = Aug-31-2007 11:48:21AM
 FILE NAME = c:\projects\653704\upchurch\final\constrstage1.02.dwg
 PLOT SCALE = 42.3525 / IN.
 USER NAME = laughlin-1