

F.A.P. RTE.	SECTION	COUNTY	TOTAL SHEETS	SHEET NO.
753	142BR-4	SANGAMON	24	6
FED. ROAD DIST. NO.		ILLINOIS FED. AID PROJECT		

PLAN	DATE
SURVEYED	
ALIGNED	
GRADES CHECKED	
RT. OF WAY CHECKED	
PAID FILE NAME	
NOTE BOOK NO.	
BY	

PROFILE	DATE
SURVEYED	
GRADES CHECKED	
B.M. NOTED	
STRUCTURE NOTATIONS CIPRD	
NOTE BOOK NO.	
BY	

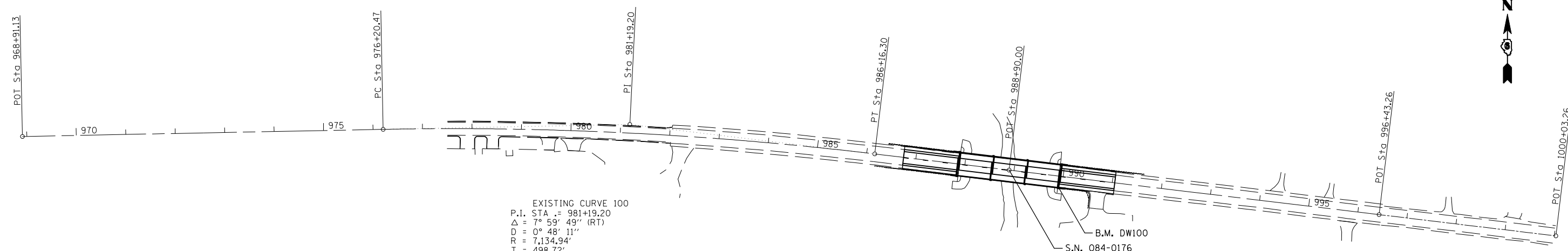

EXISTING CURVE 100
 P.I. STA = 981+19.20
 $\Delta = 7^\circ 59' 49''$ (RT)
 $D = 0^\circ 48' 11''$
 $R = 7,134.94'$
 $T = 498.72'$
 $L = 995.83'$
 $E = 17.41'$
 $e = 0$
 $T.R. = 0$
 $S.E. RUN = 0$
 $P.C. STA = 976+20.47$
 $P.T. STA = 986+16.30$

B.M. DW100 - CHISELED "□" ON TOP OF PARAPET WALL ON S.E. CORNER OF STRUCTURE #084-0176 STA. 990+04, 24' RT. ELEV. 588.61

BENCHMARK

ALIGNMENT LAYOUT

TIE INFORMATION

<p>P.O.T. STA. 968 + 91.13 SET PK NAIL</p>	<p>P.C. STA. 976 + 20.47 SET PK NAIL</p>	<p>P.I. STA. 981 + 19.20 REBAR WITH CAP (FLUSH)</p>	<p>P.T. STA. 986 + 16.30 SET PK NAIL</p>	<p>P.O.T. STA. 996 + 43.26 SET PK NAIL</p>
---	---	--	---	---

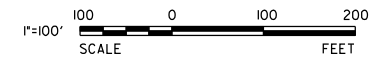

K+ K-Plus Engineering, Ltd.
 753 WINDSOR ROAD
 CHARLESTON, IL 61920
 (217) 348-1900
 WWW.K-PLUSENGINEERING.LTD.COM
 ILLINOIS DEPARTMENT OF PROFESSIONAL REGULATION REGISTRATION #184-003685
 ** THIS DOCUMENT IS THE PROPERTY OF K-PLUS ENGINEERING, LTD. AND NO PART HEREIN SHALL BE USED **
 EXCEPT FOR THIS SPECIFIC PROJECT WITHOUT THE WRITTEN CONSENT OF K-PLUS ENGINEERING, LTD.

REVISIONS		ILLINOIS DEPARTMENT OF TRANSPORTATION ALIGNMENT, TIES & BENCHMARKS
NAME	DATE	
		FAP 753 (IL RTE. 104) OVER HORSE CREEK SECTION 142BR-4 SANGAMON COUNTY
DATE: 08-01-07		DRAWN BY: ADG CHECKED BY: DC

PLOT DATE = Aug-18-2007 07:49:00AM
 FILE NAME = c:\p\projects\0851007\kpluseng_f.m\196_ab4.sht
 PLOT SCALE = 41.8823 / IN.
 USER NAME = laughtlin1