

| F.A.P. RTE. | SECTION | COUNTY | TOTAL SHEETS | SHEET NO. |
|---------------------|---------|---------------------------|--------------|-----------|
| 753 | 142BR-4 | SANGAMON | 24 | 7 |
| STA. 986+00 | | TO STA. 992+00 | | |
| FED. ROAD DIST. NO. | | ILLINOIS FED. AID PROJECT | | |

| | |
|------|----|
| DATE | BY |
| | |
| | |
| | |
| | |

| | |
|------|----|
| DATE | BY |
| | |
| | |
| | |
| | |

PLOT DATE = Aug-18-2007 07:49:54AM
 FILE NAME = c:\p\projects\0851007\kpluseng_f\ma1\07_rpp_2aht
 PLOT SCALE = 41.8823 / IN.
 USER NAME = laughtim1

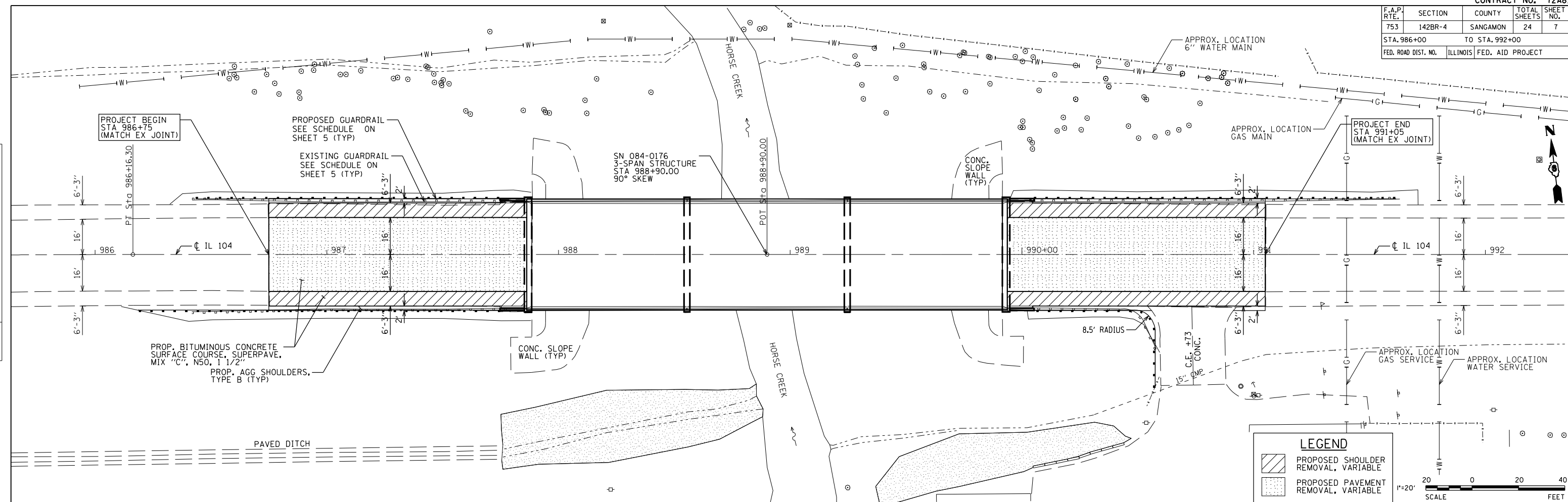

LEGEND

- PROPOSED SHOULDER REMOVAL, VARIABLE
- PROPOSED PAVEMENT REMOVAL, VARIABLE

SCALE: 1"=20' FEET

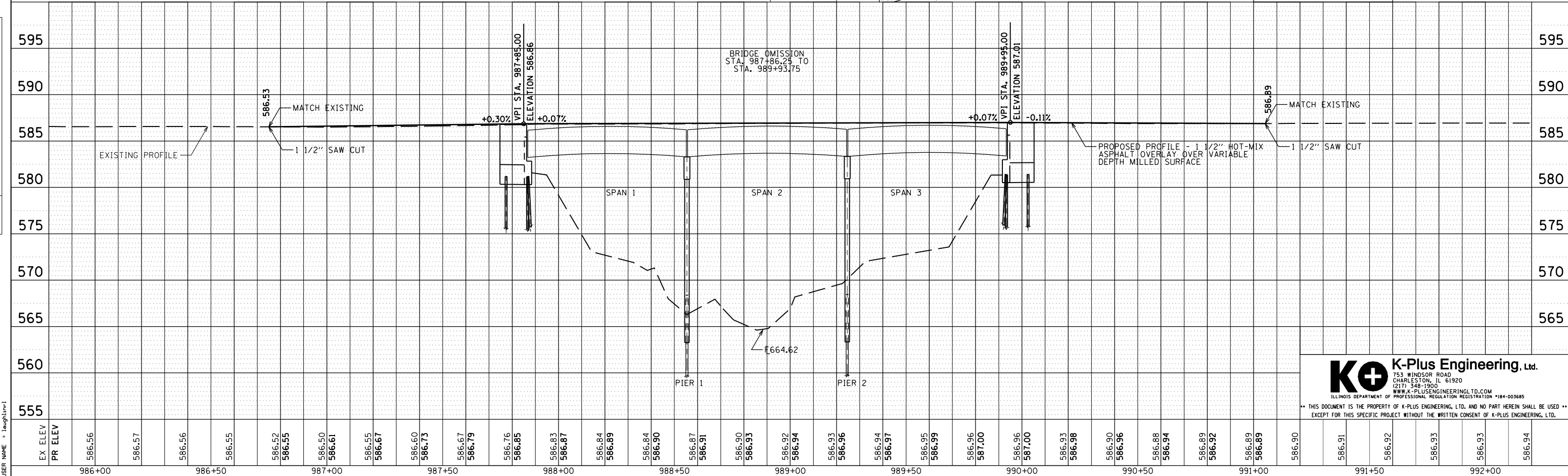

K+ K-Plus Engineering, Ltd.
 753 WINDSOR ROAD
 CHARLESTON, IL 61920
 (217) 548-1900
 WWW.K-PLUSENGINEERING.LTD.COM
 ILLINOIS DEPARTMENT OF PROFESSIONAL REGULATION REGISTRATION #184-003685

THIS DOCUMENT IS THE PROPERTY OF K-PLUS ENGINEERING, LTD. AND NO PART HEREIN SHALL BE USED EXCEPT FOR THIS SPECIFIC PROJECT WITHOUT THE WRITTEN CONSENT OF K-PLUS ENGINEERING, LTD.