

FAP RTE	SECTION	COUNTY	TOTAL SHEETS	SHEET NO.
132	•	SALINE	114	22
STA.		TO STA.		
FED. ROAD DIST. NO.		ILLINOIS FED. AID PROJECT		

•1BR-1, 1BR-2, 1BR-3

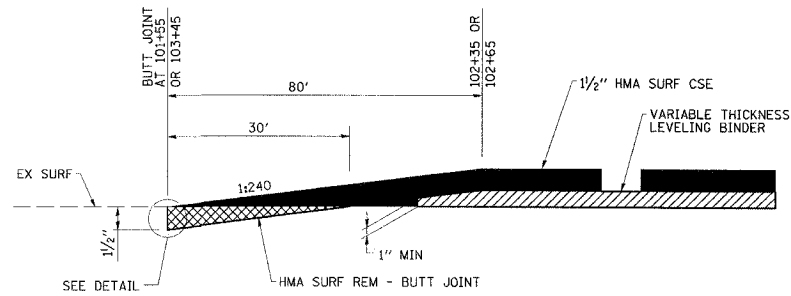

TYPICAL BUTT JOINT SECTION - SN 083-0018

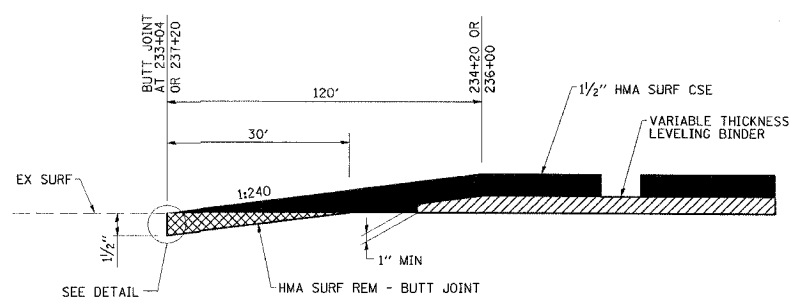

TYPICAL BUTT JOINT SECTION - SN 083-0019

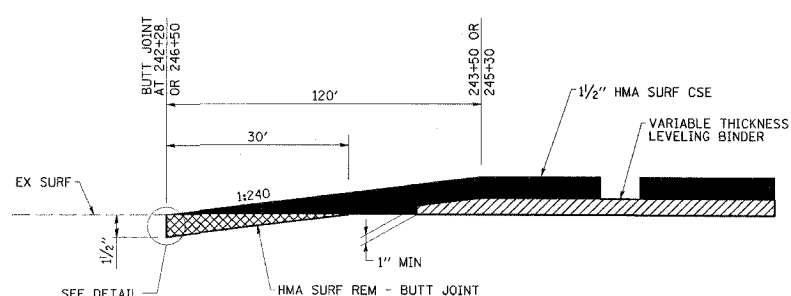

TYPICAL BUTT JOINT SECTION - SN 083-0020

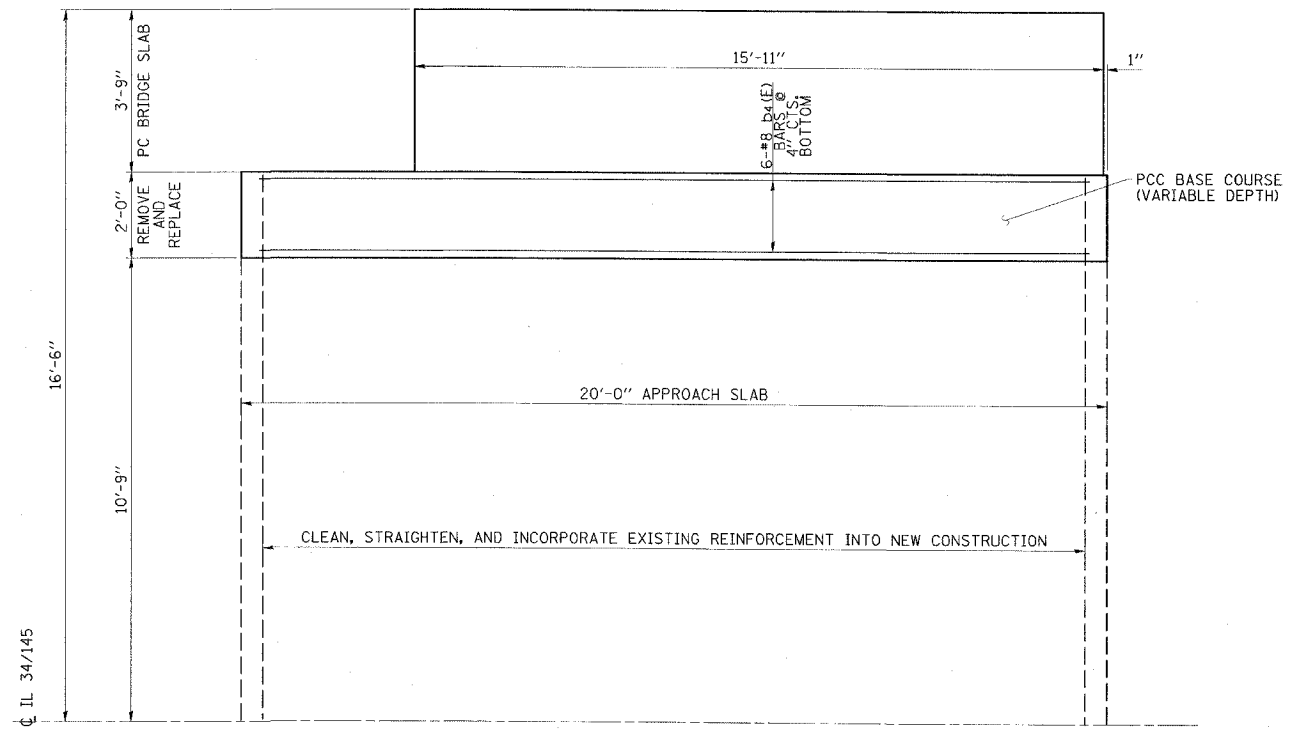

NOTE: THE COST OF REINFORCEMENT BARS AND INCORPORATING EXISTING REINFORCEMENT IS INCLUDED IN PCC BASE COURSE (VARIABLE DEPTH)

PARTIAL PLAN AT NE CORNER

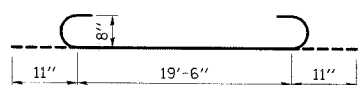

BAR b₄(E)

PCC BASE COURSE DETAILS AT SN 083-0018 ONLY

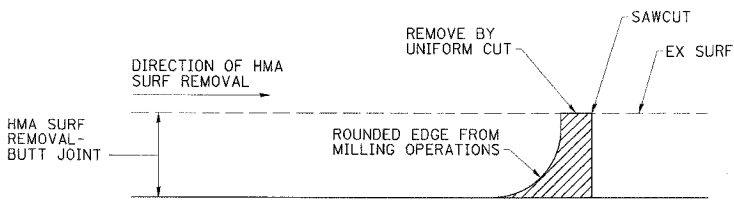

DETAIL AT BUTT JOINT

NOTE: WHEN MILLING OPERATIONS PRODUCE A ROUNDED EDGE, THEN A SAWCUT SHALL BE USED TO MANUFACTURE A PERPENDICULAR EDGE AS SHOWN IN THE DETAIL. THE COST OF ALL WORK SHOWN IN THE DETAIL IS INCLUDED IN HOT-MIX ASPHALT SURFACE REMOVAL - BUTT JOINT. THE ENGINEER SHALL BE THE SOLE JUDGE CONCERNING THE USE OF THIS DETAIL.

ESCA
CONSULTANTS, INC.

DESIGNED BY:	JMS	05/07
DRAWN BY:	HAS	05/07
CHECKED BY:	MTD	06/07
APPROVED BY:	RDP	06/07

MISCELLANEOUS DETAILS
FAP RTE 132 (IL 34/145)
SECTION 1BR-1, 1BR-2, 1BR-3
SALINE COUNTY