

FAU RTE.	SECTION	COUNTY	TOTAL SHEETS	SHEET NO.
3791	02-00037-00-WR	COOK	40	26
F.H.W.A. REG. ILLINOIS PROJECT:		83957		

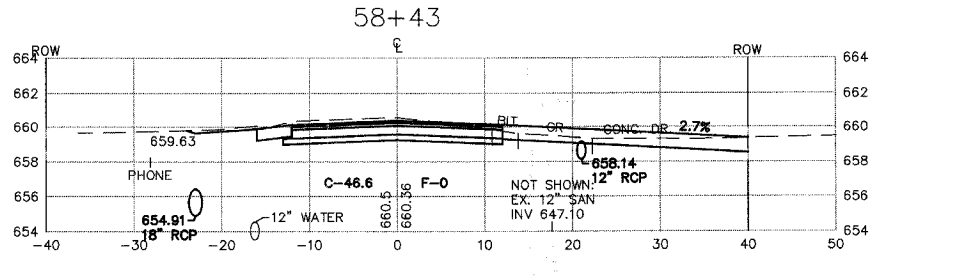
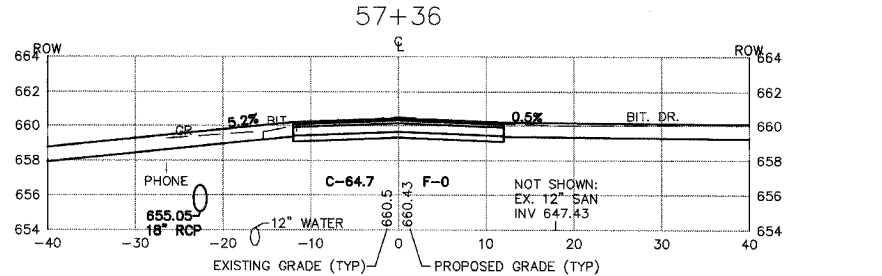
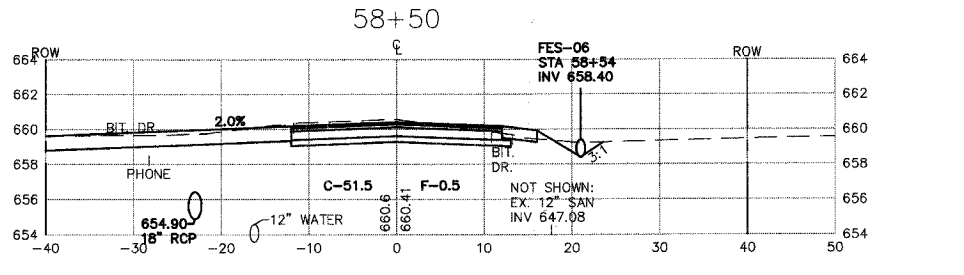
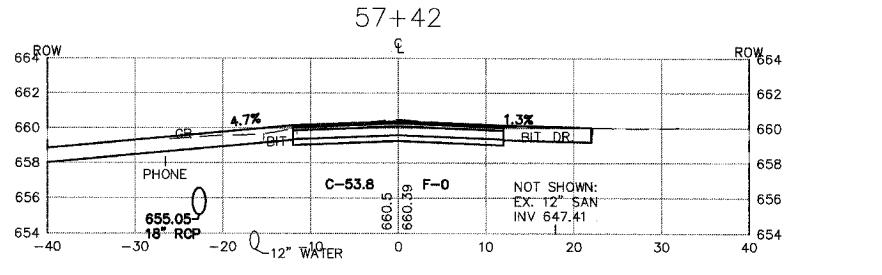
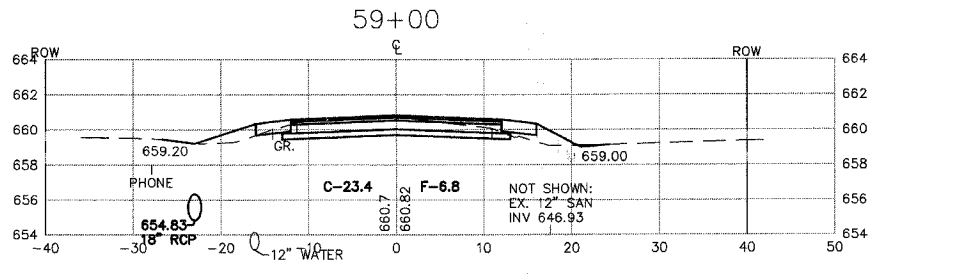
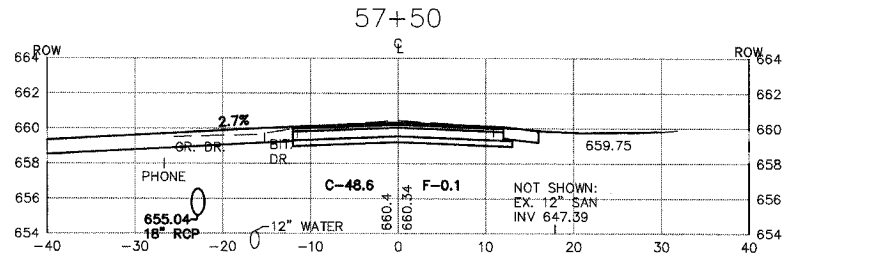
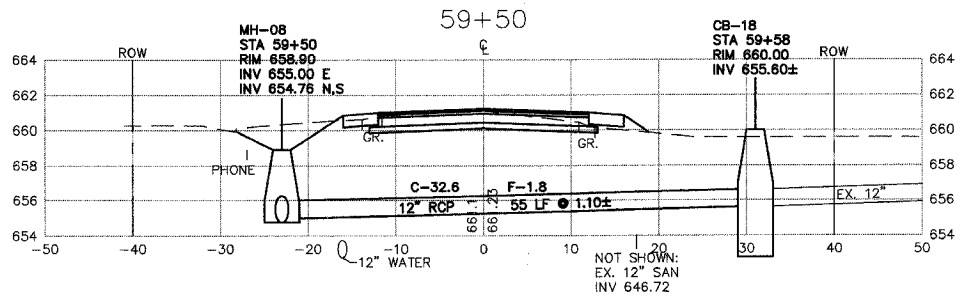
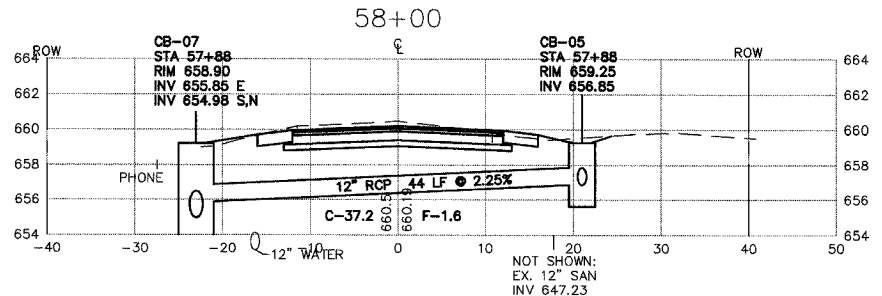
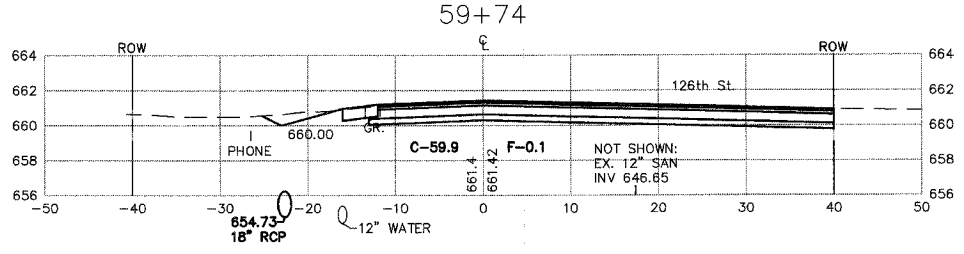
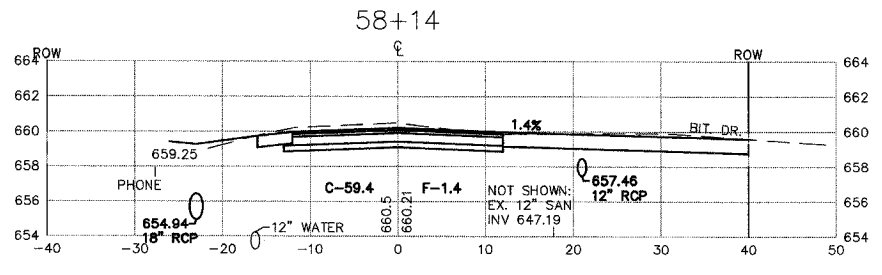

MORRIS ENGINEERING, INC.
 5100 LINCOLN AVE LISLE, ILLINOIS 60532
 PHONE: (630)271-0770 WEBSITE: ECIVIL.COM
 LOCATION: H:\04-PH\3003\PLANS-ENG\REV-3\dwg\SHEET-XSECS.dwg
 DRAWN BY: CJS DESIGN BY: RAC CHECKED BY: JJV
 JOB NO.: 04-PH-3003 SCALE: 1"=10' H 1"=5' V

**76TH AVENUE RECONSTRUCTION
 127TH STREET TO ILLINOIS ROUTE 83
 CROSS SECTIONS
 STA. 57+36 TO STA. 59+74**

DATE	REVISIONS	BY	SHEET
1	5-09-07 PER IDOT REVIEW	RAC	26 OF 40 SHEETS
2	5-24-07 PER IDOT REVIEW	RAC	
3	9-04-07 PER IDOT REVIEW	RAC	
4			

PLOT DATE: SEP 05, 2007
 FILENAME: H:\04-PH\3003\PLANS-ENG\REV-3\dwg\SHEET-XSECS.dwg