

CONDUIT LAYOUT (FACILITIES REMOVED) SHOWING DUCT SECTION

F.A.U. RTE.	SECTION	COUNTY	TOTAL SHEETS	SHEET NO
1545	00-00115-00-BR	DUPAGE	97	72
STA. 1+31.77		TO STA. 5+50.00		
FED. ROAD DIST. NO.	ILLINOIS	FED. AID PROJECT		

CONTRACT 83961

LEGEND

EXISTING

- OVERHEAD
- E-POLE
- E-3-4/0 AAA PRI.
- E-ANCHOR & GUY ASSEMBLY
- E-SW. MOD., FUSE MOD.
- ▲ E-TRANSFORMER
- E-HANDHOLE
- E-1-1/0 STR. AL.
- E-3-4/0 STR. AL.
- E-3-1/0 STR. AL.
- E-DUCT BANK
- ⊙ E-TREES/BUSHES
- E-BOC/SIDEWALK

INSTALL

- UNDERGROUND
- I-SWITCH GEAR VAULT
- I-HANDHOLE
- I-DUCT BANK

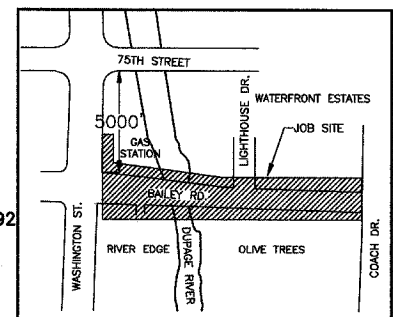
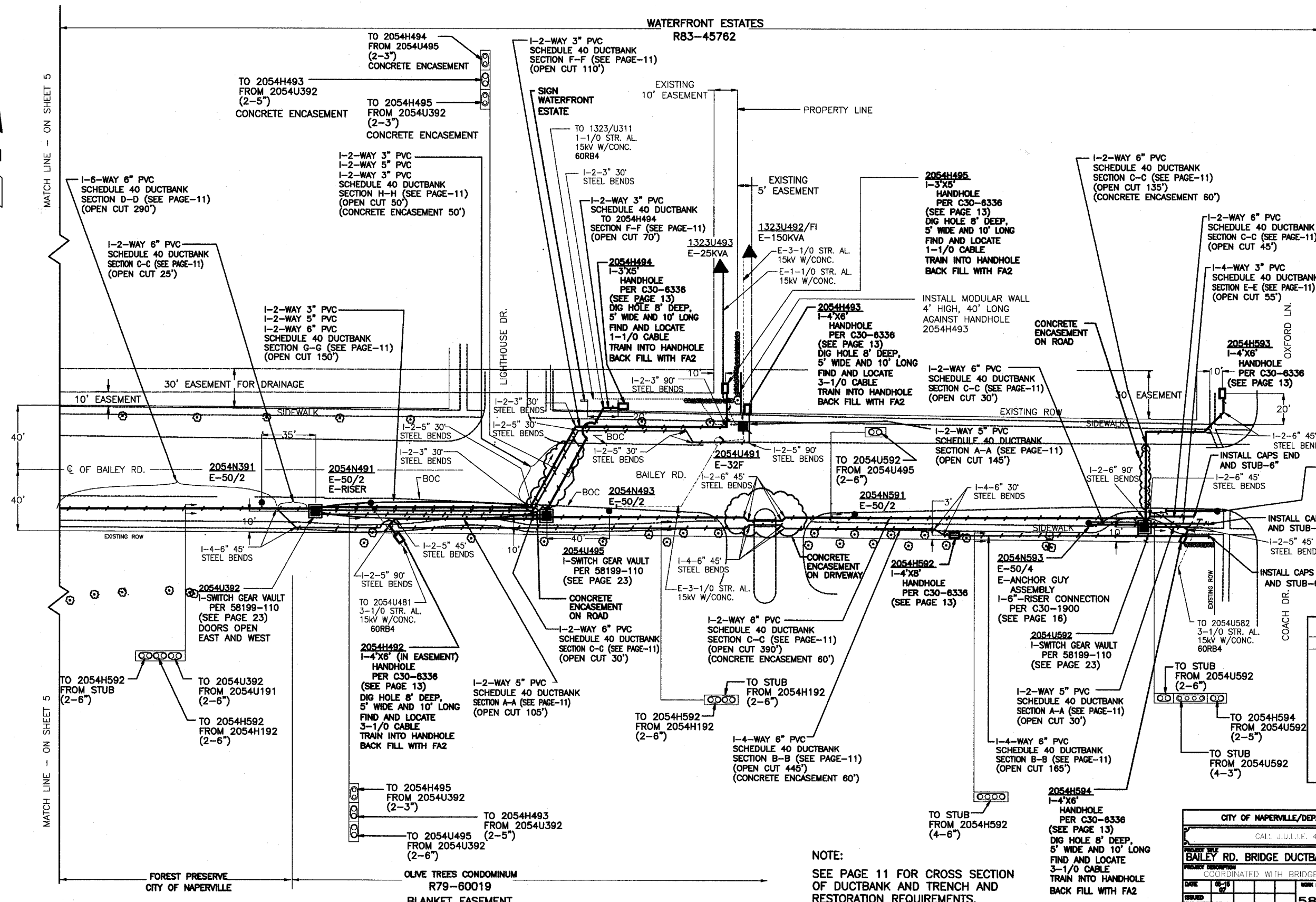

NOTE:
SEE PAGE 11 FOR CROSS SECTION OF DUCTBANK AND TRENCH AND RESTORATION REQUIREMENTS.

CITY OF NAPERVILLE/DEPARTMENT OF PUBLIC UTILITIES - ELECTRIC			
CALL J.U.L.I.E. 48 HRS. PRIOR TO CONSTRUCTION			
PROJECT FILE NO. 58199	MAP NO. 2054/1323	DATE 06-18-07	JOB FILED DATE 06-18-07
PROJECT DESCRIPTION COORDINATED WITH BRIDGE IMPROVEMENT	DRAWN BY JK	ISSUED RPS	PROJECT FILE NO. EU12-06-04
ISSUED RPS	WORK ORDER NO. 58199	SCALE 1"=30'	COMPLETED BY
ENGINEER RPS	APPROVED RPS	SHEET NO. 6 OF 23	