

F.A. RTE.	SECTION	COUNTY	TOTAL SHEETS	SHEET NO.
--	03-00019-00-BR	DUPAGE	35	12
STA.		TO STA.		
FED. ROAD DIST. NO. 1		ILLINOIS		FED. AID PROJECT
CONTRACT NO. 83965				

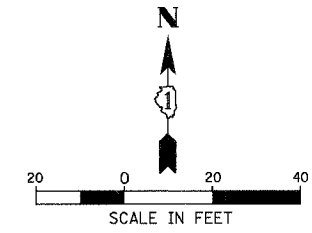

DATE	BY
DATE	BY
DATE	BY

CHRISTOPHER B. BURKE ENGINEERING LTD.
 9575 West Higgins Road, Suite 600
 Rosemont, Illinois 60018
 (847) 823-0500
CB
BE

DATE	BY
DATE	BY
DATE	BY

PROFILE
 SURVEYED
 PLOTTED
 CHECKED
 S.M. NOTED
 S. PRINCIPAL NOTATIONS: CHND
 NO.

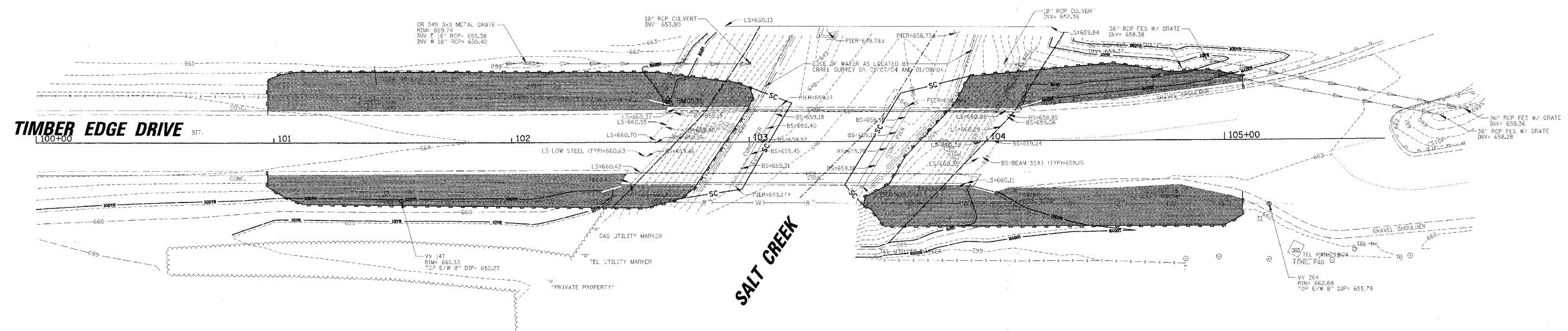

- 10yr — 10- YEAR FLOODPLAIN (659.3)
- 100yr — 100- YEAR FLOODPLAIN (661.3)
- FLOODWAY
- SEEDING CLASS 3
- DOUBLE PERIMETER EROSION BARRIER
- SC — SILT CURTAIN

REVISIONS	
NAME	DATE
PER DUCEDP	7/11/07

ILLINOIS DEPARTMENT OF TRANSPORTATION
EROSION CONTROL AND LANDSCAPING PLAN
 SCALE: 20'
 DATE 8/24/2007
 DRAWN BY BEH
 CHECKED BY LMF