

FAS	SECTION	COUNTY	TOTAL SHEETS
2111	01-00268-00-BR	KANE	70
STA. 16+50.00		TO STA. 17+50.00	
FED. ROAD DIST. NO.	ILLINOIS	CONTRACT NO. 8397	

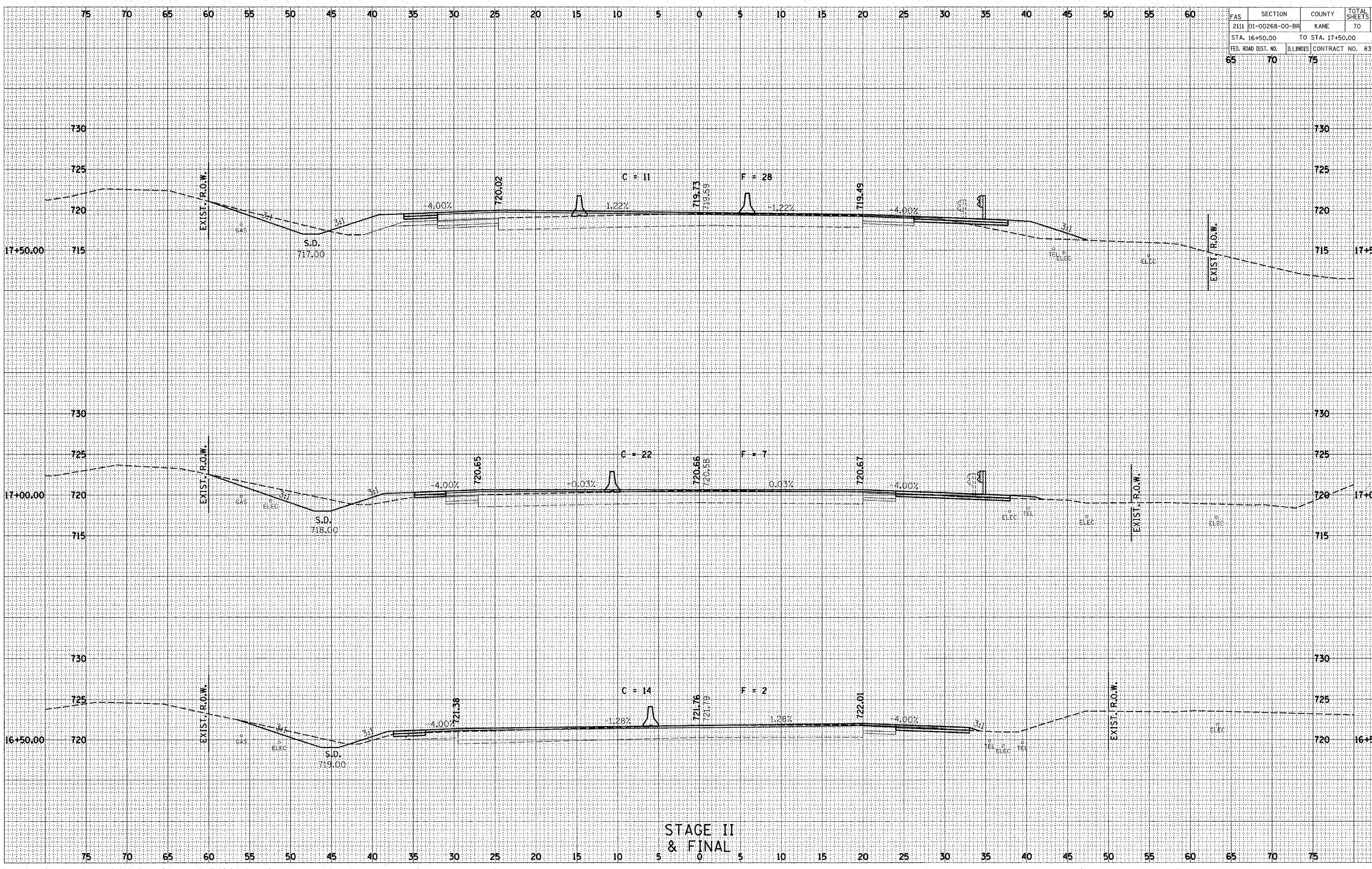

STAGE II
& FINAL

NOTE BOOK TEMPLATE AREAS CHECKED

NOTE BOOK TEMPLATE AREAS CHECKED