

FAS	SECTION	COUNTY	TOTAL SHEETS
2111	01-00268-00-BR	KANE	70
STA. 18+50.00		TO STA. 19+00.00	
FED. ROAD DIST. NO.	ILLINOIS	CONTRACT NO. 6397	
65	70	75	

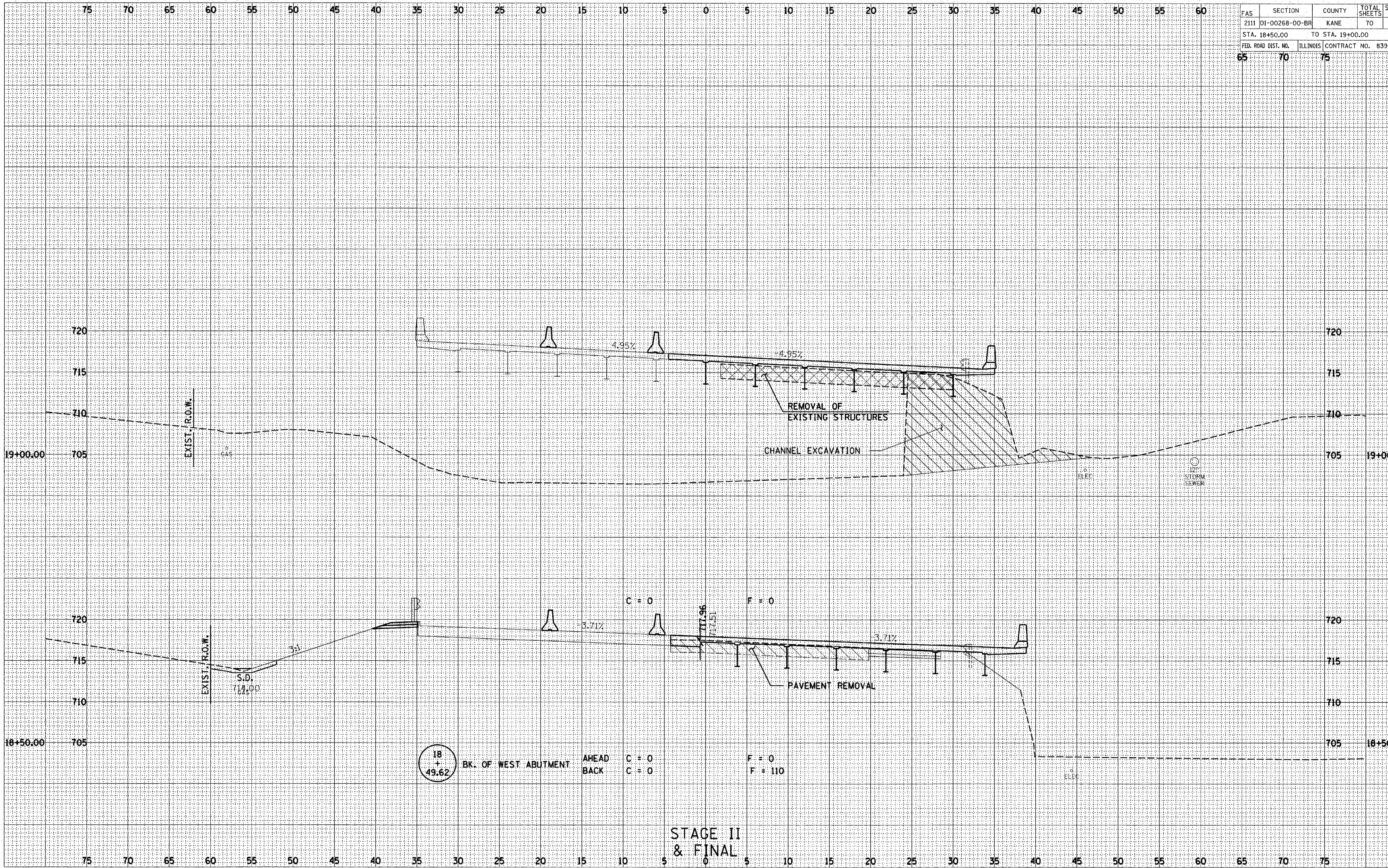

NOTE BOOK TEMPLATE AREAS CHECKED

NOTE BOOK TEMPLATE AREAS CHECKED

18 + 49.62 BK. OF WEST ABUTMENT

AHEAD C = 0  
BACK C = 0

F = 0  
F = 110

STAGE II & FINAL