

FAS	SECTION	COUNTY	TOTAL SHEETS	SH. NO.
2111	01-00268-00-BR	KANE	70	5
STA. 19+25.00		TO STA. 19+75.00		
FED. ROAD DIST. NO.		ILLINOIS CONTRACT NO. 8397		

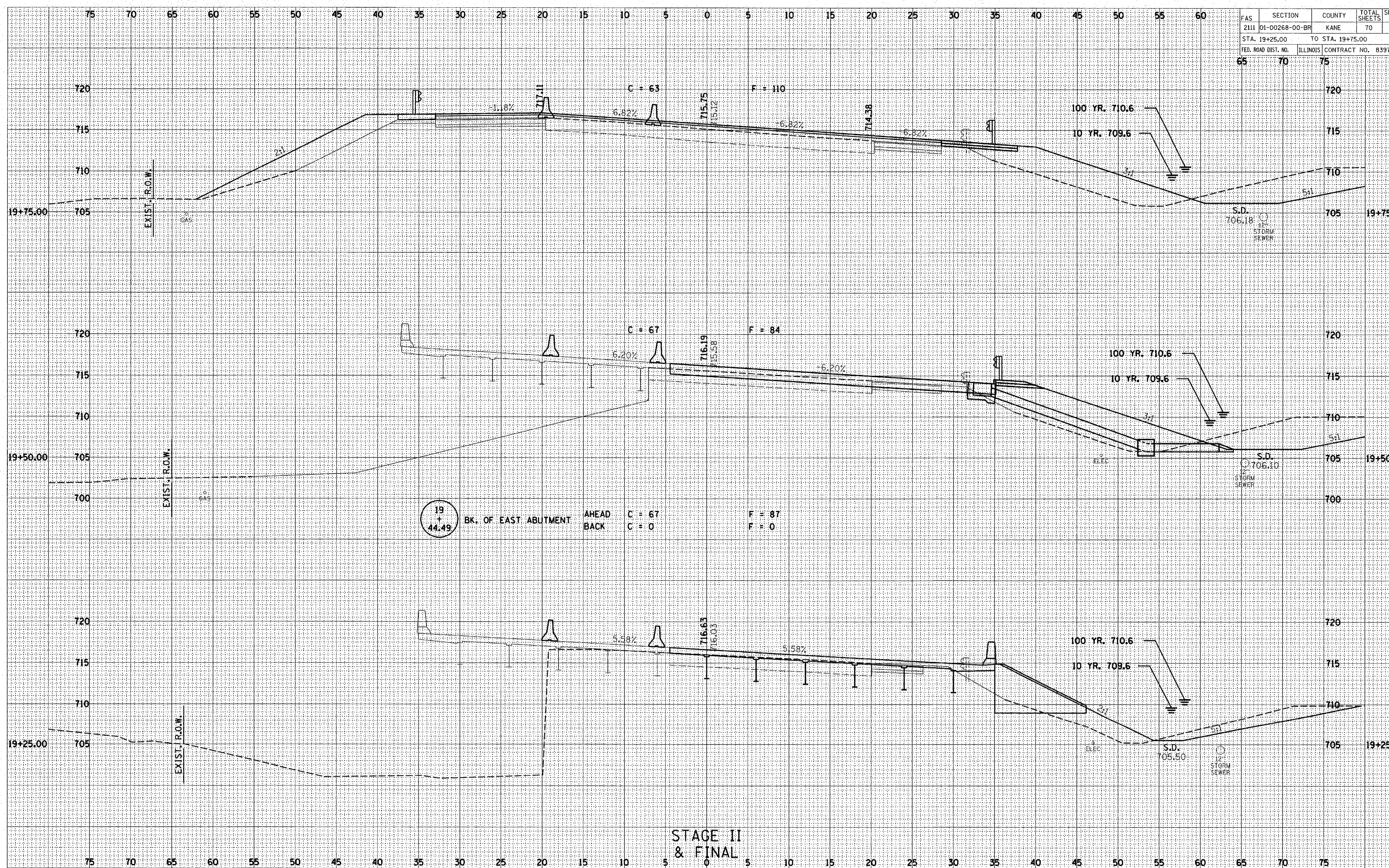

19 + 44.49 BK. OF EAST ABUTMENT  
 AHEAD C = 67 F = 87  
 BACK C = 0 F = 0

STAGE II & FINAL