

F.A.U. RTE.	SECTION	COUNTY	TOTAL SHEETS	SHEET NO.
5355	04-00167-00-WR	DEKALB	62	25
STA.		TO STA.		
FED. ROAD DIST. NO.		ILLINOIS FED. AID PROJECT		

PT.	STA.	OFFSET	ELEVATION	
			EXIST.	PROP.
1	+52.47	43.00' RT	842.6	842.60
2	+63.47	60.29' RT	842.9	842.87
3	+63.56	42.58' RT	842.7	842.71
4	+71.60	34.62' RT	842.7	842.69
5	+79.56	42.66' RT	842.7	842.68
6	+79.48	59.71' RT	842.8	842.84
7	+90.48	43.00' RT	842.5	842.46
8	+90.48	23.00' RT	842.5	842.94
9	+00.00	23.00' RT	842.4	842.86

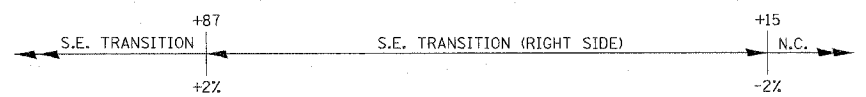
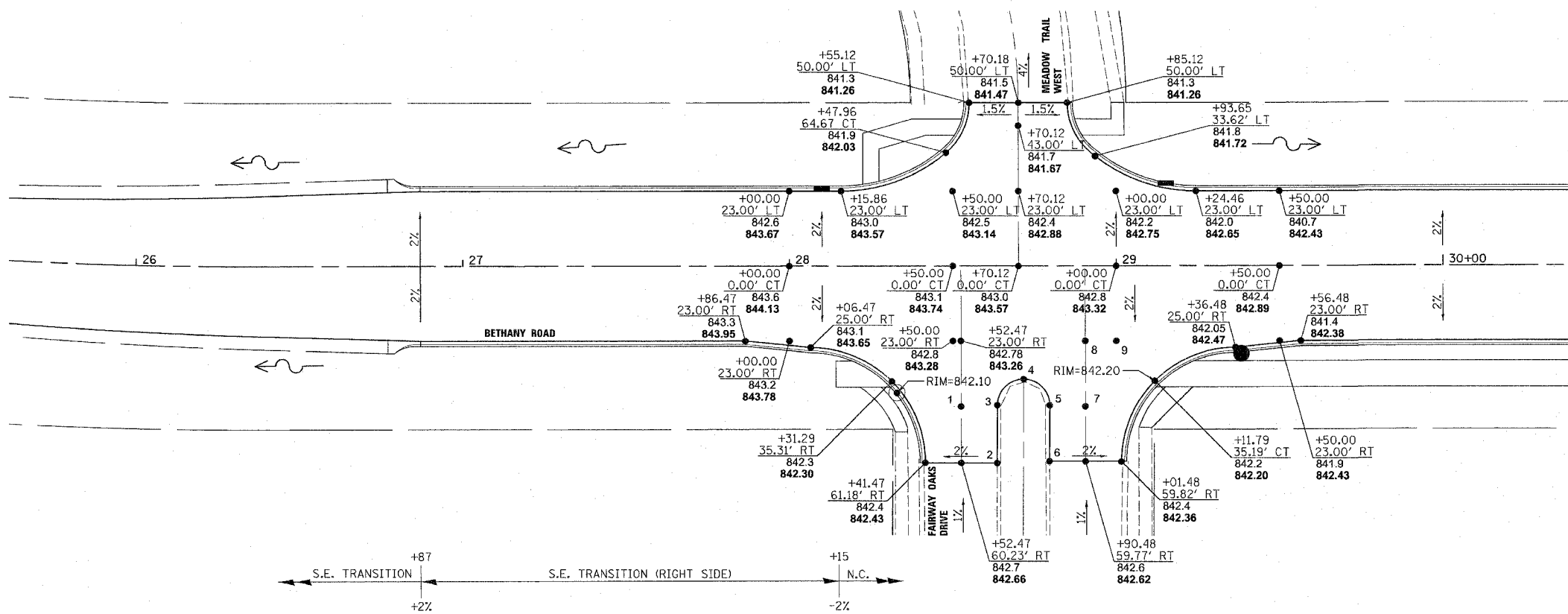

**LEGEND**

- PARTIAL STATION
- OFFSET
- EX. SPOT ELEV.
- PROP. SPOT ELEV.



**GRAPHIC SCALE**

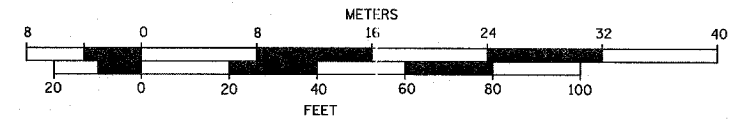

PLOT DATE = 8/16/2007  
 FILE NAME = H:\DeKalb\157283-BethanyRd\Civil\Drawings\11181.dgn  
 PLOT SCALE = 1"=20'  
 USER NAME = USER

**RHA&A**  
 Robert H. Anderson & Associates, Inc.  
 Consulting Engineers  
 Timbers Professional Center  
 220 West River Drive, St. Charles, IL 60174  
 Phone - 630.584.3530 Fax - 630.584.3047

REVISIONS	
NAME	DATE

ILLINOIS DEPARTMENT OF TRANSPORTATION  
 BETHANY ROAD WIDENING  
 FAIRWAY OAKS DRIVE TO RESOURCE PARKWAY  
 CITY OF DEKALB  
 INTERSECTION DETAIL  
 FAIRWAY OAKS / MEADOW TRAIL WEST  
 SCALE: 1"=20'  
 DATE: 8/17/07  
 DRAWN BY: KMA  
 CHECKED BY: BP