

F.A.P. RTE.	SECTION	COUNTY	TOTAL SHEETS	SHEET NO.
310	(28-BR)I	WARREN	97	19
STA. 824+00.00		TO STA. 833+50.00		
FED. ROAD DIST. NO.	ILLINOIS	US 67		

 - PAVEMENT REMOVAL

INSTALL FLASHING LIGHT ON THE TRAFFIC SIGNAL WARNING SIGN SOUTH OF THE BRIDGE. PAYMENT FOR THE FLASHING LIGHT SHALL BE INCLUDED IN THE COST OF STD. 701321.

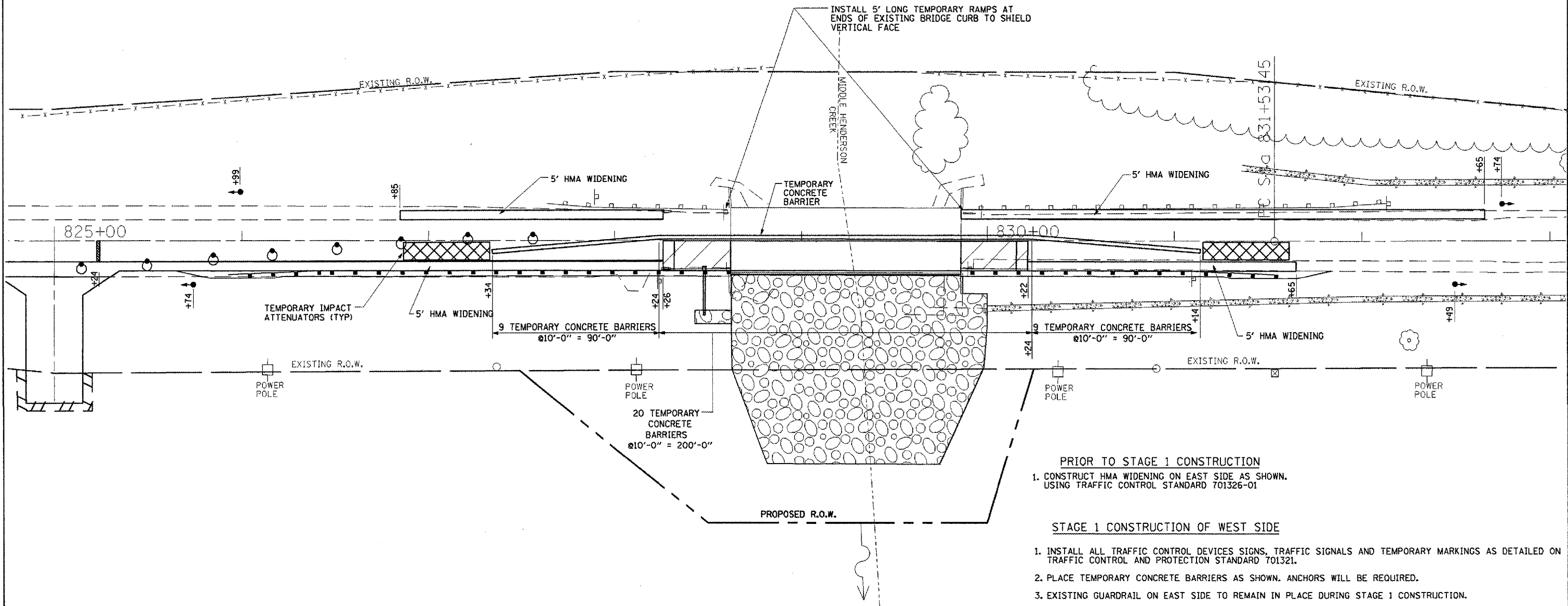

- PRIOR TO STAGE 1 CONSTRUCTION**
1. CONSTRUCT HMA WIDENING ON EAST SIDE AS SHOWN. USING TRAFFIC CONTROL STANDARD 701326-01

STAGE 1 CONSTRUCTION OF WEST SIDE

1. INSTALL ALL TRAFFIC CONTROL DEVICES SIGNS, TRAFFIC SIGNALS AND TEMPORARY MARKINGS AS DETAILED ON TRAFFIC CONTROL AND PROTECTION STANDARD 701321.
2. PLACE TEMPORARY CONCRETE BARRIERS AS SHOWN. ANCHORS WILL BE REQUIRED.
3. EXISTING GUARDRAIL ON EAST SIDE TO REMAIN IN PLACE DURING STAGE 1 CONSTRUCTION.
4. INSTALL TEMP. SHEET PILING AS SHOWN ON MIDDLE HENDERSON S.N. 094-0002 STRUCTURAL PLANS
5. REMOVE GUARDRAIL, PAVEMENT, AND WEST SIDE OF EXISTING DECK AS SHOWN.
6. CONSTRUCT BRIDGE DECK, APPROACH PAVEMENTS, APPROACH PAVEMENT CONNECTORS, HMA WIDENING, AND ALL OTHER COLLATERAL WORK FOR WEST SIDE OF ROADWAY AS SHOWN.

NOTE: APPROACH PAVEMENT CONNECTOR WILL HAVE TO BE GRADED TO TRANSITION TO EXISTING PROFILE ON THE NORTH APPROACH FOR STAGING OPERATIONS.

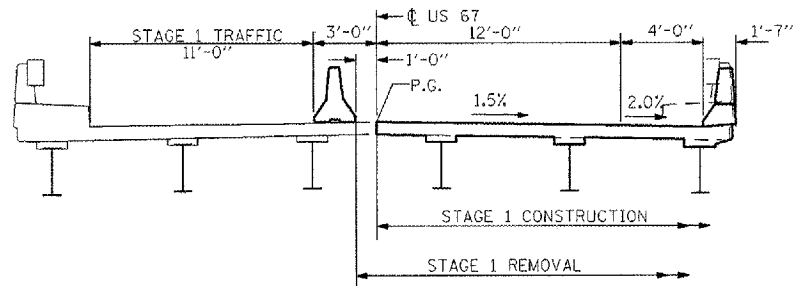

STAGE 1 CONSTRUCTION CROSS SECTION
(Looking South)

(28-BR)I
STAGE 1 CONSTRUCTION AT MIDDLE HENDERSON CREEK

REVISIONS	
NAME	DATE

ILLINOIS DEPARTMENT OF TRANSPORTATION
STAGE 1 CONSTRUCTION
MIDDLE HENDERSON CREEK
SN 094-0002

SCALE: _____
DATE: 04-02-04

DRAWN BY: BAD
CHECKED BY: JLG