

F.A.P. RTE.	SECTION	COUNTY	TOTAL SHEETS	SHEET NO.
315	(108B)BR, BR-1	McDonough	80	12
STA. 63+00 TO STA. 74+00				
FED. ROAD DIST. NO. 7		ILLINOIS	FED. AID PROJECT	

CONTRACT NO. 88799

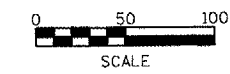

ROBERT RUTLEDGE
T5N-R1W
SEC.10

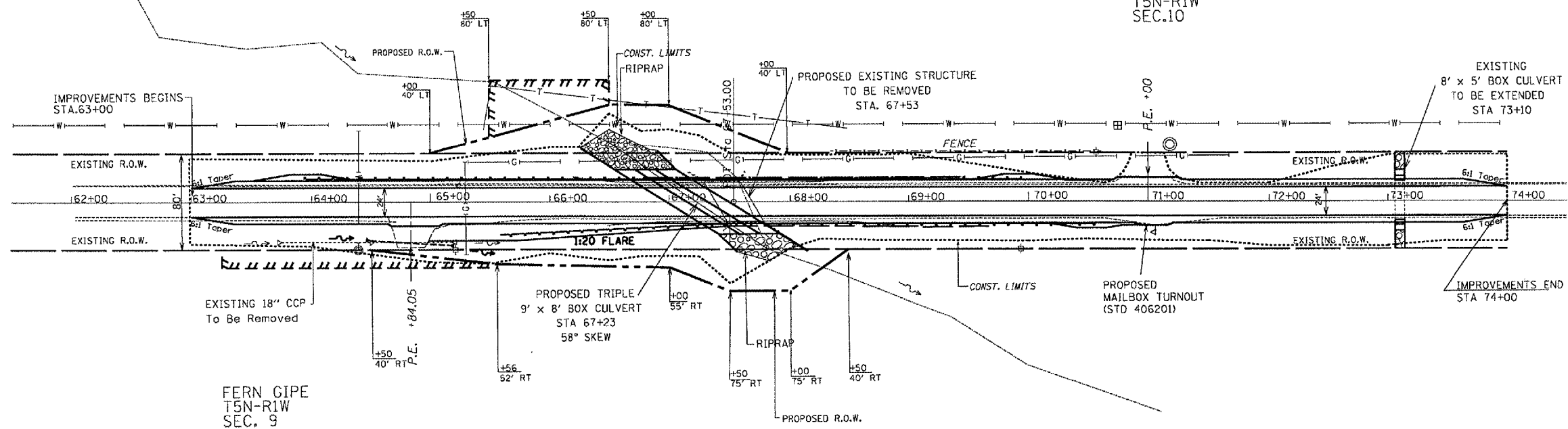

PLAN	DATE
BY	
CHECKED	
DESIGNED	
NOTED	
NO.	

PROFILE	DATE
BY	
CHECKED	
DESIGNED	
NOTED	
NO.	

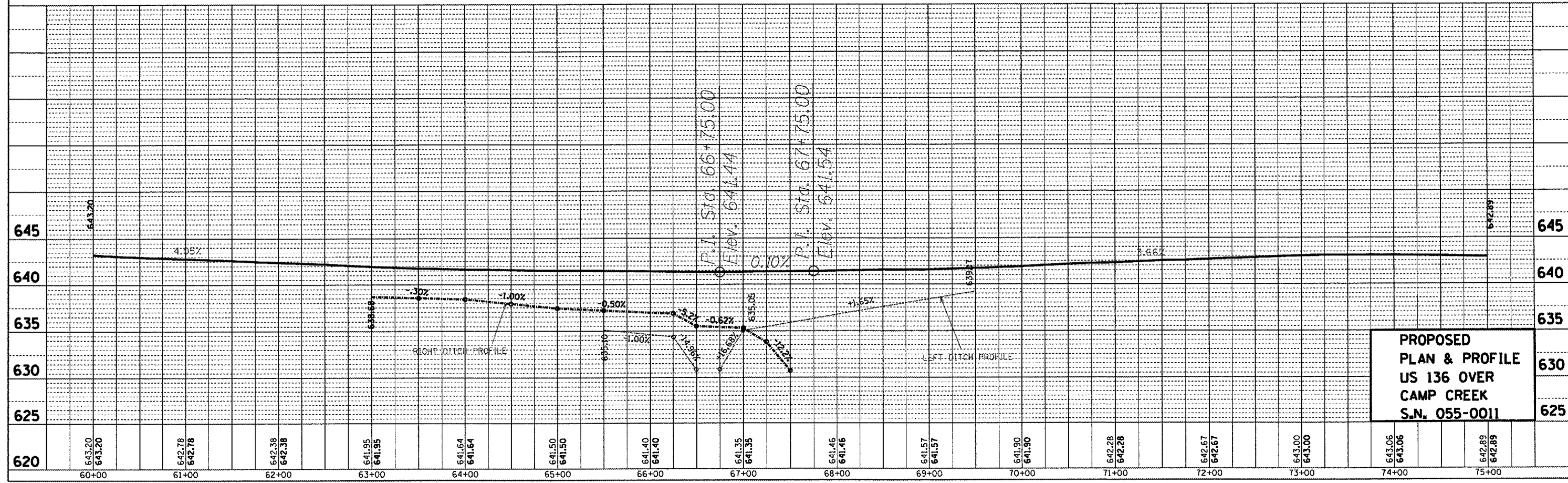

**PROPOSED
PLAN & PROFILE
US 136 OVER
CAMP CREEK
S.N. 055-0011**