

Bench Mark: A chiseled '□' on east side of south abutment of the existing bridge over Camp Creek. Elev. 641.10

Existing Structure: The existing Structure No. 055-0011, built in 1928, is a single span reinforced concrete slab bridge on closed abutments with top and bottom restrained. Structure to be replaced by a reinforced triple barrel concrete box culvert. Traffic to be maintained utilizing stage construction. No salvage.

ROUTE NO.	SECTION	COUNTY	TOTAL SHEETS	SHEET NO.
F.A.P. 315	BR-1	MCDONOUGH	80	16
FED. ROAD DIST. NO. 7		ILLINOIS	FED. AID PROJECT	Contract #88799

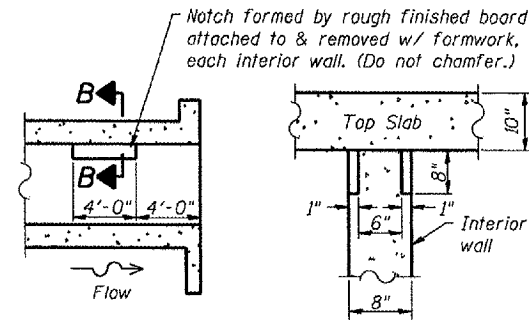
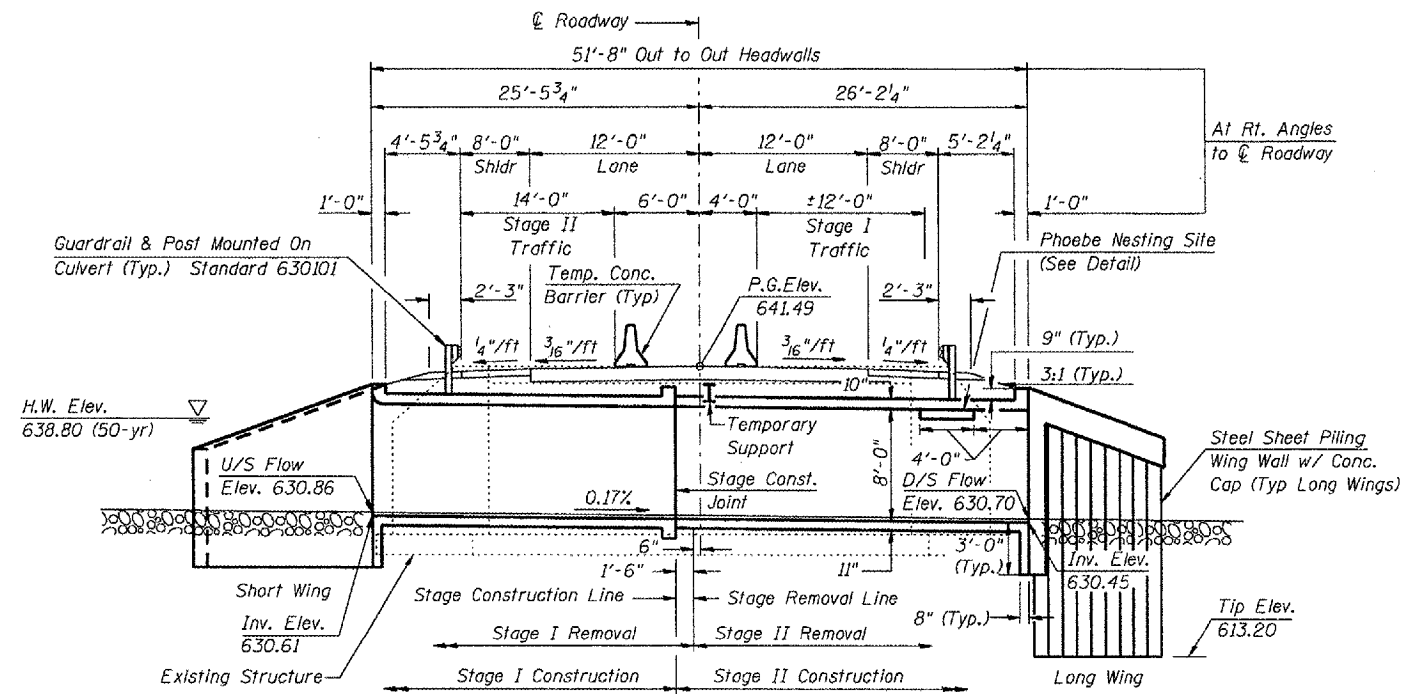

LONGITUDINAL SECTION SECTION B-B  
PHOEBE NESTING SITE DETAIL  
(Downstream End Only)

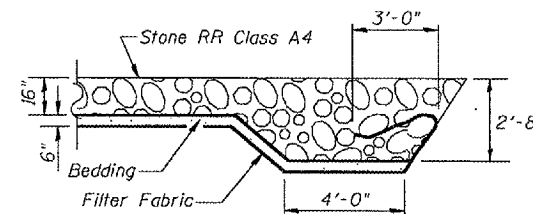

**DESIGN SPECIFICATIONS**

2002 AASHTO "Standard Specifications for Highway Bridges"

**DESIGN STRESSES**

$f'_c = 3,500$  psi  
 $f_y = 60,000$  psi (Reinforcement)  
 $f_y = 36,000$  psi (Structural Steel for Temporary Support System)

**LOADING HS20-44**

Allow 50 psf for future wearing surface

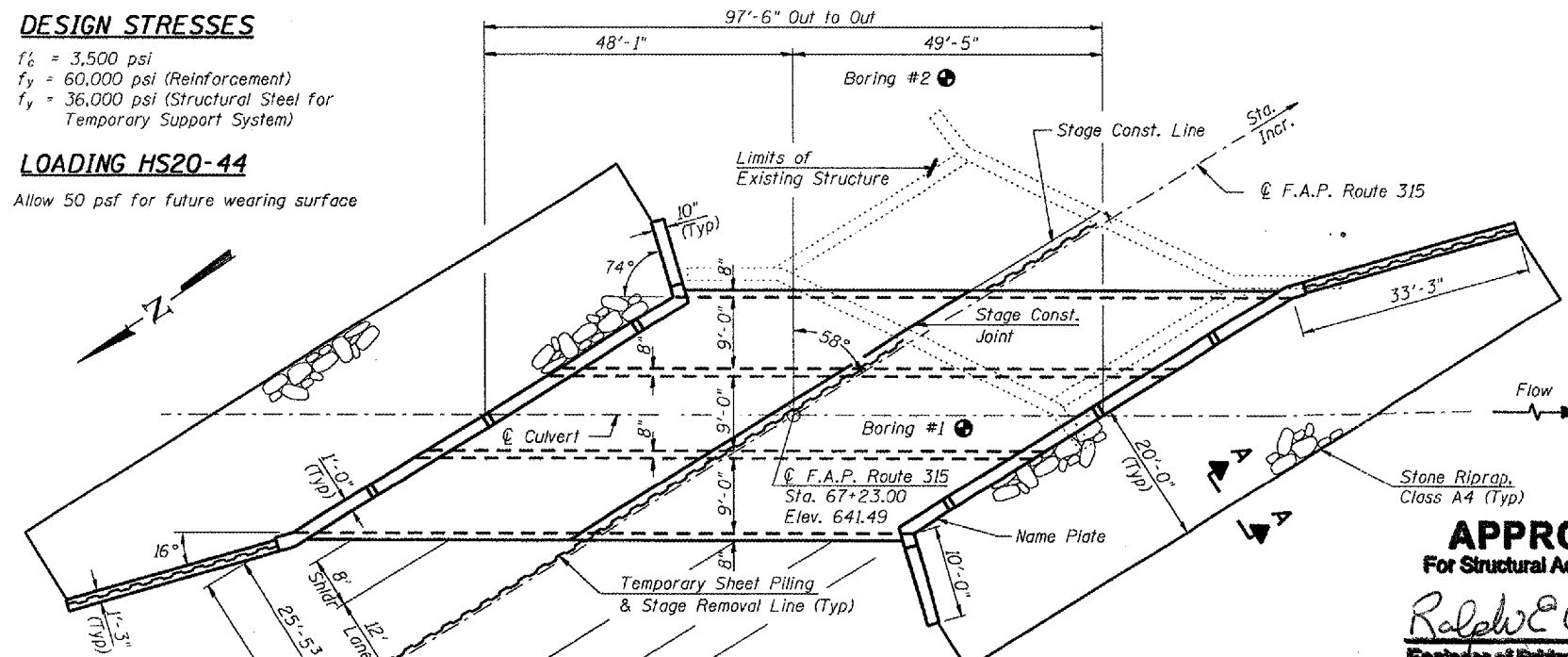

STATION 67+23.00  
 BUILT 20 BY  
 STATE OF ILLINOIS  
 F.A.P. RT. 315 SEC. (108B)BR-1  
 LOADING HS20  
 STR. NO. 055-2004

**NAME PLATE**  
 See Std. 515001

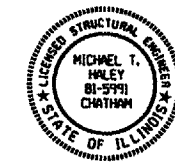

**APPROVED**  
 For Structural Adequacy Only  
 Ralph E. Anderson (PE)  
 Engineer of Bridges & Structures

Michael T. Holey  
 Licensed Structural Engineer  
 State of Illinois No. 81-5991  
 9-13-06  
 Date

**TOTAL BILL OF MATERIAL**

ITEM	UNIT	TOTAL
Concrete Box Culverts	Cu. Yd.	291.4
Removal of Existing Structures	Each	1
Reinforcement Bars	Pound	93170
Bar Splicers	Each	219
Temporary Sheet Piling	Sq. Ft.	1904
Name Plates	Each	1
Stone Riprap, Class A4	Sq. Yd.	357
Filter Fabric	Sq. Yd.	357
Temporary Support System	L.S.	1
Permanent Steel Sheet Piling	Sq. Ft.	1521

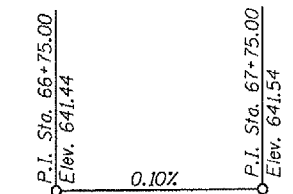

**PROPOSED PROFILE GRADE**

F.A.P. Route 315 (US Route 136)  
 Along C of Road

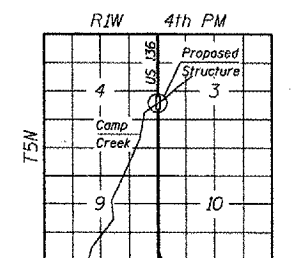

LOCATION SKETCH

**WATERWAY INFORMATION**

Drainage Area = 5.10 sq. mi. Low Grade Elev. 641.4' @Sta. 33+300

Flood Yr.	Freq.	C.F.S.	Opening	Nat. H.W.E.	Head-Ft.	Headwater El.
			Sq. Ft.	Exist.	Prop.	Exist. Prop.
Design	50	1273	145 216	638.8 638.8	2.3 0.7	641.1 639.5
Base	100	1476	151 216	639.0 639.0	2.7 1.0	641.7 640.0
Overtopping	75	1388	149	638.9	2.6	641.5
Max. Calc.	500	1970	216	639.4	1.9	641.3

**LIN ENGINEERING, LTD.**  
 20 W. Chestnut  
 Elmhurst, Illinois 60120  
 Phone: 630-461-4800  
 Fax: 630-461-4100  
 Designed By: KMS Checked By: MTH Drawn By: JND Date: 04/04 File: 052004.DWG

REVISIONS	
NAME	DATE

ILLINOIS DEPARTMENT OF TRANSPORTATION  
**GENERAL PLAN**  
 F.A.P. RTE 315 (U.S. ROUTE 136)  
 OVER CAMP CREEK  
 SECTION (108B)BR-1  
 MCDONOUGH COUNTY  
 STA. 67+23.00  
 STRUCTURE NO. 055-2004