

F.A.S. RTE.	SECTION	COUNTY	TOTAL SHEETS	SHEET NO.
1513	5BR-1	CHAMPAIGN	38	6
STA. 13+00 TO STA. 18+00				
FED. ROAD DIST. NO. 5 ILLINOIS FED. AID PROJECT				

T 19 N, R 7 E, S 17, 3RD P.M.

PROPOSED TWO SPAN ROLLED  
STEEL BEAM WITH REINFORCED  
CONCRETE SLAB ON SPILL THRU  
ABUTMENTS  
120' CLEAR SPAN  
35'-2" OUT-TO-OUT  
STATION 16+69, SKEW 50°

RIPRAP PT.	STATION	OFFSET	RIPRAP PT.	STATION	OFFSET	RIPRAP PT.	STATION	OFFSET
A	15+74.00	35' R	E	16+12.18	45.34' L	I	17+51.64	45' L
B	15+97.51	35' R	F	17+25.82	35' R	J	17+63.96	45' L
C	16+03.33	41.93' R	G	16+75.08	8.08' R			
D	16+69.61	13.69' L	H	17+45.83	51.94' L			

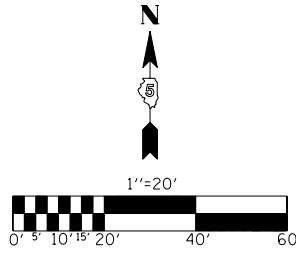

DATE	BY	REVISION

- LEGEND**
- TBR TO BE REMOVED
  - BUTT JOINT STA. 13+00 TO 13+30
  - PAVEMENT REMOVAL
  - STONE RIPRAP, CLASS A4
  - PERIMETER EROSION BARRIER (TO CONTINUE AROUND BRIDGE CONE DURING CONSTRUCTION)
  - TEMPORARY DITCH CHECK

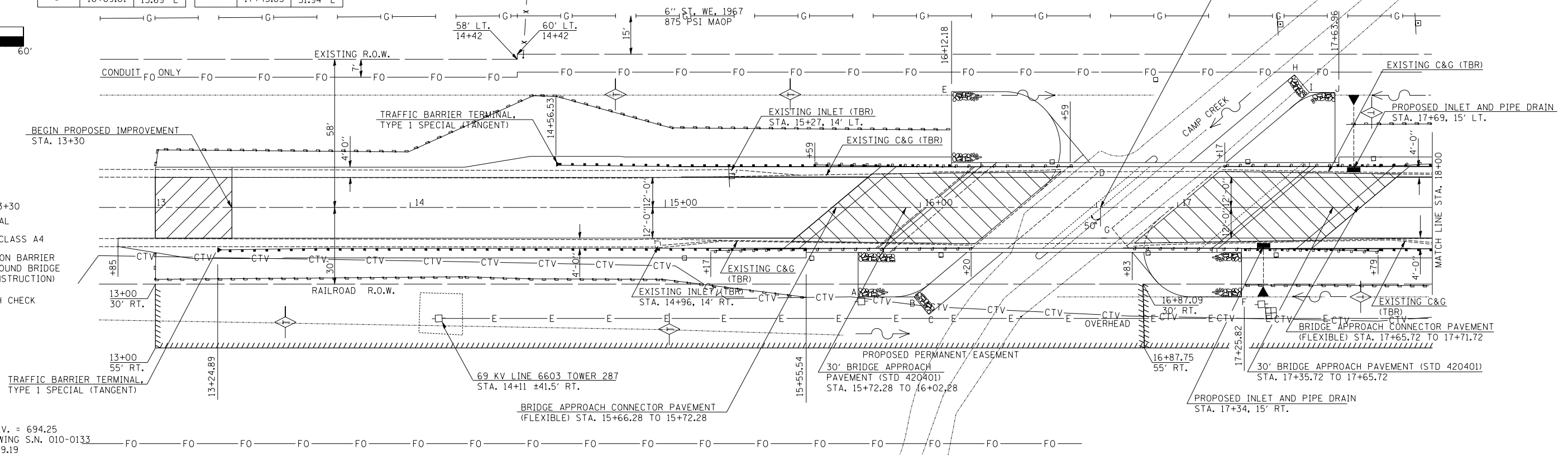

BENCHMARK: 4604-2 ELEV. = 694.25  
CHISELED "□" ON N.W. WING S.N. 010-0133  
18.37' LT., STATION 16+59.19

DATE	BY	REVISION

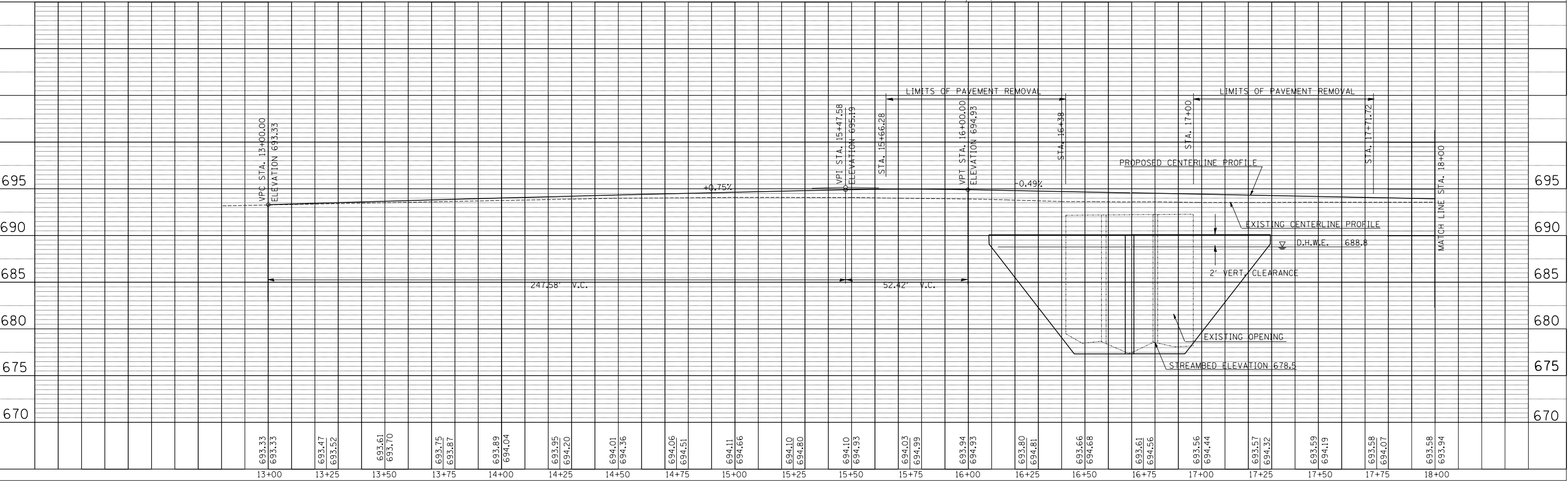

TUG PROJ. # 3106979-02  
PLOT DATE = 7/29/2007 11:17:26 AM  
FILE NAME = p:\1007\Substruc5\Comp Creek Revised\10 2\CAD00.ppl.dgn