

F.A.S. RTE.	SECTION	COUNTY	TOTAL SHEETS	SHEET NO.
1513	5BR-1	CHAMPAIGN	38	7
STA. 18+00		TO STA. 19+00		
FED. ROAD DIST. NO. 5		ILLINOIS FED. AID PROJECT		

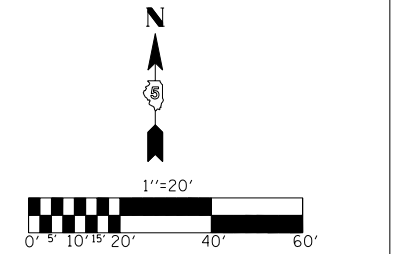

T 19 N, R 7 E, S 17, 3rd PM

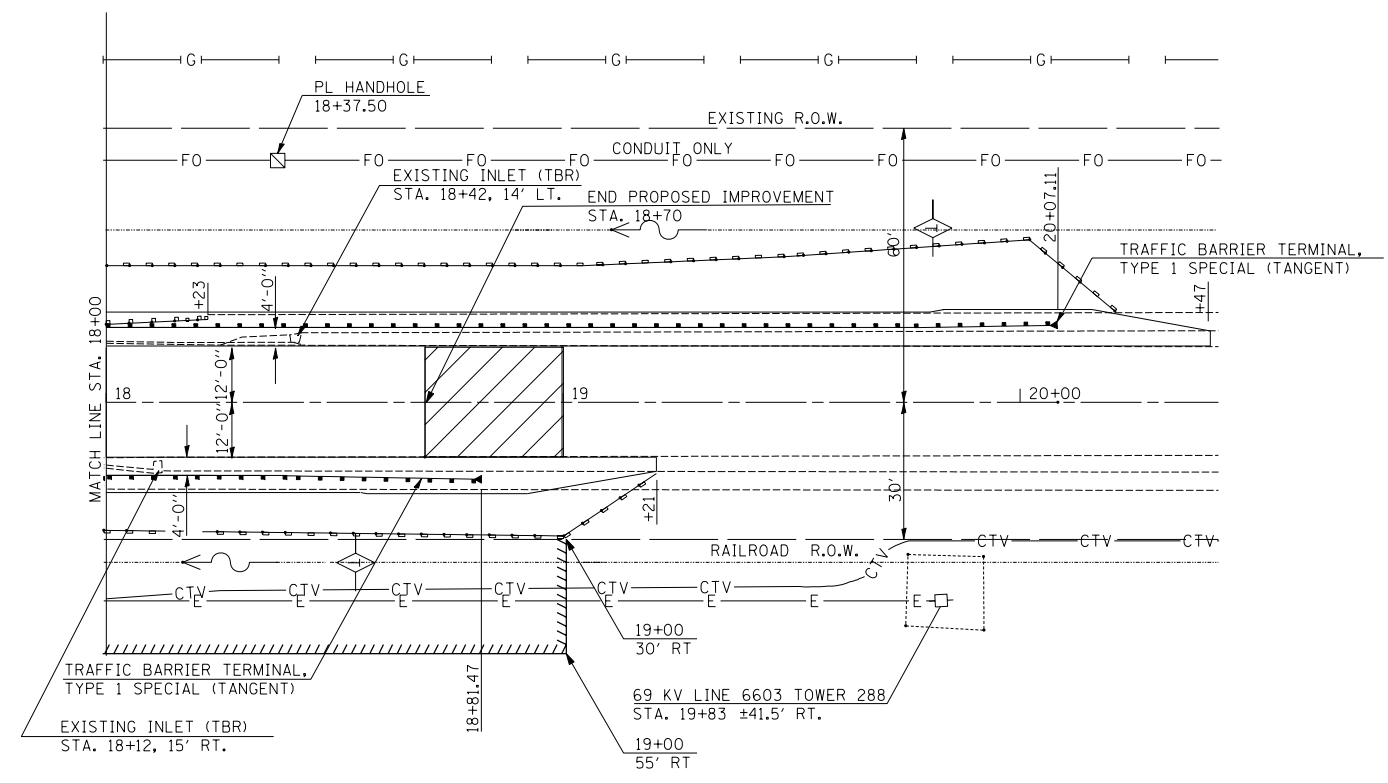
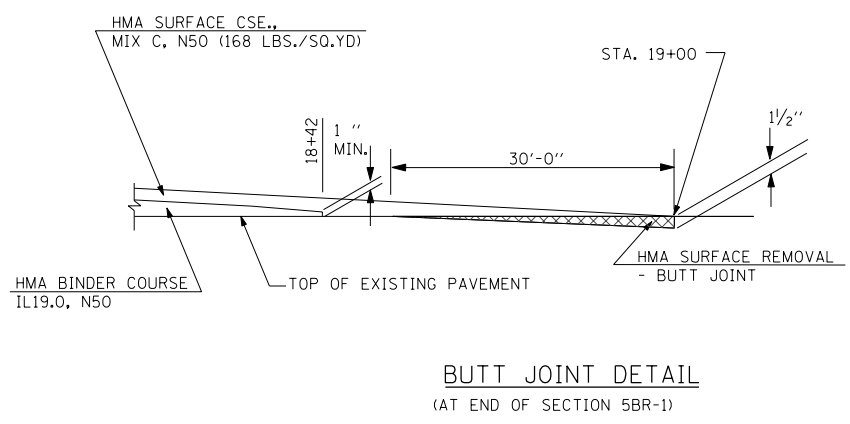
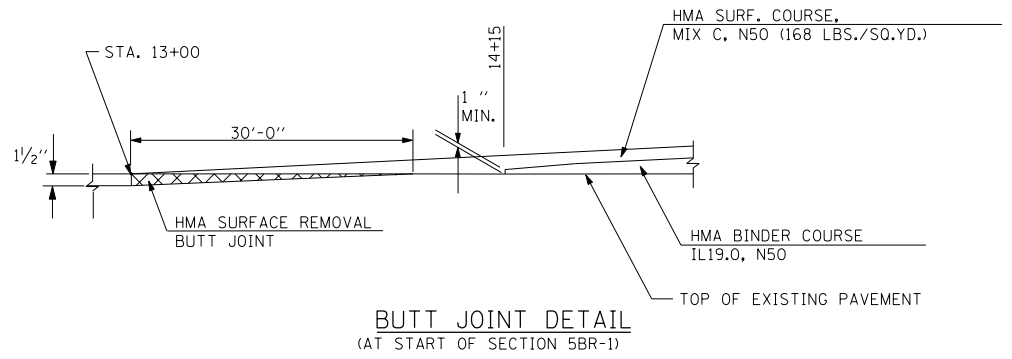

**LEGEND**

TBR TO BE REMOVED

BUTT JOINT STA. 18+70 TO 19+00

DATE	BY

PLAN

SURVEYED BY: \_\_\_\_\_

PLOTTED BY: \_\_\_\_\_

NOTE BOOK NO. \_\_\_\_\_

FILE NAME: \_\_\_\_\_

DATE	BY

PROFILE

SURVEYED BY: \_\_\_\_\_

PLOTTED BY: \_\_\_\_\_

NOTE BOOK NO. \_\_\_\_\_

FILE NAME: \_\_\_\_\_

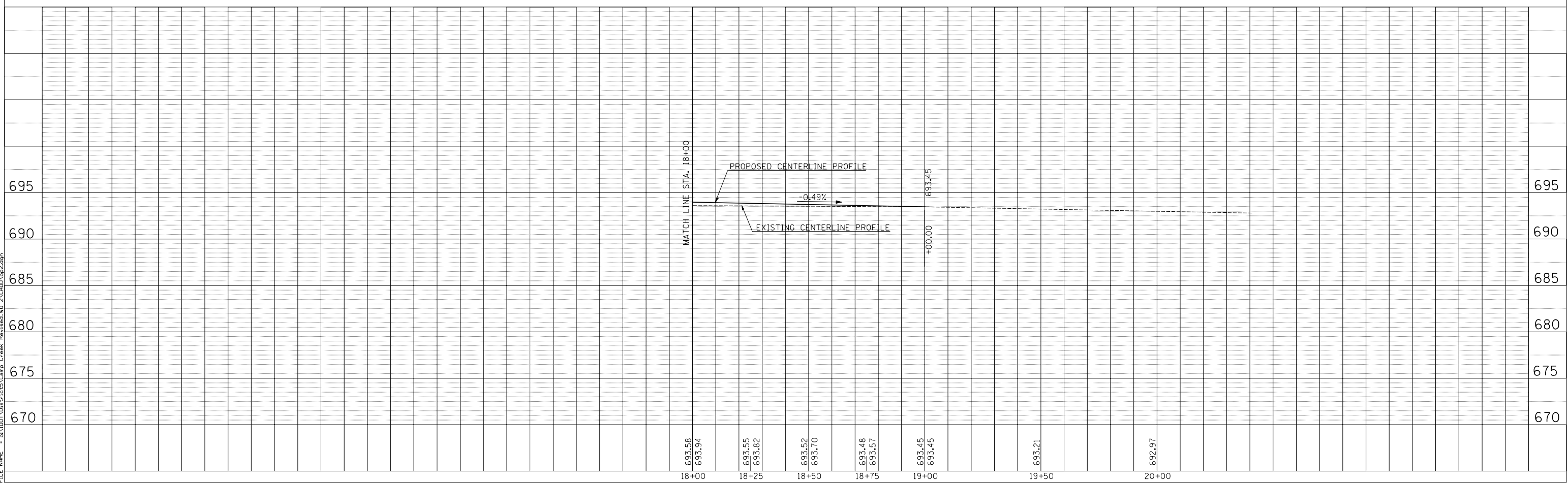

TUG PROJ. # 3106079-02  
 PLOT DATE = 7/19/2007 3:29:23 PM  
 FILE NAME = p:\1001\District15\Camp Creek Revised.MD\_2\CADD\p2.dgn