

F.A.P. RTE.	SECTION	COUNTY	TOTAL SHEETS	SHEET NO.
827	122-3, 12BR	WABASH, IL GIBSON, IN	158	7
STA.		TO STA.		
FED. ROAD DIST. NO.		ILLINOIS FED. AID PROJECT		

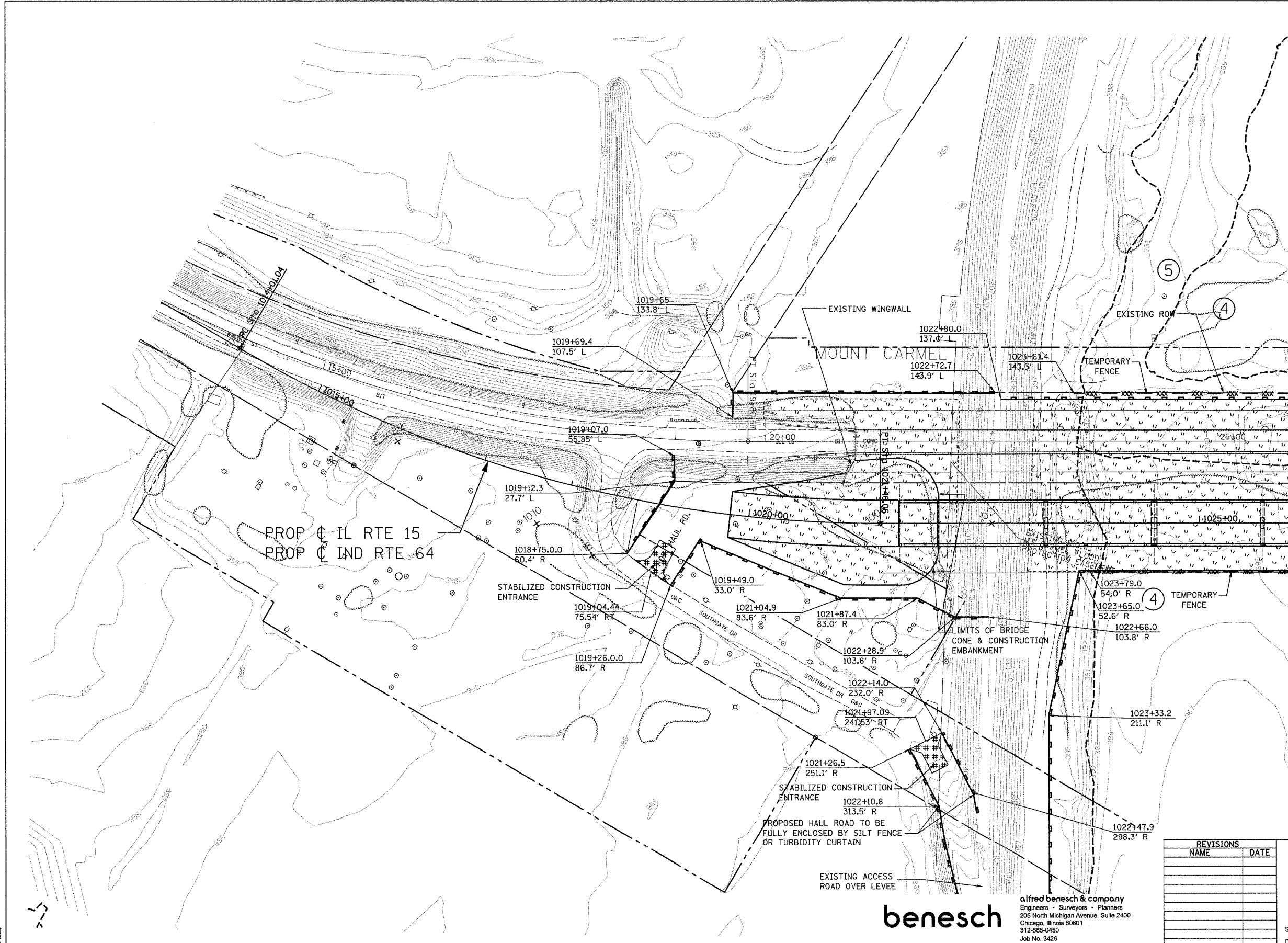
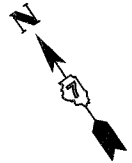

NOTE: PERIMETER EROSION BARRIER TO BE PLACED AS SHOWN OR AS DIRECTED BY THE RESIDENT ENGINEER.

NOTE: TEMPORARY SEEDING TO BE APPROVED BY RESIDENT ENGINEER PRIOR TO INSTALLATION.

- LEGEND:
- PERIMETER EROSION BARRIER
 - TEMPORARY FENCE
 - WETLAND LIMITS
 - EXISTING R.O.W.
 - PERMANENT EASEMENT
 - PROPOSED R.O.W.
 - WETLAND ID
 - TEMPORARY EROSION CONTROL SEEDING
 - TREE REMOVAL

REVISIONS	
NAME	DATE

ILLINOIS DEPARTMENT OF TRANSPORTATION

EROSION CONTROL PLAN

SCALE: VERT. DATE 06/15/07
 HORIZ. DATE 06/15/07
 DRAWN BY MAC
 CHECKED BY RDC

alfred benesch & company
 Engineers • Surveyors • Planners
 205 North Michigan Avenue, Suite 2400
 Chicago, Illinois 60601
 312-565-0450
 Job No. 3426

benesch

SDATES
 SFILES