

CONTRACT NO. 94968				
F.A. RTE.	SECTION	COUNTY	TOTAL SHEETS	SHEET NO.
322	(23-BR-2)BR	FAYETTE	19	7
STA. 195+73.21		TO STA. 197+80.79		
FED. ROAD DIST. NO.	ILLINOIS	FED. AID PROJECT		

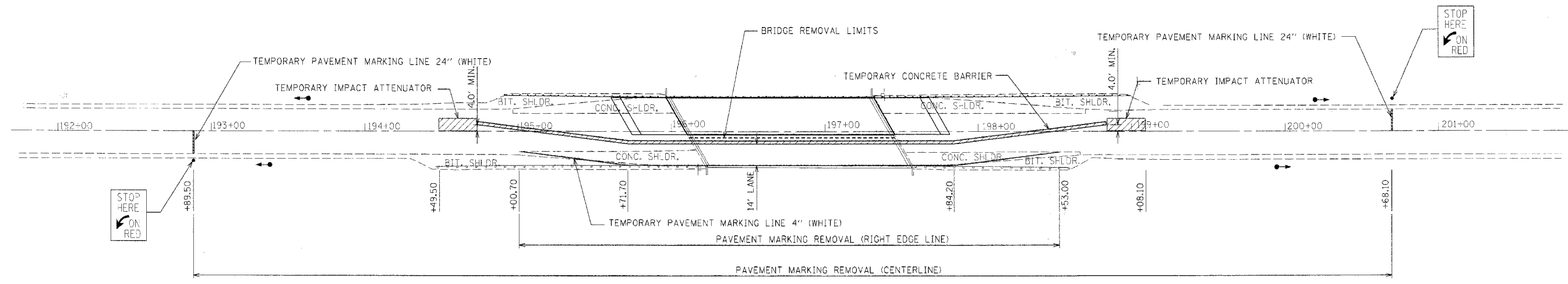

- NOTES:
1. ALL DIMENSIONS, BARRICADES, SIGNS, ETC, AS SHOWN ON TRAFFIC CONTROL AND PROTECTION STANDARD 701321 SHALL APPLY.
 2. ALL TEMPORARY PAVEMENT MARKING NECESSARY TO COMPLY WITH THIS DETAIL SHALL BE CONSIDERED INCLUDED IN THE TRAFFIC CONTROL PAY ITEMS IN THE PLANS.
 3. CONTRACTOR SHALL FILL EXISTING GUARD RAIL POST AFTER REMOVING AND SHALL BE CONSIDERED INCIDENTAL TO STEEL PLATE BEAM GUARD RAIL REMOVAL.

STAGE I TRAFFIC CONTROL
SEE STANDARD 701321

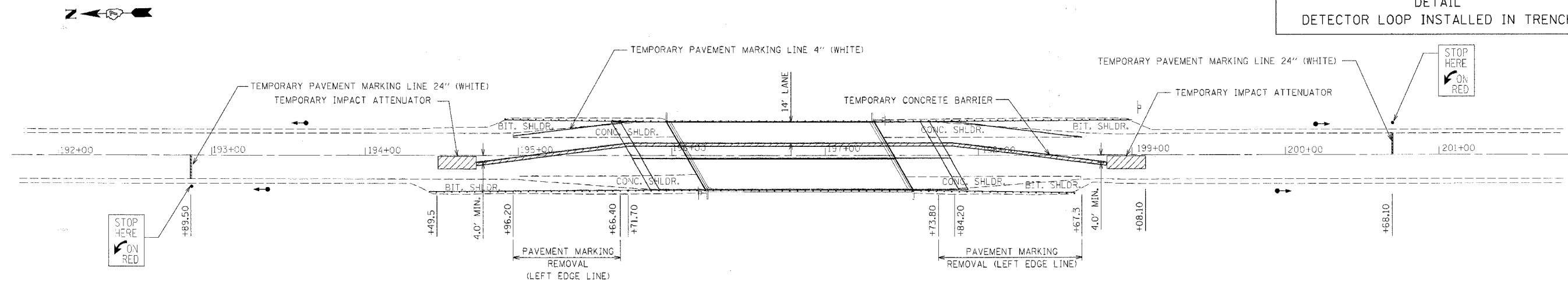
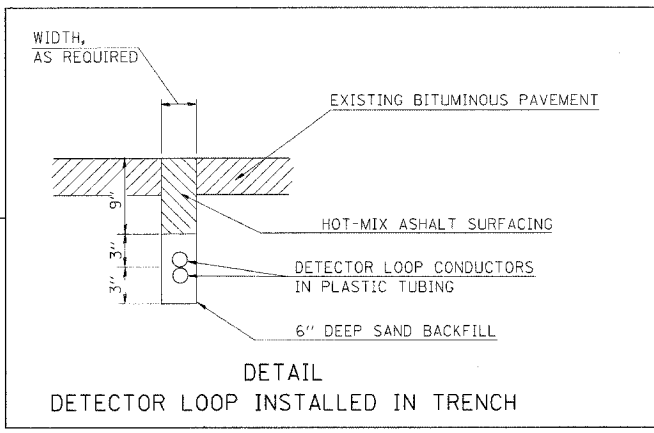

STAGE II TRAFFIC CONTROL
SEE STANDARD 701321

PLOT DATE = 8/23/2007
FILE NAME = P:\066711-2\DOT-Dot7-VenVan-Design\Plans\07-plan-traffic.dwg
PLOT SCALE = 33.30000 ' / IN.
USER NAME = BUSSEK