

F.A.P. RTE.	SECTION	COUNTY	TOTAL SHEETS	SHEET NO.
350	57B-31	COOK	62	14
STA. 20+23.42		TO STA. 28+00.00		
FED. ROAD DIST. NO. 1		ILLINOIS FED. AID PROJECT		

CONTRACT NO. 60440

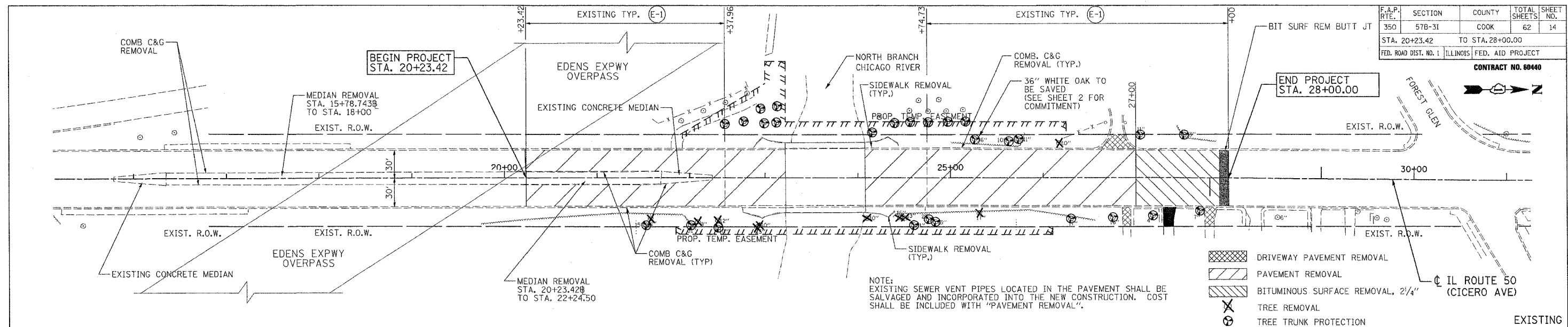

- DRIVEWAY PAVEMENT REMOVAL
- PAVEMENT REMOVAL
- BITUMINOUS SURFACE REMOVAL, 2 1/4"
- TREE REMOVAL
- TREE TRUNK PROTECTION

NOTE: EXISTING SEWER VENT PIPES LOCATED IN THE PAVEMENT SHALL BE SALVAGED AND INCORPORATED INTO THE NEW CONSTRUCTION. COST SHALL BE INCLUDED WITH "PAVEMENT REMOVAL".

- NOTE: 1) REFER TO PLAT OF HIGHWAYS SHEET FOR TEMP. EASEMENT STATION AND OFFSETS.  
 2) SEE DISTRICT ONE DRIVEWAY DETAILS FOR PROPOSED DRIVEWAY PAVEMENT COMPOSITION

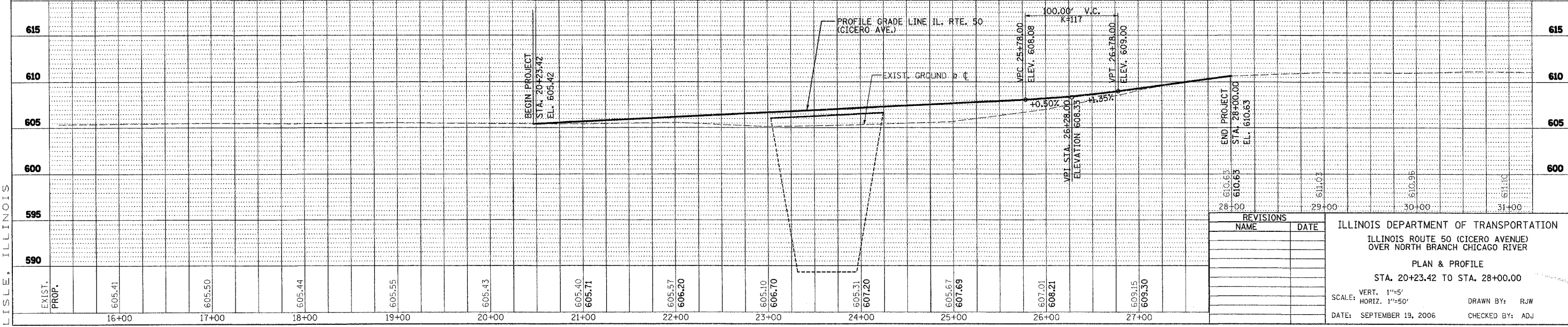
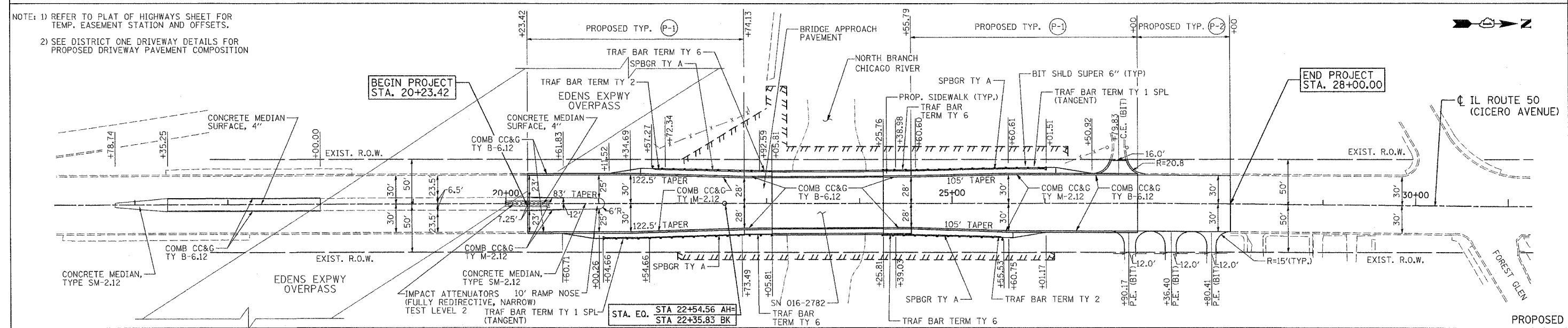

REVISIONS	
NAME	DATE

ILLINOIS DEPARTMENT OF TRANSPORTATION  
 ILLINOIS ROUTE 50 (CICERO AVENUE)  
 OVER NORTH BRANCH CHICAGO RIVER  
 PLAN & PROFILE  
 STA. 20+23.42 TO STA. 28+00.00  
 SCALE: VERT. 1"=5'  
 HORIZ. 1"=50'  
 DATE: SEPTEMBER 19, 2006  
 DRAWN BY: RJW  
 CHECKED BY: ADJ

**PATRICK**  
 ENGINEERING INC.  
 LISLE, ILLINOIS