

CONTRACT NO. 62340

F.A. ROUTE NO.	SECTION	COUNTY	TOTAL SHEETS	SHEET NO.
533	119R-1-B	McHENRY	77	19
STA.		TO STA.		
FED. ROAD DIST. NO. 1	ILLINOIS	FED. AID PROJECT		

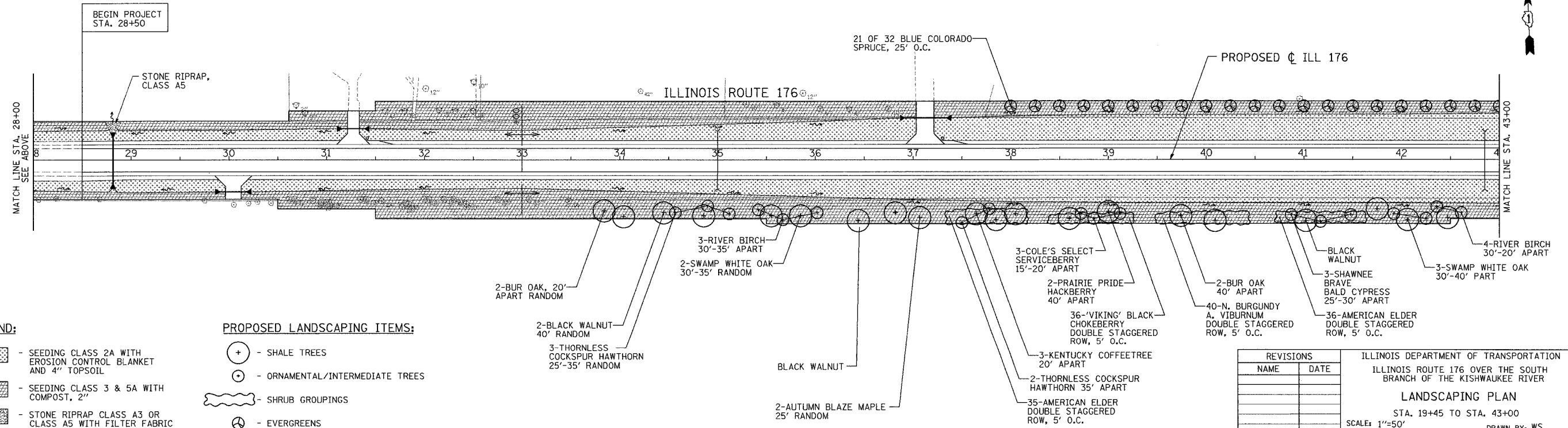
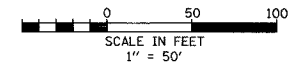
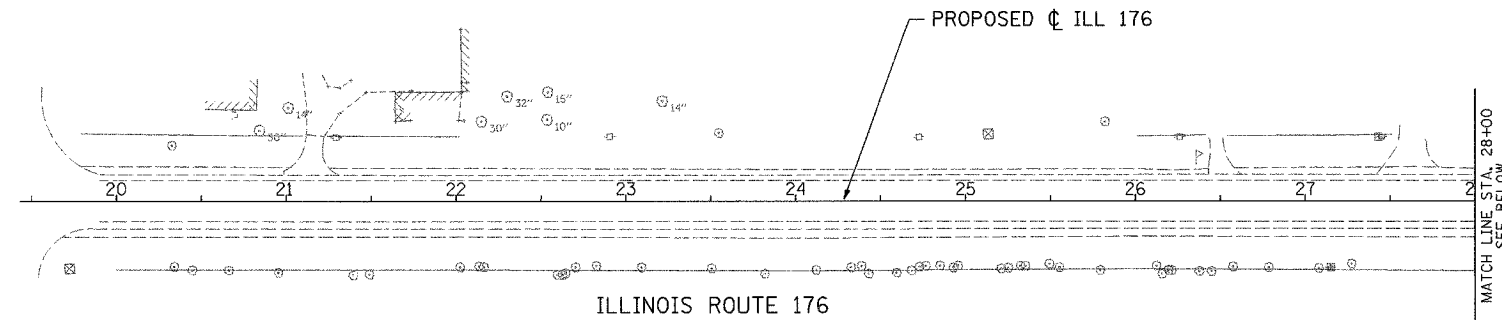

LEGEND:

- SEEDING CLASS 2A WITH EROSION CONTROL BLANKET AND 4" TOPSOIL
- SEEDING CLASS 3 & 5A WITH COMPOST, 2"
- STONE RIPRAP CLASS A3 OR CLASS A5 WITH FILTER FABRIC

PROPOSED LANDSCAPING ITEMS:

- SHALE TREES
- ORNAMENTAL/INTERMEDIATE TREES
- SHRUB GROUPINGS
- EVERGREENS

2-BUR OAK, 20' APART RANDOM

2-BLACK WALNUT 40' RANDOM
3-THORNLESS COCKSPUR HAWTHORN 25'-35' RANDOM

3-RIVER BIRCH 30'-35' APART
2-SWAMP WHITE OAK 30'-35' RANDOM

BLACK WALNUT
2-AUTUMN BLAZE MAPLE 25' RANDOM

21 OF 32 BLUE COLORADO SPRUCE, 25' O.C.

3-COLE'S SELECT SERVICEBERRY 15'-20' APART
2-PRAIRIE PRIDE HACKBERRY 40' APART
36-VIKING' BLACK CHOKEBERRY DOUBLE STAGGERED ROW, 5' O.C.
3-KENTUCKY COFFEETREE 20' APART
2-THORNLESS COCKSPUR HAWTHORN 35' APART
35-AMERICAN ELDER DOUBLE STAGGERED ROW, 5' O.C.

40-N. BURGUNDY A. VIBURNUM DOUBLE STAGGERED ROW, 5' O.C.

BLACK WALNUT
3-SHAWNEE BRAVE BALD CYPRESS 25'-30' APART
36-AMERICAN ELDER DOUBLE STAGGERED ROW, 5' O.C.

4-RIVER BIRCH 30'-20' APART
3-SWAMP WHITE OAK 30'-40' PART

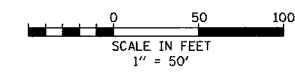

REVISIONS	
NAME	DATE

ILLINOIS DEPARTMENT OF TRANSPORTATION
ILLINOIS ROUTE 176 OVER THE SOUTH BRANCH OF THE KISHWAUKEE RIVER
LANDSCAPING PLAN
STA. 19+45 TO STA. 43+00
SCALE: 1"=50'
DATE: 6-04-07
DRAWN BY: WS
CHECKED BY: RJS

GRAEF, ANHALT, SCHLOEMER & ASSOCIATES, INC.
CHICAGO, ILLINOIS