

F.A.U. RTE.	SECTION	COUNTY	TOTAL SHEETS	SHEET NO.
1253	Y-B-R-2	LAKE	17	2
STA.	TO STA.			
FED. ROAD DIST. NO.	ILLINOIS	FED. AID PROJECT		

CONTRACT: 62768

INDEX OF SHEETS

SHEET NO.	DESCRIPTION
1	COVER SHEET
2	INDEX OF SHEETS, STATE STANDARDS, AND GENERAL NOTES
3	SUMMARY OF QUANTITIES
4-5	TRAFFIC CONTROL STAGING PLANS
Rev. Δ 6-6A	TEMPORARY BRIDGE TRAFFIC SIGNAL PLAN
7	GENERAL ROADWAY PLAN
8	ROADWAY AND PAVEMENT MARKING PLANS
9-15	BRIDGE PLANS (SN 049-0011)
16	TRAFFIC CONTROL AND PROTECTION FOR SIDEROADS, INTERSECTIONS, AND DRIVEWAYS
17	DISTRICT ONE TYPICAL PAVEMENT MARKINGS

STATE STANDARDS

000001-04	STANDARD SYMBOLS, ABBREVIATIONS AND PATTERNS
630001-06	STEEL PLATE BEAM GUARDRAIL
630201-03	PCC/BITUMINOUS STABILIZATION AT STEEL PLATE BEAM GUARDRAIL
631006-03	TRAFFIC BARRIER TERMINAL, TYPE 1B
631031-05	TRAFFIC BARRIER TERMINAL, TYPE 6
701321-05	LANE CLOSURE, 2L, 2-W, BRIDGE REPAIR WITH BARRIER
702001-06	TRAFFIC CONTROL DEVICES
704001-02	TEMPORARY CONCRETE BARRIER

GENERAL NOTES

BEFORE STARTING ANY EXCAVATION, THE CONTRACTOR SHALL CALL "JULIE" AT 800-892-0123 FOR FIELD LOCATIONS OF BURIED ELECTRIC, TELEPHONE AND GAS FACILITIES. (48 HOURS NOTIFICATION REQUIRED).

THE CONTRACTOR WILL NOT BE ALLOWED TO SET UP A YARD OR FIELD OFFICE ON STATE PROPERTY WITHOUT WRITTEN PERMISSION FROM THE DEPARTMENT.

THE RESIDENT ENGINEER SHALL CONTACT DEBBIE HANLON TRAFFIC FIELD ENGINEER, AT (847) 438-2300 A MINIMUM OF 2 WEEKS PRIOR TO PLACEMENT OF PERMANENT PAVEMENT MARKING.

IT SHALL BE THE CONTRACTOR'S RESPONSIBILITY TO VERIFY ALL DIMENSION & CONDITIONS EXISTING IN THE FIELD PRIOR TO CONSTRUCTION & ORDERING OF MATERIALS.

ALL DAMAGE TO EXISTING PAVEMENT MARKINGS OR RAISED REFLECTIVE PAVEMENT MARKERS OUTSIDE THE REMOVAL LINE SHOWN ON THE PLANS SHALL BE REPLACED AT THE CONTRACTOR'S EXPENSE.

BEFORE BEGINNING ANY WORK, THE CONTRACTOR SHALL RETAIN AND RECORD (FOR FUTURE REFERENCES), ALL EXISTING PAVEMENT MARKING LINES (AND RAISED REFLECTIVE PAVEMENT MARKERS) IN ORDER THAT THESE LOCATIONS CAN BE RE-ESTABLISHED FOR STRIPING. EXACT LOCATIONS OF ALL STRIPING SHALL BE AS DIRECTED BY THE ENGINEER.

THE CONTRACTOR SHALL CONTACT THE DISTRICT ONE TRAFFIC CONTROL SUPERVISOR AT (847) 705-4470 FOR ARTERIAL A MINIMUM OF 72 HOURS IN ADVANCE OF BEGINNING WORK.

THE CONTRACTOR SHALL BE REQUIRED TO PROVIDE ACCESS TO ABUTTING PROPERTY AT ALL TIMES DURING THE CONSTRUCTION OF THIS PROJECT.

THE CONTRACTOR SHALL ACCESS THE SITE FOR DEBRIS REMOVAL BY RAISING AND/OR LOWERING ALL EQUIPMENT AND MATERIAL OVER THE SIDE OF THE BRIDGE. THE CONTRACTOR WILL NOT BE ALLOWED OTHER ACCESS WITHOUT WRITTEN PERMISSION FROM THE ENGINEER. THIS WORK WILL BE PAID FOR AT THE CONTRACTOR UNIT PRICE FOR DEBRIS REMOVAL.

THE CONTRACTOR MUST NOTIFY THE TRAFFIC SIGNAL ENGINEER (847-705-4424) AT LEAST ONE WEEK PRIOR TO IMPLEMENTING THE PROPOSED ONE-WAY DETOUR.

PLOT DATE = 10/31/2006
FILE NAME = c:\projects\123404\design\as.dgn
PLOT SCALE = 50.0001 / IN.
REFERENCE = SHEET

REV Δ 10.31.06

REVISIONS	
NAME	DATE

ILLINOIS DEPARTMENT OF TRANSPORTATION
HALF DAY RD. OVER E. BRANCH SKOKIE DITCH
SN 049-0011

INDEX OF SHEETS
LIST OF STATE STANDARDS
GENERAL NOTES

SCALE: VERT. _____
HORIZ. _____

DATE _____ DRAWN BY _____
CHECKED BY _____

SUMMARY OF QUANTITIES			CONSTRUCTION TYPE CODE				
CODE NO	ITEM	UNIT	URBAN TOTAL QUANTITIES	XOB1-2A STATE 100%			
44001700	COMBINATION CONCRETE CURB AND GUTTER REMOVAL AND REPLACEMENT	FOOT	20	20			
50101500	REMOVAL OF EXISTING SUPERSTRUCTURES	EACH	1	1			
50102400	CONCRETE REMOVAL	CU YD	0.5	0.5			
50300225	CONCRETE STRUCTURES	CU YD	0.5	0.5			
50300255	CONCRETE SUPERSTRUCTURE	CU YD	47	47			
50300260	BRIDGE DECK GROOVING	SQ YD	384	384			
50300300	PROTECTIVE COAT	SQ YD	566	566			
50400405	PRECAST PRESTRESSED CONCRETE DECK BEAMS (21" DEPTH)	SQ FT	4476	4476			
50800205	REINFORCEMENT BARS, EPOXY COATED	POUND	12030	12030			
50900105	ALUMINUM RAILING, TYPE L	FOOT	170	170			
51500100	NAME PLATES	EACH	1	1			
60300305	FRAMES AND LIDS TO BE ADJUSTED	EACH	1	1			
* 63000000	STEEL PLATE BEAM GUARD RAIL, TYPE A	FOOT	25	25			
* 63100085	TRAFFIC BARRIER TERMINAL, TYPE 6	EACH	2	2			
63200310	GUARDRAIL REMOVAL	FOOT	127	127			
67000400	ENGINEER'S FIELD OFFICE, TYPE A	CAL MO	1	1			
67100100	MOBILIZATION	L SUM	1	1			
70100405	TRAFFIC CONTROL AND PROTECTION, STANDARD T01321	EACH	1	1			
70102550	TRAFFIC CONTROL AND PROTECTION FOR TEMPORARY DETOUR	EACH	1	1			
70103815	TRAFFIC CONTROL SURVEILLANCE	CAL DA	1	1			
70300500	PAVEMENT MARKING TAPE, TYPE III	FOOT	2100	2100			
70400500	TEMPORARY CONCRETE BARRIER (STATE OWNED)	FOOT	190	190			
* 78000100	THERMOPLASTIC PAVEMENT MARKING - LETTERS AND SYMBOLS	SQ FT	36.4	36.4			
* 78000200	THERMOPLASTIC PAVEMENT MARKING - LINE 4"	FOOT	1900	1900			
* 78000400	THERMOPLASTIC PAVEMENT MARKING - LINE 6"	FOOT	160	160			

SUMMARY OF QUANTITIES			CONSTRUCTION TYPE CODE				
CODE NO	ITEM	UNIT	URBAN TOTAL QUANTITIES	XOB1-2A STATE 100%			
* 78000600	THERMOPLASTIC PAVEMENT MARKING - LINE 12"	FOOT	110	110			
* 78008210	POLYUREA PAVEMENT MARKING TYPE I - LINE 4"	FOOT	356	356			
* 78008250	POLYUREA PAVEMENT MARKING TYPE I - LINE 12"	FOOT	30	30			
* 78100105	RAISED REFLECTIVE PAVEMENT MARKER (BRIDGE)	EACH	4	4			
78300105	PAVEMENT MARKING REMOVAL	FOOT	3270	3270			
X5030305	CONCRETE WEARING SURFACE, 5"	SQ YD	521	521			
XX001306	SIDEWALK REMOVAL AND REPLACEMENT	SQ FT	560	560			
* XX006128	TRAFFIC BARRIER TERMINAL TYPE 1 (SPECIAL)	EACH	2	2			
Z0002600	BAR SPLICERS	EACH	91	91			
Z0005215	BITUMINOUS STABILIZATION 6" AT STEEL PLATE BEAM GUARD RAIL	SQ YD	17	17			
Z0015550	DEBRIS REMOVAL	CU YD	30	30			
* Z0030240	IMPACT ATTENUATORS, TEMPORARY (NON-REDIRECTIVE), TEST LEVEL 2	EACH	2	2			
70101800	TRAFFIC CONTROL AND PROTECTION (SPECIAL)	L SUM	1	1			
70300520	PAVEMENT MARKING TAPE, TYPE III, 4"	FOOT	640	640			
70300570	PAVEMENT MARKING TAPE, TYPE III, 24"	FOOT	36	36			
70400100	TEMPORARY CONCRETE BARRIER	FOOT	110	110			
70400200	RELOCATE TEMPORARY CONCRETE BARRIER	FOOT	110	110			
89000100	TEMPORARY TRAFFIC SIGNAL INSTALLATION	EACH	1	1			

* SPECIALTY ITEMS
 ■ SFTY-3N
 ▲ Rev. 10-23-06
 ▲ Rev. 11-2-06

REVISIONS	
NAME	DATE

ILLINOIS DEPARTMENT OF TRANSPORTATION
 SUMMARY OF QUANTITIES





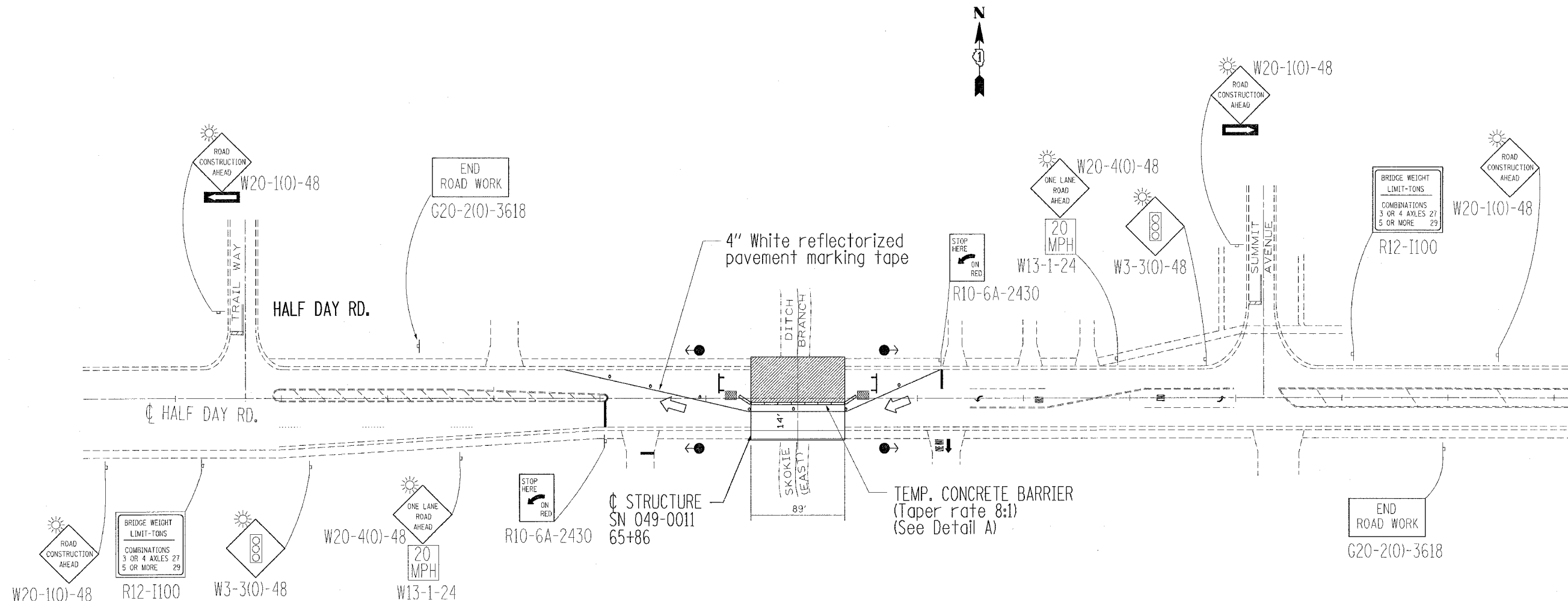

8/30/2006 11:51:12 AM C:\Users\jcs\Documents\62768.dgn

F.A.U. RTE.	SECTION	COUNTY	TOTAL SHEETS	SHEET NO.
1253	Y-B-R-2	LAKE	17	4
STA.	TO STA.			
FED. ROAD DIST. NO.	ILLINOIS	FED. AID PROJECT		

CONTRACT NO. 62768

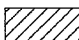

SYMBOLS

-  Sign
-  Barricade or drum with steady burning light
-  Type III barricade with flashing yellow lights
-  Impact attenuator
-  Work Area
-  TRAFFIC SIGNAL

Notes

All existing pavement markings in conflict with construction traffic control shall be covered with black Type III pavement marking

Barricade, barrel and panel spacing shall be 25' centers in taper sections and 50' centers in tangent sections.

Vertical panels shall be used when barrels cannot be placed on the existing pavement or paved shoulder.

Traffic control details shown on this sheet shall be included in the contract lump sum price for "Traffic Control & Protection (Special)"

Final location for the signs should be determined by the engineer on the field.

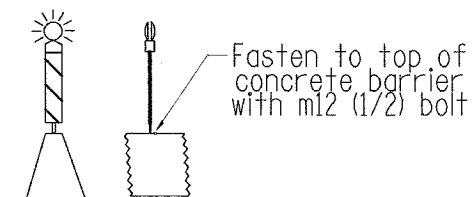

DETAIL A

(Suggested Mounting Detail)

REV Δ 10.31.06

REVISIONS	
NAME	DATE

ILLINOIS DEPARTMENT OF TRANSPORTATION
 TRAFFIC STAGING PLANS - STAGE I
 HALF DAY RD OVER
 E. BRANCH SKOKIE DITCH
 SN 049-0011

SCALE: NO SCALE
 DATE: 10/31/2006





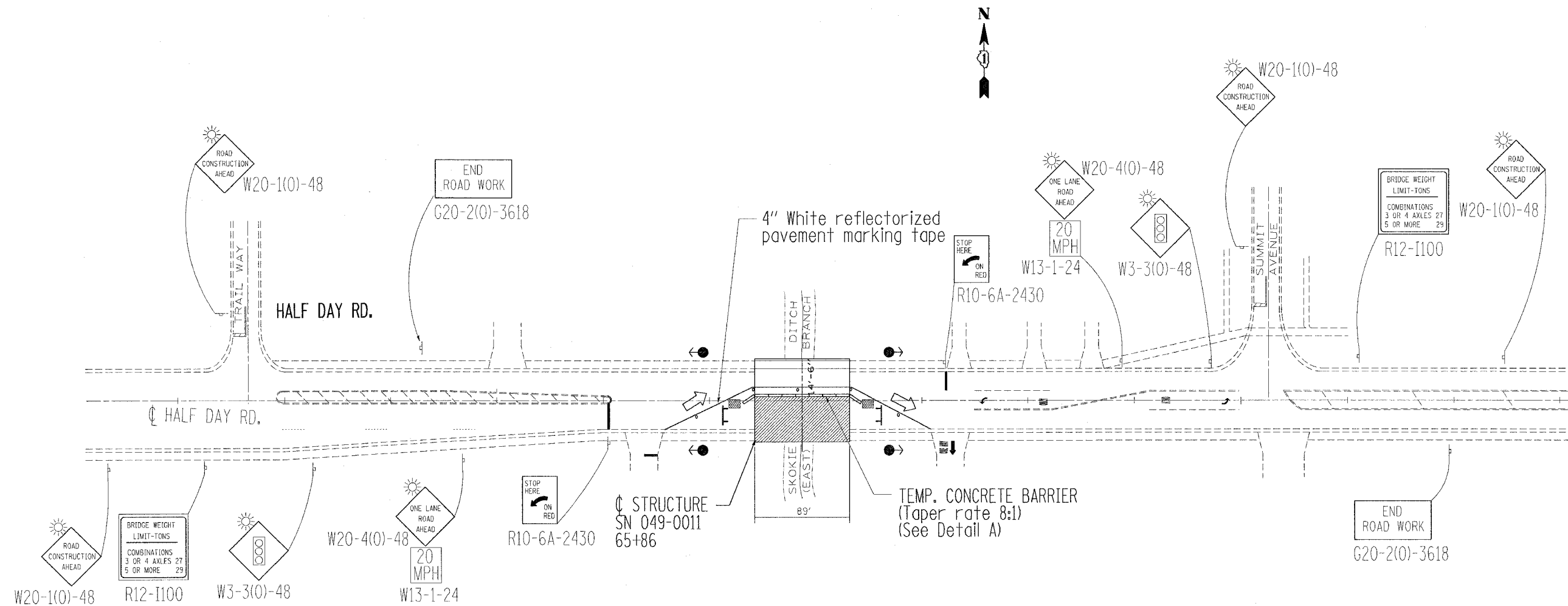

DRAWN BY
 CHECKED BY

F.A.U. RTE.	SECTION	COUNTY	TOTAL SHEETS	SHEET NO.
1253	Y-B-R-2	LAKE	17	5
STA.		TO STA.		
FED. ROAD DIST. NO.	ILLINOIS	FED. AID PROJECT		

CONTRACT NO. 62768

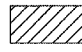

SYMBOLS

-  Sign
-  Barricade or drum with steady burning light
-  Type III barricade with flashing yellow lights
-  Impact attenuator
-  Work Area
-  TRAFFIC SIGNAL

Notes

All existing pavement markings in conflict with construction traffic control shall be covered with black Type III pavement marking

Barricade, barrel and panel spacing shall be 25' centers in taper sections and 50' centers in tangent sections.

Vertical panels shall be used when barrels cannot be placed on the existing pavement or paved shoulder.

Traffic control details shown on this sheet shall be included in the contract lump sum price for "Traffic Control & Protection (Special)"

Final location for the signs should be determined by the engineer on the field.

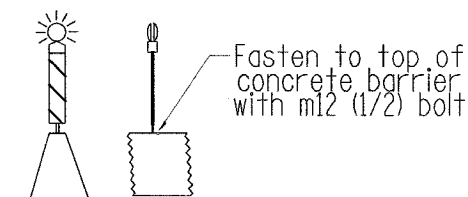

DETAIL A

(Suggested Mounting Detail)

REV Δ 10.31.06

REVISIONS	
NAME	DATE

ILLINOIS DEPARTMENT OF TRANSPORTATION
 TRAFFIC STAGING PLANS - STAGE II
 HALF DAY RD OVER
 E. BRANCH SKOKIE DITCH
 SN 049-0011

SCALE: NO SCALE
 DATE: 10/31/2006

DRAWN BY
 CHECKED BY

F.A.U. RTE.	SECTION	COUNTY	TOTAL SHEETS	SHEET NO.
1253	Y-B-R-2	LAKE	17	6
STA.	TO STA.			
FED. ROAD DIST. NO.	ILLINOIS	FED. AID PROJECT		

CONTRACT NO. 62768

TEMPORARY TRAFFIC SIGNAL AND REMOVAL LEGEND

TEMPORARY CONTROLLER CABINET			HANDHOLE		
TEMPORARY SERVICE INSTALLATION, (P) POLE OR (G) GROUND MOUNT			HEAVY-DUTY HANDHOLE		
TEMPORARY TRAFFIC SIGNAL HEAD SPAN WIRE MOUNTED ORIGINAL LOCATION			G.S. CONDUIT IN TRENCH OR PUSHED		
TEMPORARY TRAFFIC SIGNAL HEAD SPAN WIRE MOUNTED SECONDARY LOCATION			TEMPORARY SPAN WIRE, TETHER WIRE, AND CABLE		
TEMPORARY PEDESTRIAN SIGNAL HEAD, BRACKET MOUNTED			COMMON TRENCH	CT	
TEMPORARY WOOD POLE (CLASS 5 OR BETTER) 45 FOOT (13.7m) MINIMUM			UNIT DUCT	UD	
EXISTING SIGNAL POST AND FOUNDATION TO BE REMOVED			TEMPORARY PEDESTRIAN PUSHBUTTON DETECTOR		
STEEL MAST ARM ASSEMBLY AND POLE			DETECTOR LOOP, TYPE I		
ALUMINUM MAST ARM ASSEMBLY AND POLE			PREFORMED DETECTOR LOOP		
COMBINATION MAST ARM ASSEMBLY AND POLE, STEEL WITH LUMINAIRE			MICROWAVE VEHICLE SENSOR		
EXISTING STREET LIGHT, FOUNDATION AND LUMINAIRE TO REMAIN			VIDEO DETECTOR		
TRANSFORMER			CLOSED CIRCUIT TV		
			EMERGENCY VEHICLE SYSTEM DETECTOR		
			CONFIRMATION BEACON		
			REMOVAL		
			RELOCATE		

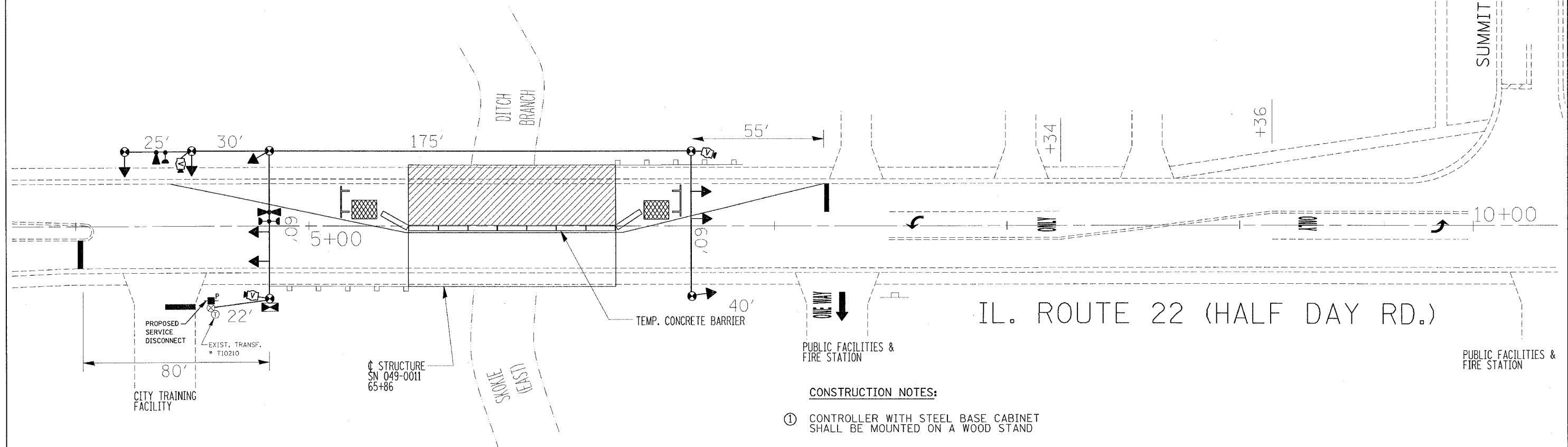

CONSTRUCTION NOTES:

- ① CONTROLLER WITH STEEL BASE CABINET SHALL BE MOUNTED ON A WOOD STAND
- ② STAGING SHOWN ON THE PLAN SHOULD USE AS A GUIDE ONLY. THE EXACT STAGING MUST BE COORDINATED WITH THE BUREAU OF MAINTENANCE
- ③ THE SPEED LIMIT WILL BE 20MPH
- ④ THE SIGNS (W13-1 (24")) FOR SPEED LIMIT SHALL BE INCLUDED IN WITH TRAFFIC CONTROL STANDARD 701321-08.

REV. A 10.31.06

REVISIONS	
NAME	DATE

ILLINOIS DEPARTMENT OF TRANSPORTATION

TEMPORARY BRIDGE TRAFFIC SIGNAL PLAN

ILL. ROUTE 22
OVER E. BRANCH SKOKIE DITCH
SN: 049-0011

SCALE: VERT. / HORIZ.
DATE 10/31/2006

DRAWN BY: SN
DESIGNED BY: SN
CHECKED BY: DAD

PLOT DATE = 10/31/2006
 FILE NAME = c:\projects\123456\design.dgn
 PLOT SCALE = 280000 / IN.
 USER NAME = hndmsh

F.A.U. RTE. 1253	SECTION Y-B-R-2	COUNTY LAKE	TOTAL SHEETS 17	SHEET NO. 6A
STA. TO STA.		FED. ROAD DIST. NO. 1 ILLINOIS FED. AID PROJECT		
CONTRACT NO. 62768				

TEMPORARY SEQUENCE OF OPERATION

MOVEMENT	IL. RTE 22 →		IL. RTE 22 ↑		IL. RTE 22 ←		F L		S H
PHASE	1		2		3		A		
INTERVAL	1	2A	2B	3	4A	4B	5	6A	6B
CHANGE TO	1, 2		2		1, 3		R		R
ILL. RTE. 22 SIGNAL (E/B)	G	Y	R	R	R	R	R	R	R
TRAINING FACILITY	R	R	R	G	Y	R	R	R	R
ILL. RTE. 22 SIGNAL (W/B)	R	R	R	R	R	R	G	Y	R

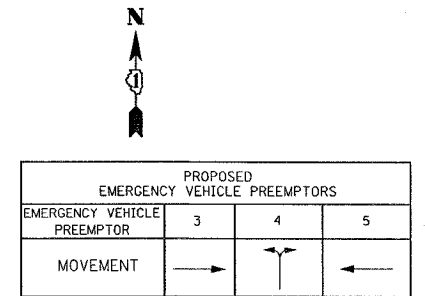
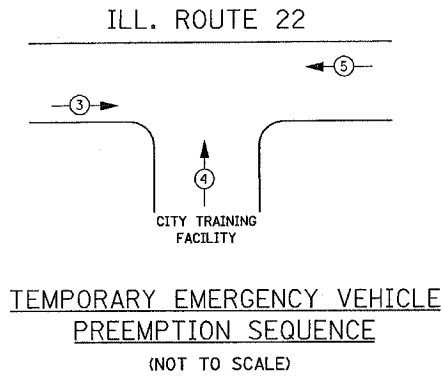
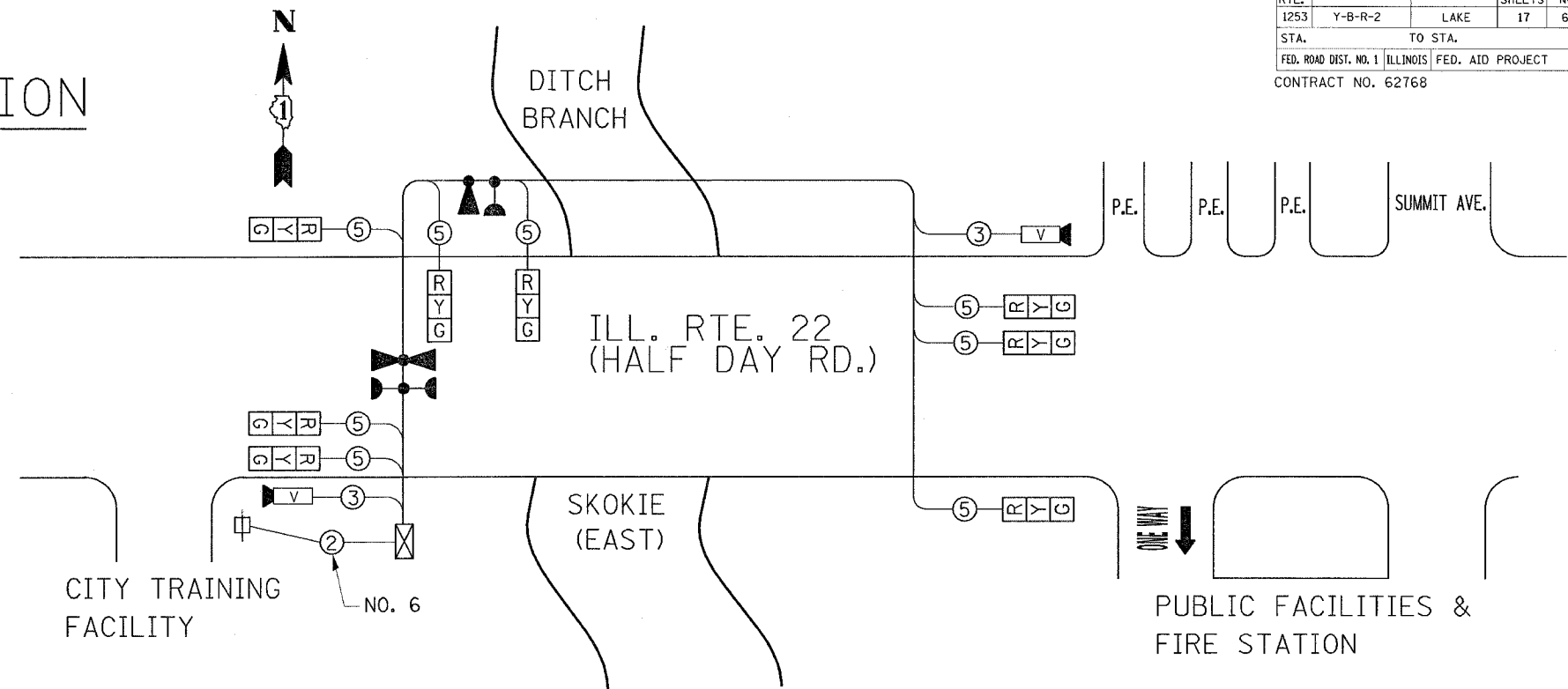

- CONSTRUCTION NOTES:**
- CONTROLLER WITH STEEL BASE CABINET SHALL BE MOUNTED ON A WOOD STAND
 - STAGING SHOWN ON THE PLAN SHOULD USE AS A GUIDE ONLY. THE EXACT STAGING MUST BE COORDINATED WITH THE BUREAU OF MAINTENANCE
 - THE SPEED LIMIT WILL BE 20MPH
 - THE SIGNS (W13-1 (24")) FOR SPEED LIMIT SHALL BE INCLUDED IN WITH TRAFFIC CONTROL STANDARD 701321-08.

- TEMPORARY CABLE DIAGRAM LEGEND**
- R** TEMPORARY TRAFFIC SIGNAL SECTION OR PEDESTRIAN SIGNAL SECTION 12" (300 mm)
 - ⊠** TEMPORARY CONTROLLER CABINET
 - ⊞** TEMPORARY SERVICE INSTALLATION
 - ⑤** INDICATES NUMBER OF CONDUCTORS IN CABLE. ALL CONDUCTORS TO BE NUMBER 14 AWG WIRE UNLESS OTHERWISE NOTED.
 - ⬆** EMERGENCY VEHICLE LIGHT DETECTOR
 - ⬆** CONFIRMATION BEACON
 - ⊙** PEDESTRIAN PUSHBUTTON DETECTOR
 - VEHICLE DETECTOR, INDUCTION LOOP
 - ⊞** 12" (300mm) PEDESTRIAN SIGNAL SECTION
 - M** MICROWAVE VEHICLE SENSOR
 - V** VIDEO DETECTOR SENSOR
 - C** CLOSED CIRCUIT TV
 - BB** BATTERY - BACK UP
 - T** TELEPHONE CONNECTION

EMC SUMMARY OF QUANTITIES

ITEM	DESCRIPTION	UNIT	QUANTITY
89000100	TEMPORARY TRAFFIC SIGNAL INSTALLATION	EACH	1

I.D.O.T. TRAFFIC SIGNAL INSTALLATION ELECTRICAL SERVICE REQUIREMENTS

TYPE	NO. LAMPS	WATTAGE	X% OPERATION	TOTAL WATTAGE	
		INCAND. LED			
SIGNAL (RED)	8	135	17	0.50	540.0
(YELLOW)	8	135	25	0.25	270.0
(GREEN)	8	135	15	0.25	270.0
ARROW		135	12	0.10	
PED. SIGNAL		90	25	1.00	
CONTROLLER	1	100	100	1.00	100.0
ILLUM. SIGN		84		0.05	
FLASHER				0.50	
TOTAL =				1180.0	

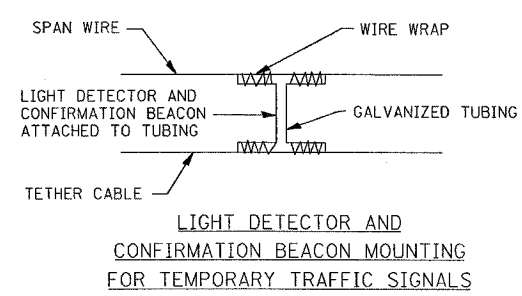

FOUNDATION (DEPTH)	(FT.) (m)	CABLE SLACK	(FT.) (m)	VERTICAL	(FT.) (m)
TYPE A - POST	4 (1.2)	HANDHOLE	6.5 (2.0)	ALL FOUNDATIONS	3.5 (1.0)
D - CONTROLLER	4 (1.2)	DOUBLE HANDHOLE	13 (4.0)	MAST ARM (L) POLE	20' + L - 2 = (6m+L-0.6m)=
E - M. ARM POLE		SIGNAL POST	2 (1.0)		
24" (600mm)	10 (3.0)	CONTROLLER CAB.	1 (0.5)	BRACKET MOUNTED	13 (4.0)
30" (750mm)	15 (4.6)	FIBER OPTIC	13 (4.0)	PED. PUSHBUTTON	4 (1.2)
		ELECTRIC SERVICE	1 (0.5)	ELECTRIC SERVICE	13.5 (4.1)
		GROUND CABLE	1 (0.5)	SERVICE TO GROUND	13.5 (4.1)
				POST MOUNTED	6 (1.8)

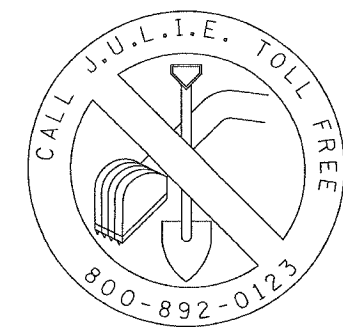

REV 10.31.06

REVISIONS	NAME	DATE

ILLINOIS DEPARTMENT OF TRANSPORTATION
TEMPORARY BRIDGE CABLE PLAN AND
TEMPORARY PHASE DESIGNATION DIAGRAM
**ILL. ROUTE 22 OVER
E. BRANCH SKOKIE DITCH**

SCALE: VERT. N.T.S.
HORIZ. DATE 10/31/2006

DRAWN BY: SN
DESIGNED BY: DC
CHECKED BY: DAD

F.A.U. RTE.	SECTION	COUNTY	TOTAL SHEETS	SHEET NO.
1753	Y-B-R-2	LAKE	17	8
STA.	TO STA.			
FED. ROAD DIST. NO.	ILLINOIS FED. AID PROJECT			
CONTRACT NO. 62768				

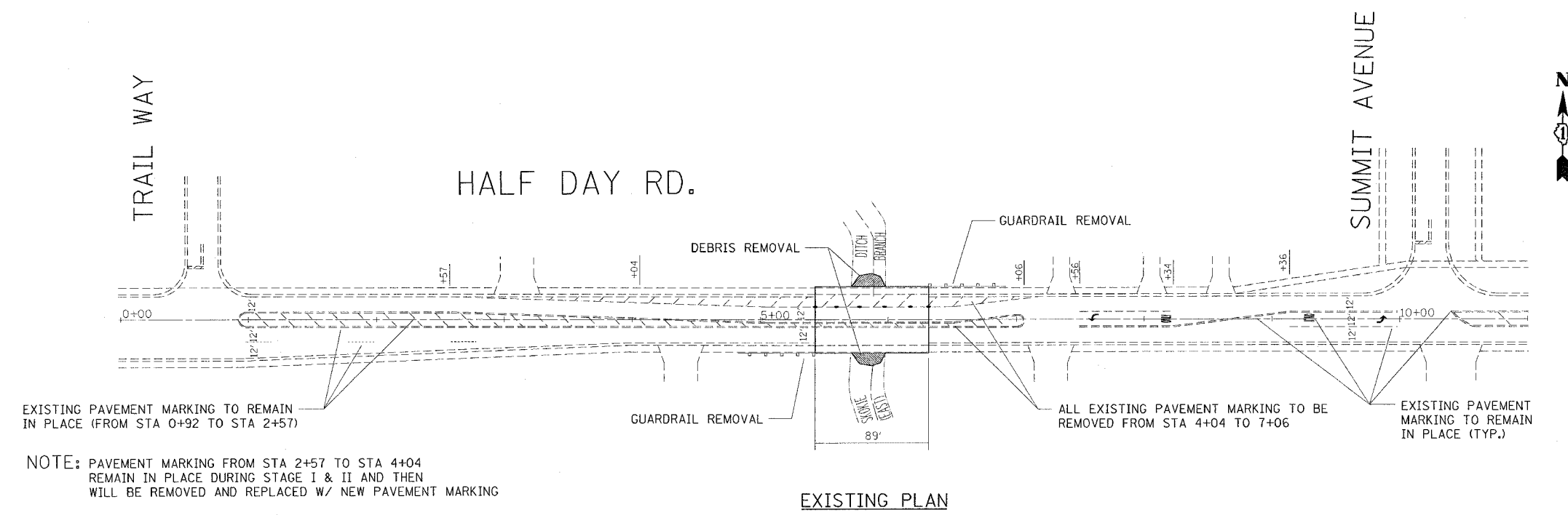

EXISTING PLAN

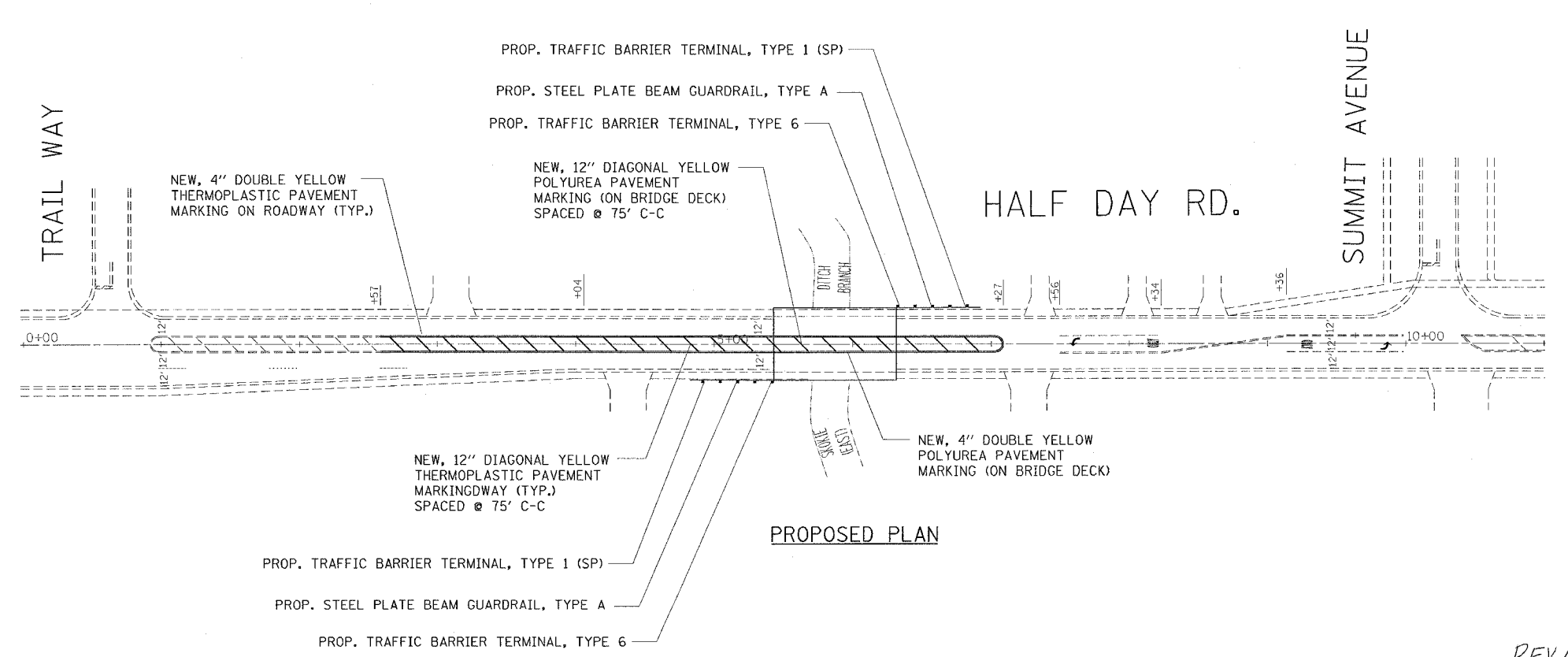

PROPOSED PLAN

REV 10.31.06

REVISIONS	
NAME	DATE

ILLINOIS DEPARTMENT OF TRANSPORTATION
 EXISTING AND PROPOSED ROADWAY
 AND PAVEMENT MARKING PLANS
 HALF DAY RD. OVER E. BRANCH
 SKOKIE DITCH
 SN 049-0011
 SCALE: NO SCALE
 DATE: 10/31/2006
 DRAWN BY
 CHECKED BY

PLOT DATE = 10/31/2006
 FILE NAME = c:\projects\1022484\design\as.dgn
 PLOT SCALE = 50.0001 / IN.
 USER NAME = handanah