

STATE OF ILLINOIS
DEPARTMENT OF TRANSPORTATION

SHEET #4 OF 11 SHEETS				
ROUTE NO.	SECTION	COUNTY	SHEET NO.	SHEET
FAS 203	11BR-1	WHITESIDE	43	15
FED. ROAD DIST. NO. 3	ILLINOIS	FED. AID PROJECT-		

CONTRACT #64939

* Order a(E) bars full length
Cut to fit skew and use
remainder in opposite end
(See Bar Cutting Diagram)

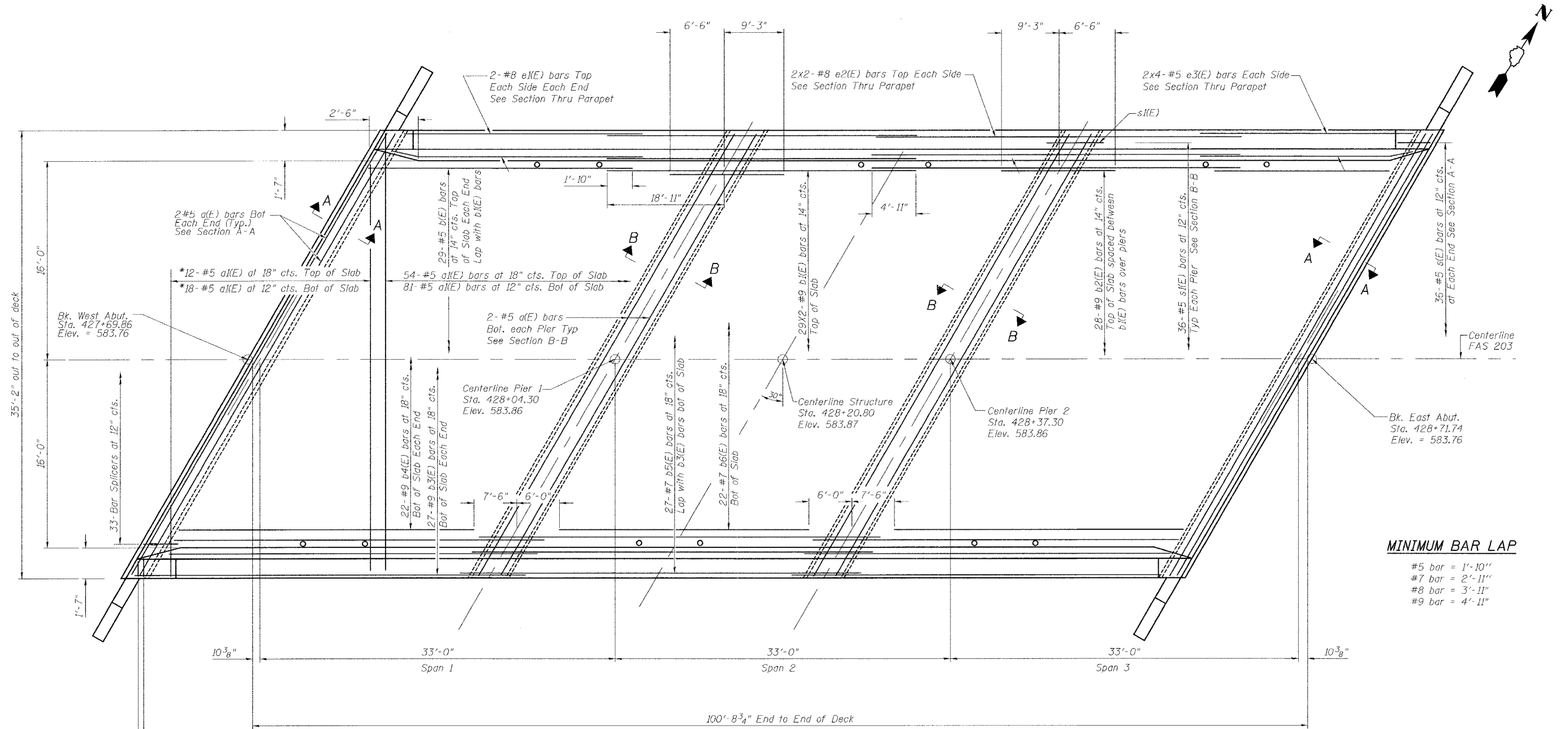

MINIMUM BAR LAP

#5 bar	= 1'-10"
#7 bar	= 2'-11"
#8 bar	= 3'-11"
#9 bar	= 4'-11"

111- #5 d(E) bars at 11" cts. Inside Face Each Side
102- #4 d(E) bars at 12" cts. Outside Face Each Side

102- #4 s2(E) bars at 12" cts. Each Side
See Section Thru Parapet

PLAN

NOTES

1. See sheets No. 5 and 6 of 11 for Superstructure Details, parapet reinforcing, and Bill of Materials.
2. Reinforcing bars designated (E) shall be epoxy coated.
3. Bars indicated thus 6x3- #5 etc. indicates 6 lines of bars with 3 lengths per line.
4. See sheet No.1 of 11 for floor drain spacing.
5. Space reinforcement bars to clear floor drain.

DESIGNED	KCM
CHECKED	TMM
DRAWN	JLM
CHECKED	TMM

SUPERSTRUCTURE PLAN
FAS ROUTE 203 (MOLINE ROAD)
OVER MEREDOSIA DITCH
SECTION 11BR-1
STA. 428+20.80
WHITESIDE COUNTY
SN 098-0111