

F.A.I. RTE.	SECTION	COUNTY	TOTAL SHEETS	SHEET NO.
39	150-4B/BR	LASALLE	365	14
STA.		TO STA.		
FED. ROAD DIST. NO.		ILLINOIS	FED. AID PROJECT	

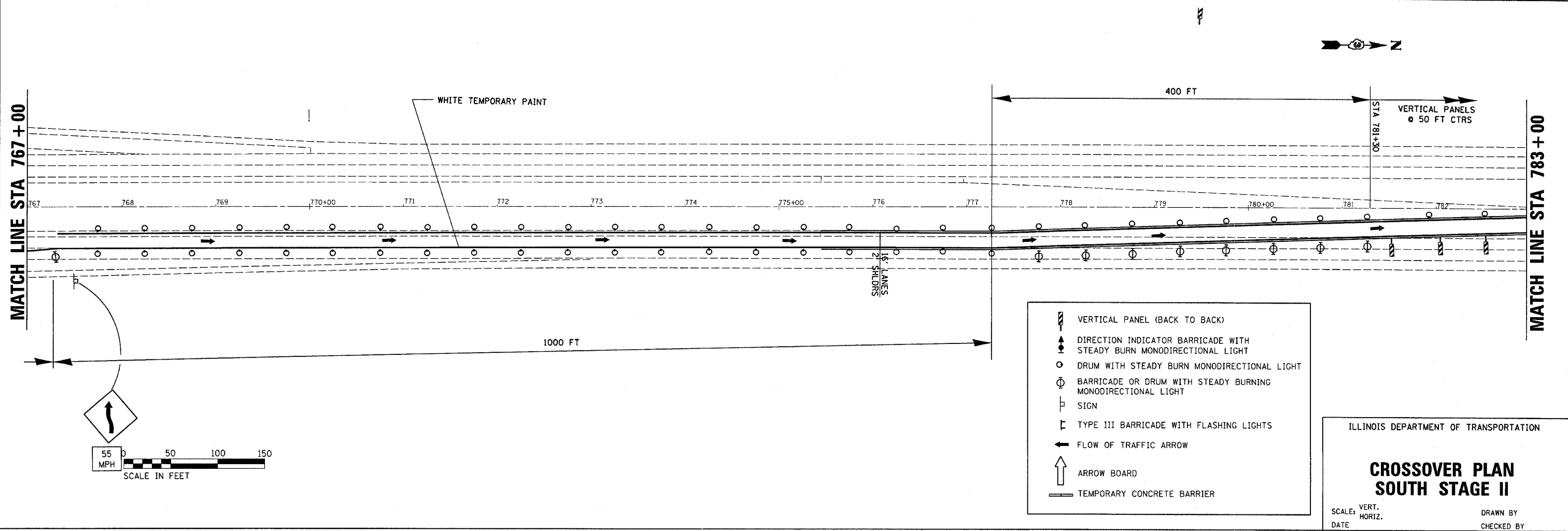

- VERTICAL PANEL (BACK TO BACK)
- DIRECTION INDICATOR BARRICADE WITH STEADY BURN MONODIRECTIONAL LIGHT
- DRUM WITH STEADY BURN MONODIRECTIONAL LIGHT
- BARRICADE OR DRUM WITH STEADY BURNING MONODIRECTIONAL LIGHT
- SIGN
- TYPE III BARRICADE WITH FLASHING LIGHTS
- FLOW OF TRAFFIC ARROW
- ARROW BOARD
- TEMPORARY CONCRETE BARRIER

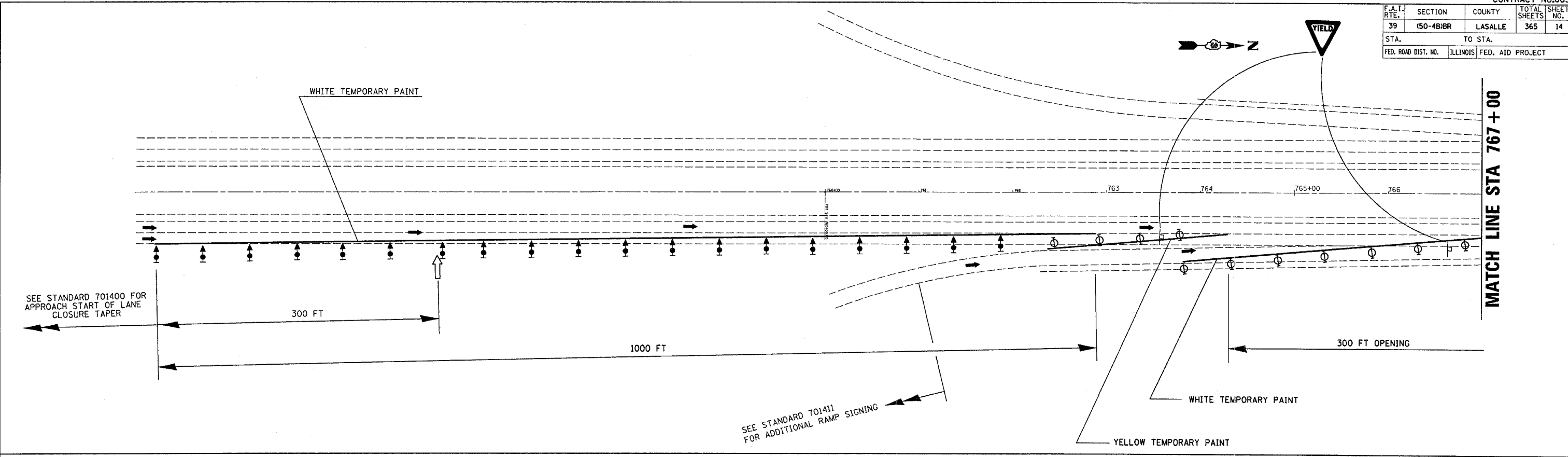
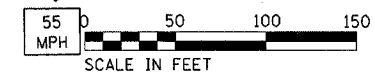

PLOT DATE = 10/20/2006  
 FILE NAME = 150-4B/BR  
 PLOT SCALE = 1"=50'  
 USER NAME = \*USER\*

ILLINOIS DEPARTMENT OF TRANSPORTATION

### CROSSOVER PLAN SOUTH STAGE II

SCALE: VERT. \_\_\_\_\_  
 HORIZ. \_\_\_\_\_

DATE \_\_\_\_\_ DRAWN BY \_\_\_\_\_  
 CHECKED BY \_\_\_\_\_