

Bench Mark: Square cut on parapet of S.E. wingwall of NB F.A.I. 39.
Elev. 564.90

STATE OF ILLINOIS
DEPARTMENT OF TRANSPORTATION

ROUTE NO.	SECTION	COUNTY	TOTAL SHEETS	SHEET NO.
F.A.I. 39	50-4B	LASALLE	25	3
FED. ROAD DIST. NO. 7		ILLINOIS FED. AID PROJECT-		313 SHEETS

Contract # 66586

Existing Structures: No. 050-0191 Dual Structure (NB & SB). Built as F.A. Rte. 412, Sec. 50-4B in 1985. The dual structure consists of 34 spans in the south approach, one span over the Illinois River and 9 spans in the north approach. The Superstructure of the south and north approaches consists of R.C. deck supported on steel welded plate girders. The main 620'-6" span over the Illinois River is a steel Tied Arch supporting the R.C. decks on stringers and floor beams. The abutments are cantilever type and the piers are hammer-head type supported on pile foundations. One lane of traffic in each direction shall be maintained, during the rehabilitation of both structures, by stage construction.

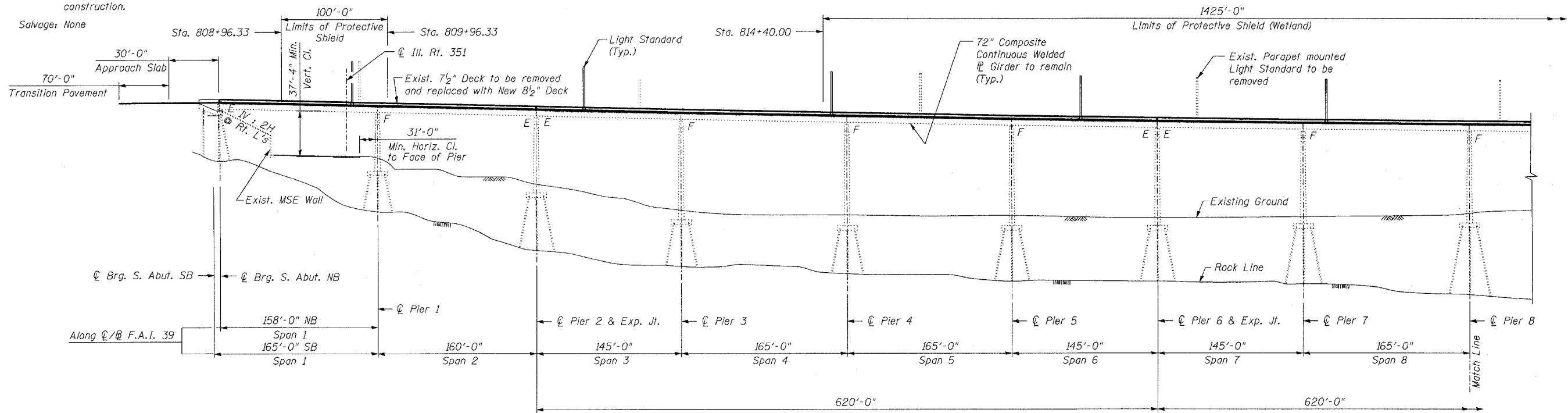

PART ELEVATION

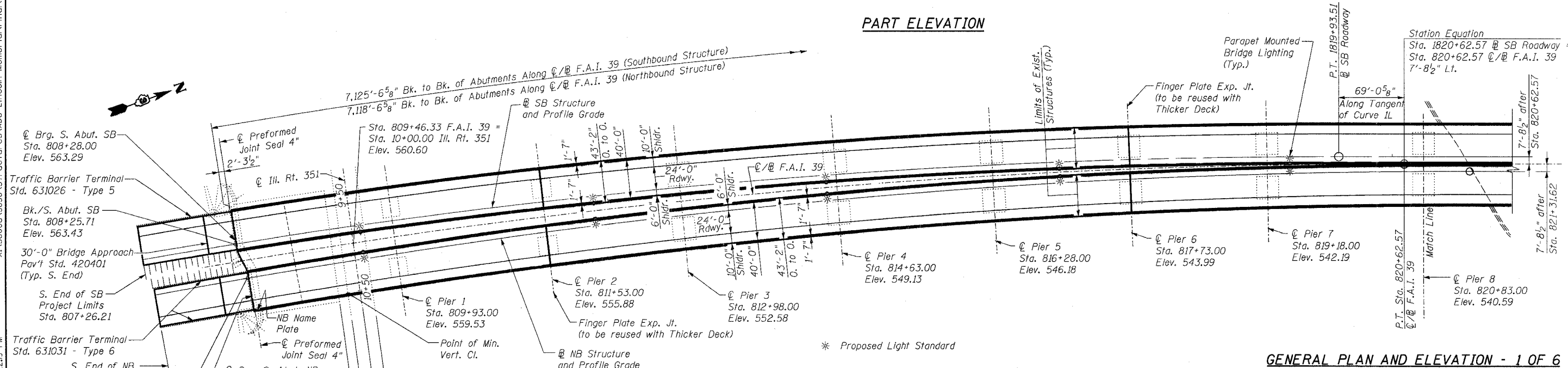

PART PLAN

- NOTES:
1. Stations along C/B F.A.I. 39
 2. Dimensions of existing elements to remain are taken from the existing plans.
 3. All substructure units placed radially or at 90° with respect to C/B F.A.I. 39 unless noted otherwise.

APPROVED
FOR STRUCTURAL ADEQUACY ONLY

ENGINEER OF BRIDGES AND STRUCTURES

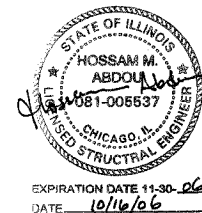

benesch

alfred benesch & company
Engineers • Surveyors • Planners
205 North Michigan Avenue, Suite 2400
Chicago, Illinois 60601
312-565-0450
Job # 3856

GENERAL PLAN AND ELEVATION - 1 OF 6
ABRAHAM LINCOLN MEMORIAL BRIDGE OVER
THE ILLINOIS RIVER (PUBLIC WATERS)
F.A.I. ROUTE 39 SEC. (50-4B) BR
LASALLE COUNTY
STATION 863+16.00
STRUCTURE NO. 050-0191 (SB & NB)

10/16/2006 4:22:49 PM x:\3800s\3856\Structures\abe\lincoln\final\plans\al_gpe01.sht