

STATE OF ILLINOIS
DEPARTMENT OF TRANSPORTATION

ROUTE NO.	SECTION	COUNTY	TOTAL SHEETS	SHEET NO.	SHEET NO.
F.A.I. 39	50-4B	LASALLE	29	29	313 SHEETS
FED. ROAD DIST. NO. 7	ILLINOIS	FED. AID PROJECT	Contract # 66586		

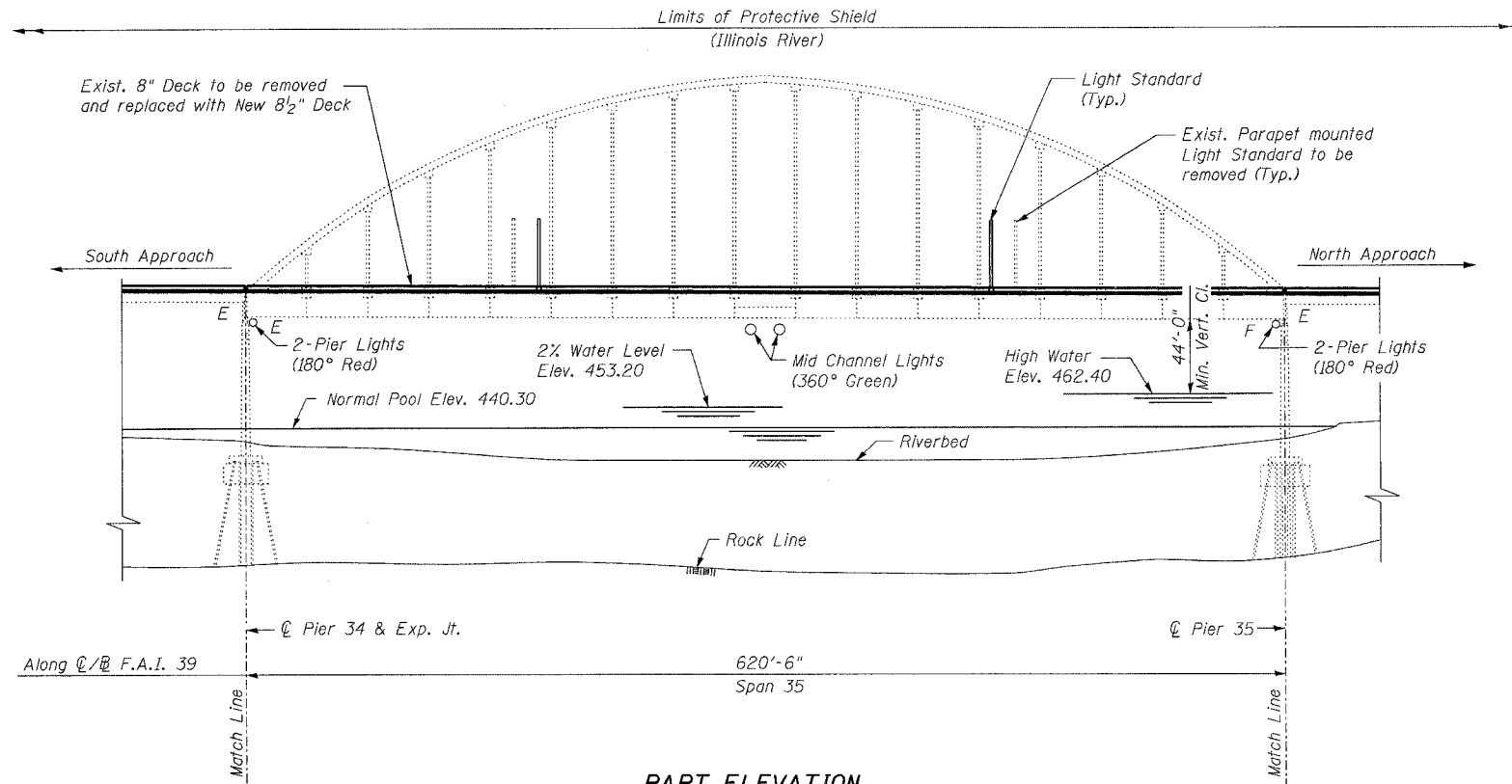

PART ELEVATION

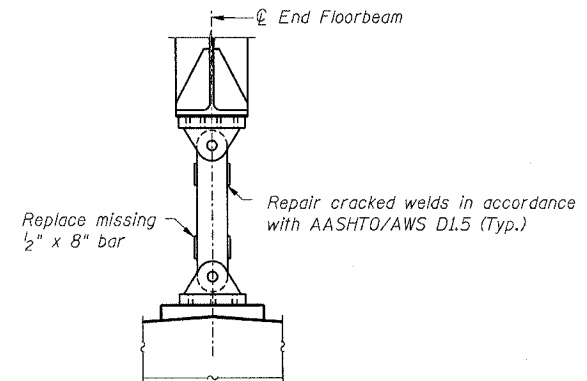

WEST LIVE LOAD SUPPORTS AT PIER 35
(Cost included with Furnishing and Erecting Structural Steel)

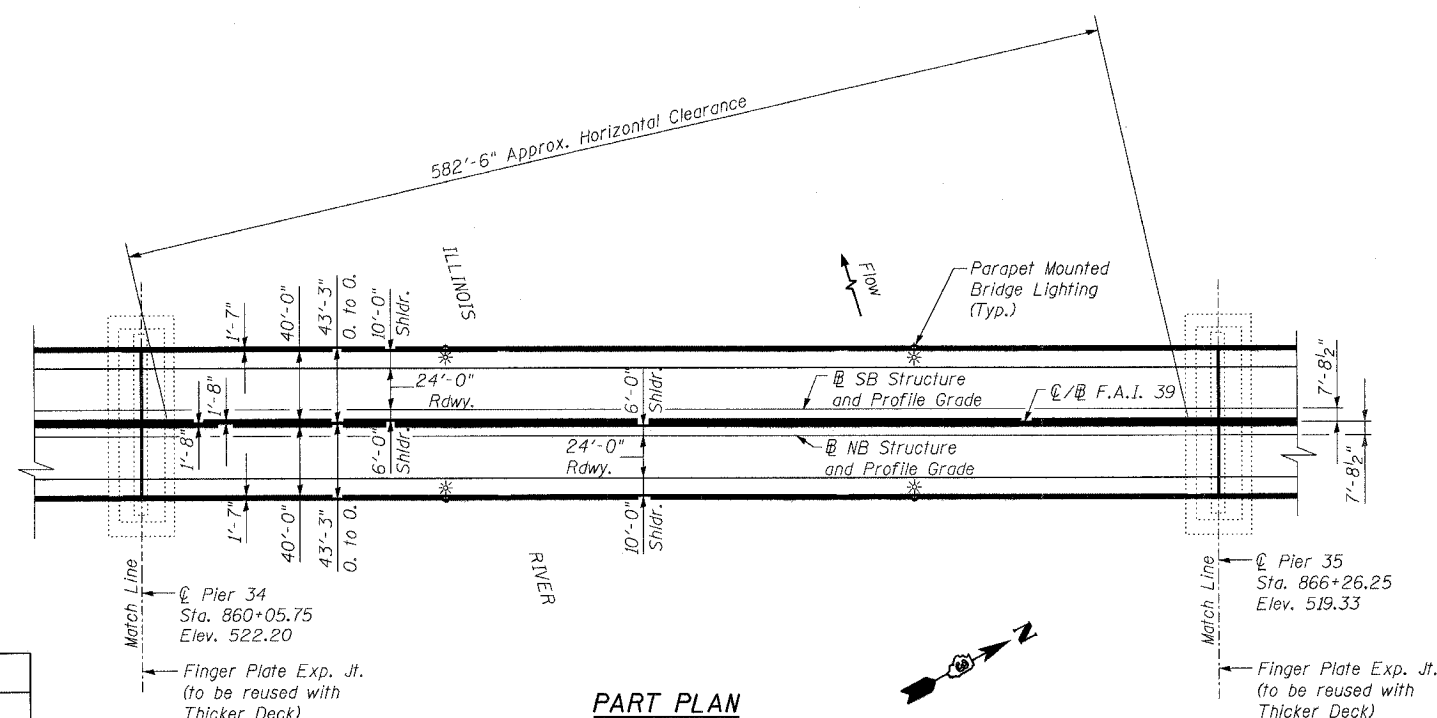

PART PLAN

WATERWAY INFORMATION

Drainage Area = 8,259 sq. mi. Low Grade Elev. High Level Bridge at Sta. 863+16.00

Flood	Freq. Yr.	Q C.F.S.	Opening Sq. Ft.		Nat. H.W.E.	Head - Ft.		Headwater Elev.	
			Exist.	Prop.		Exist.	Prop.	Exist.	Prop.
Design	50	86,000	—	70,580*	463.4	—	—	—	463.4
Base	100	92,300	—	77,180*	464.9	—	—	—	464.9
Overtopping									
Max. Calc.	500								

* Gross waterway opening (Includes Piers)

NOTES:
1. For Notes, see sheet 3.

GENERAL PLAN AND ELEVATION - 5 OF 6
ABRAHAM LINCOLN MEMORIAL BRIDGE OVER
THE ILLINOIS RIVER (PUBLIC WATERS)
F.A.I. ROUTE 39 SEC. (50-4B) BR
LASALLE COUNTY
STATION 863+16.00
STRUCTURE NO. 050-0191 (SB & NB)

benesch
alfred benesch & company
Engineers • Surveyors • Planners
205 North Michigan Avenue, Suite 2400
Chicago, Illinois 60601
312-565-0450
Job # 3856

DESIGNED -	MRB
CHECKED -	HMA
DRAWN -	VH
CHECKED -	MRB

x:\3800s\3856\structures\abe lincoln memorial\final\plans\AL_gpe05.sht 3:01:35 PM 10/16/2006