

STATE OF ILLINOIS  
DEPARTMENT OF TRANSPORTATION

ROUTE NO.	SECTION	COUNTY	DATE	SHEET	SHEET NO. 103 313 SHEETS
F.A.I. 39	50-4B	LASALLE		125	
FED. ROAD DIST. NO. 7		ILLINOIS		FED. AID PROJECT	

Contract # 66586

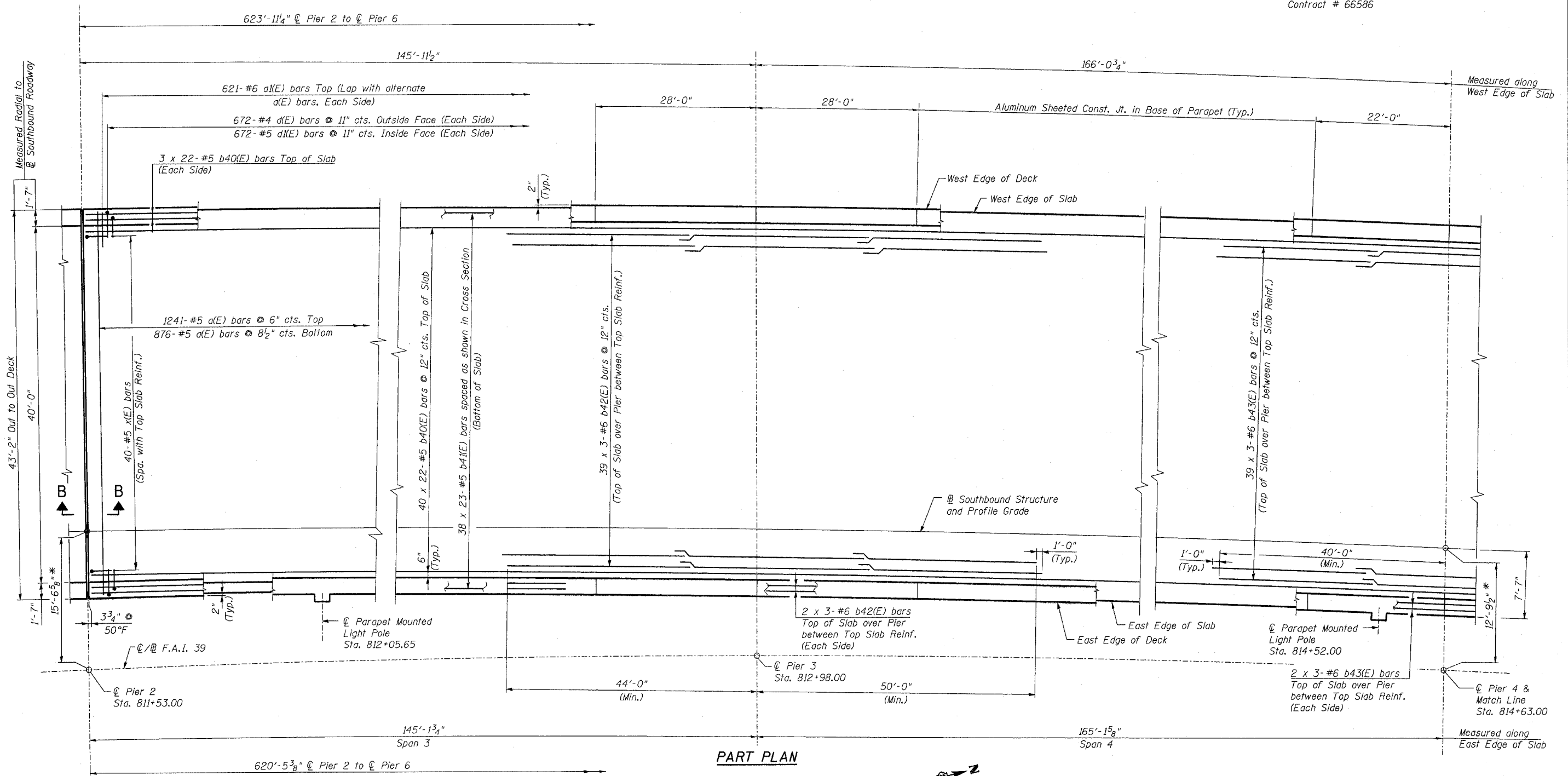

PART PLAN

\* Measured Radial to  
F.A.I. 39

NOTES:

1. For Deck Cross Section see sheet 162.
2. For Bill of Material and Reinforcement Schedule see sheet 109.
3. For Deck Details and Section B-B see sheets 166 thru 169.
4. Reinforcement bars designated (E) shall be epoxy coated.
5. Bars indicated thus 20x3-#5 etc. indicates 20 lines of bars with 3 lengths per line.
6. Floor Drains and Scuppers not shown. For locations, see sheets 175 and 176.
7. For Scupper Details see sheets 177 and 178.
8. For additional deck reinforcement at Scupper locations see sheet 166.
9. For additional deck reinforcement at Parapet Mounted Light Pole locations see sheet 169.
10. Work this sheet with sheet 104.

MINIMUM BAR LAP  
(Slab)

- #5 bar = 2'-2"
- #6 bar = 2'-7"

DESIGNED -	HAA
CHECKED -	MRB
DRAWN -	VH
CHECKED -	KWS

**benesch**

alfred benesch & company  
Engineers • Surveyors • Planners  
205 North Michigan Avenue, Suite 2400  
Chicago, Illinois 60601  
312-965-0450  
Job # 3856

DECK PLAN - SPANS 3 THRU 6 SB  
ABRAHAM LINCOLN MEMORIAL BRIDGE OVER  
THE ILLINOIS RIVER (PUBLIC WATERS)  
F.A.I. ROUTE 39 SEC. (50-4B) BR  
LASALLE COUNTY  
STATION 863+16.00  
STRUCTURE NO. 050-0191 (SB & NB)

x:\3800s\3856\structures\abe lincoln memorial\final\plans\al-dkpl03.sht

8/30/2006 9:01:37 AM