

STATE OF ILLINOIS  
DEPARTMENT OF TRANSPORTATION

ROUTE NO.	SECTION	COUNTY	SHEET NO.	SHEET NO.
F.A.I. 39	50-4B	LASALLE	147	125
FED. ROAD DIST. NO. 7	ILLINOIS	FED. AID PROJECT		313 SHEETS

Contract # 66586

**BILL OF MATERIAL**  
(Southbound Deck)

Bar	No.	Size	Length	Shape
a(E)	1519	#5	42'-6"	—
a1(E)	890	#6	4'-6"	—
a2(E)	8	#5	2'-0"	—
a3(E)	6	#6	5'-0"	—
a4(E)	8	#6	2'-6"	—
a5(E)	5	#6	8'-0"	—
b3(E)	4	#5	2'-3"	—
b160(E)	736	#5	30'-0"	—
b161(E)	646	#5	28'-3"	—
b162(E)	129	#6	37'-6"	—
b163(E)	129	#6	27'-6"	—
d(E)	486	#4	3'-4"	┌
d1(E)	972	#5	2'-5"	└
d2(E)	486	#4	3'-5"	┌
d8(E)	5	#5	5'-5"	└
d98(E)	585	#5	3'-8"	└
d99(E)	420	#5	3'-6"	└
x(E)	80	#5	4'-1"	└
Item	Unit	Total		
Reinforcement Bars, Epoxy Coated	Pound	136,950		
Concrete Superstructure	Cu. Yd.	532.3		
Bridge Deck Grooving	Sq. Yd.	1,876		
Protective Coat	Sq. Yd.	1,975		

**BILL OF MATERIAL**  
(Southbound Parapets)

Bar	No.	Size	Length	Shape
d3(E)	972	#4	3'-0"	┌
d4(E)	975	#5	3'-0"	┌
d6(E)	5	#6	8'-11"	└
e10(E)	3	#4	2'-3"	—
e11(E)	1	#8	2'-3"	—
e12(E)	1	#5	2'-3"	—
e14(E)	4	#5	6'-0"	—
e160(E)	216	#4	19'-0"	—
e161(E)	20	#8	30'-9"	—
e162(E)	20	#5	28'-9"	—
e163(E)	48	#4	14'-9"	—
e164(E)	8	#8	29'-9"	—
e165(E)	8	#5	29'-9"	—
e166(E)	16	#8	32'-3"	—
e167(E)	16	#5	30'-6"	—
e168(E)	24	#4	19'-9"	—
e169(E)	8	#8	19'-9"	—
e170(E)	8	#5	19'-9"	—
e171(E)	16	#8	27'-6"	—
e172(E)	16	#5	26'-0"	—
Item	Unit	Total		
Reinforcement Bars, Epoxy Coated	Pound	15,810		
Concrete Superstructure	Cu. Yd.	106.3		
Protective Coat	Sq. Yd.	387		

**BILL OF MATERIAL**  
(Northbound Deck)

Bar	No.	Size	Length	Shape
a(E)	1519	#5	42'-6"	—
a1(E)	890	#6	4'-6"	—
a2(E)	8	#5	2'-0"	—
a3(E)	6	#6	5'-0"	—
a4(E)	8	#6	2'-6"	—
b3(E)	4	#5	2'-3"	—
b160(E)	736	#5	30'-0"	—
b161(E)	646	#5	28'-3"	—
b162(E)	129	#6	37'-6"	—
b163(E)	129	#6	27'-6"	—
d(E)	486	#4	3'-4"	┌
d1(E)	971	#5	2'-5"	└
d2(E)	485	#4	3'-5"	┌
d98(E)	585	#5	3'-8"	└
d99(E)	420	#5	3'-6"	└
x(E)	80	#5	4'-1"	└
Item	Unit	Total		
Reinforcement Bars, Epoxy Coated	Pound	136,860		
Concrete Superstructure	Cu. Yd.	532.1		
Bridge Deck Grooving	Sq. Yd.	1,876		
Protective Coat	Sq. Yd.	1,975		

**BILL OF MATERIAL**  
(Northbound Parapets)

Bar	No.	Size	Length	Shape
d3(E)	971	#4	3'-0"	┌
d4(E)	971	#5	3'-0"	┌
e14(E)	4	#5	6'-0"	—
e160(E)	216	#4	19'-0"	—
e161(E)	20	#8	30'-9"	—
e162(E)	20	#5	28'-9"	—
e163(E)	48	#4	14'-9"	—
e164(E)	8	#8	29'-9"	—
e165(E)	8	#5	29'-9"	—
e166(E)	16	#8	32'-3"	—
e167(E)	16	#5	30'-6"	—
e168(E)	24	#4	19'-9"	—
e169(E)	8	#8	19'-9"	—
e170(E)	8	#5	19'-9"	—
e171(E)	16	#8	27'-6"	—
e172(E)	16	#5	26'-0"	—
Item	Unit	Total		
Reinforcement Bars, Epoxy Coated	Pound	15,750		
Concrete Superstructure	Cu. Yd.	105.6		
Protective Coat	Sq. Yd.	387		

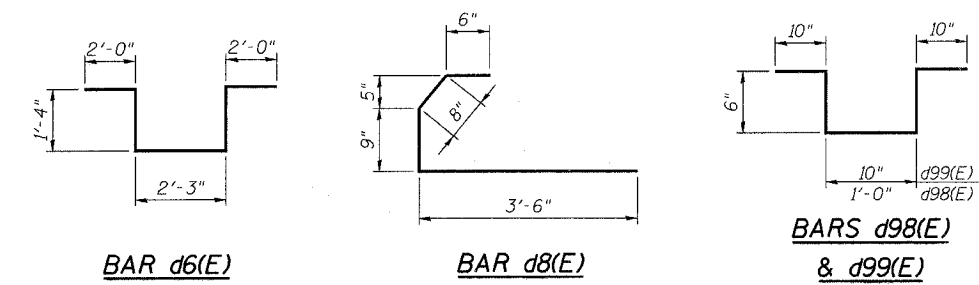
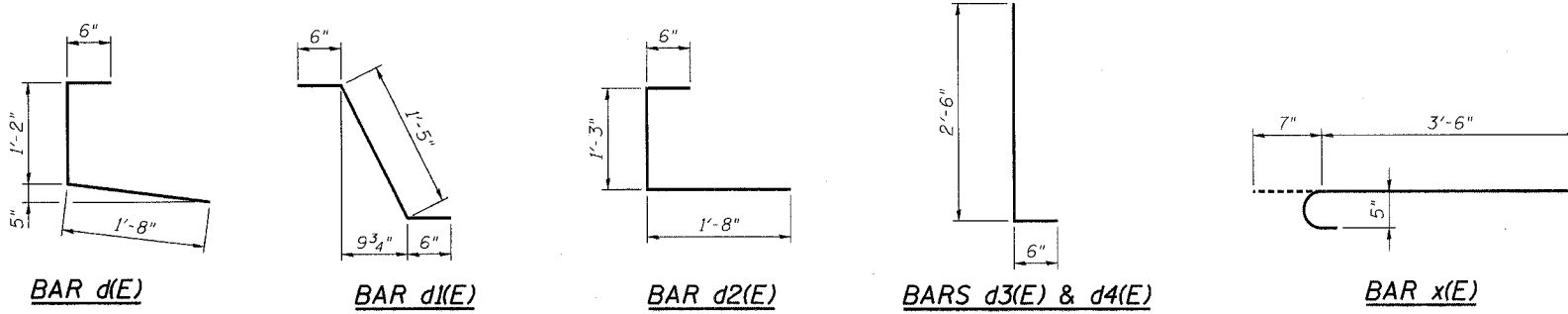

**NOTES:**  
1. Reinforcement bars designated (E) shall be epoxy coated.  
2. All bar dimensions are out to out.

**BILL OF MATERIAL - SPANS 15 THRU 17  
ABRAHAM LINCOLN MEMORIAL BRIDGE OVER  
THE ILLINOIS RIVER (PUBLIC WATERS)  
F.A.I. ROUTE 39 SEC. (50-4B) BR  
LASALLE COUNTY  
STATION 863+16.00  
STRUCTURE NO. 050-0191 (SB & NB)**

**benesch**  
alfred benesch & company  
Engineers - Surveyors - Planners  
205 North Michigan Avenue, Suite 2400  
Chicago, Illinois 60601  
312-565-0450  
Job # 3856

8/30/2006 9:02:22 AM xi:\3800s\3856\structures\abe lincoln memorials\final\plans\al\_dk\bm517.sht

DESIGNED -	AJK
CHECKED -	MRB
DRAWN -	VH
CHECKED -	MRB