

STATE OF ILLINOIS
DEPARTMENT OF TRANSPORTATION

ROUTE NO. F.A.I. 39	SECTION 50-4B	COUNTY LASALLE	TOTAL SHEETS 180	SHEET NO. 158
FED. ROAD DIST. NO. 7		ILLINOIS FED. AID PROJECT		

Contract # 66586

BILL OF MATERIAL
(Southbound Deck)

Bar	No.	Size	Length	Shape
a(E)	1249	#5	42'-6"	—
a1(E)	755	#6	4'-6"	—
a2(E)	16	#5	2'-0"	—
a520(E)	39	#5	42'-0"	—
a5(E)	10	#6	8'-0"	—
b3(E)	8	#5	2'-3"	—
b520(E)	621	#5	30'-3"	—
b521(E)	551	#5	28'-3"	—
b522(E)	172	#6	36'-9"	—
d(E)	406	#4	3'-4"	┌
d1(E)	833	#5	2'-5"	└
d2(E)	427	#4	3'-5"	┌
d8(E)	10	#5	5'-5"	┌
d97(E)	624	#5	3'-10"	└
x(E)	80	#5	4'-1"	└
Item	Unit	Total		
Reinforcement Bars, Epoxy Coated	Pound	114,550		
Concrete Superstructure	Cu. Yd.	451.9		
Bridge Deck Grooving	Sq. Yd.	1,592		
Protective Coat	Sq. Yd.	1,676		

BILL OF MATERIAL
(Southbound Parapets)

Bar	No.	Size	Length	Shape
d3(E)	833	#4	3'-0"	┌
d4(E)	839	#5	3'-0"	┌
d6(E)	10	#6	8'-11"	└
e10(E)	6	#4	2'-3"	—
e11(E)	2	#8	2'-3"	—
e12(E)	2	#5	2'-3"	—
e14(E)	16	#5	6'-0"	—
e520(E)	36	#4	18'-6"	—
e521(E)	8	#8	31'-6"	—
e522(E)	8	#5	29'-9"	—
e523(E)	48	#4	17'-9"	—
e524(E)	8	#8	35'-9"	—
e525(E)	8	#5	35'-9"	—
e526(E)	120	#4	18'-0"	—
e527(E)	28	#8	30'-3"	—
e528(E)	28	#5	28'-0"	—
e529(E)	42	#4	19'-0"	—
e530(E)	10	#8	31'-0"	—
e531(E)	10	#5	29'-0"	—
Item	Unit	Total		
Reinforcement Bars, Epoxy Coated	Pound	13,740		
Concrete Superstructure	Cu. Yd.	90.8		
Protective Coat	Sq. Yd.	329		

BILL OF MATERIAL
(Northbound Deck)

Bar	No.	Size	Length	Shape
a(E)	1336	#5	42'-6"	—
a1(E)	807	#6	4'-6"	—
a2(E)	16	#5	2'-0"	—
a540(E)	39	#5	42'-0"	—
b3(E)	8	#5	2'-3"	—
b540(E)	667	#5	30'-0"	—
b541(E)	589	#5	28'-3"	—
b542(E)	215	#6	29'-0"	—
d(E)	430	#4	3'-4"	┌
d1(E)	890	#5	2'-5"	└
d2(E)	460	#4	3'-5"	┌
x(E)	80	#5	4'-1"	└
Item	Unit	Total		
Reinforcement Bars, Epoxy Coated	Pound	118,620		
Concrete Superstructure	Cu. Yd.	481.9		
Bridge Deck Grooving	Sq. Yd.	1,699		
Protective Coat	Sq. Yd.	1,789		

BILL OF MATERIAL
(Northbound Parapets)

Bar	No.	Size	Length	Shape
d3(E)	890	#4	3'-0"	┌
d4(E)	890	#5	3'-0"	┌
e14(E)	4	#5	6'-0"	—
e540(E)	90	#4	19'-6"	—
e541(E)	40	#8	30'-3"	—
e542(E)	40	#5	28'-6"	—
e543(E)	24	#4	18'-9"	—
e544(E)	4	#8	37'-9"	—
e545(E)	4	#5	37'-9"	—
e546(E)	84	#4	17'-9"	—
e547(E)	10	#8	31'-3"	—
e548(E)	10	#5	29'-6"	—
e549(E)	4	#8	35'-9"	—
e550(E)	4	#5	35'-9"	—
e551(E)	60	#4	18'-0"	—
Item	Unit	Total		
Reinforcement Bars, Epoxy Coated	Pound	14,440		
Concrete Superstructure	Cu. Yd.	95.1		
Protective Coat	Sq. Yd.	350		

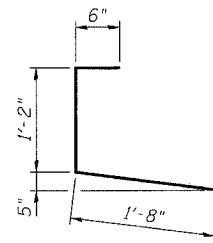

BAR d(E)

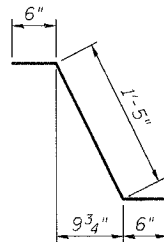

BAR d1(E)

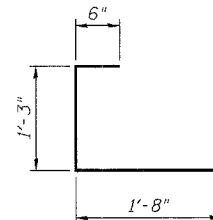

BAR d2(E)

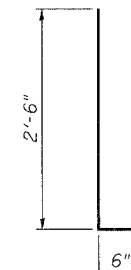

BARS d3(E) & d4(E)

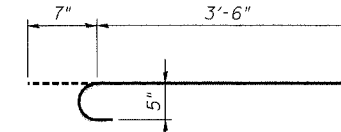

BAR x(E)

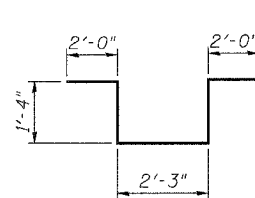

BAR d6(E)

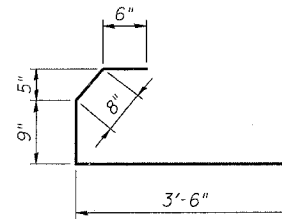

BAR d8(E)

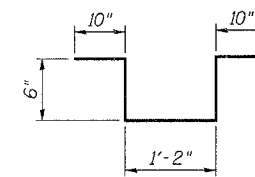

BAR d97(E)

NOTES:

1. Reinforcement bars designated (E) shall be epoxy coated.
2. All bar dimensions are out to out.

BILL OF MATERIAL - SPANS 42 AND 43
ABRAHAM LINCOLN MEMORIAL BRIDGE OVER
THE ILLINOIS RIVER (PUBLIC WATERS)
F.A.I. ROUTE 39 SEC. (50-4B) BR
LASALLE COUNTY
STATION 863+16.00
STRUCTURE NO. 050-0191 (SB & NB)

benesch

alfred benesch & company
Engineers • Surveyors • Planners
205 North Michigan Avenue, Suite 2400
Chicago, Illinois 60601
312-565-0450
Job # 3856

DESIGNED -	HAA
CHECKED -	MRB
DRAWN -	VH
CHECKED -	KWS

xx:\3800s\3856\structures\abe lincoln memorial\final\plans\AL-dk\bm4243.snt

3:01:55 PM

10/16/2006