

STATE OF ILLINOIS
DEPARTMENT OF TRANSPORTATION

ROUTE NO.	SECTION	COUNTY	TOTAL SHEETS	SHEET NO.
F.A.I. 39	50-4B	LASALLE	181	181
FED. ROAD DIST. NO. 7	ILLINOIS	FED. AID PROJECT		

SHEET NO. 159
313 SHEETS

Contract # 66586

BILL OF MATERIAL

(Southbound Deck)

Bar	No.	Size	Length	Shape
a(E)	174	#5	42'-6"	—
a1(E)	148	#6	4'-6"	—
a2(E)	8	#5	2'-0"	—
a560(E)	78	#5	42'-0"	—
a561(E)	3	#5	48'-0"	—
b560(E)	138	#5	26'-3"	—
b561(E)	152	#5	20'-3"	—
d(E)	84	#4	3'-4"	┌
d1(E)	168	#5	2'-5"	┌
d2(E)	84	#4	3'-5"	┌
x(E)	40	#5	4'-1"	┌
x1(E)	40	#5	4'-1"	┌
Item	Unit	Total		
Reinforcement Bars, Epoxy Coated	Pound	20,430		
Concrete Superstructure	Cu. Yd.	90.0		
Bridge Deck Grooving	Sq. Yd.	314		
Protective Coat	Sq. Yd.	330		

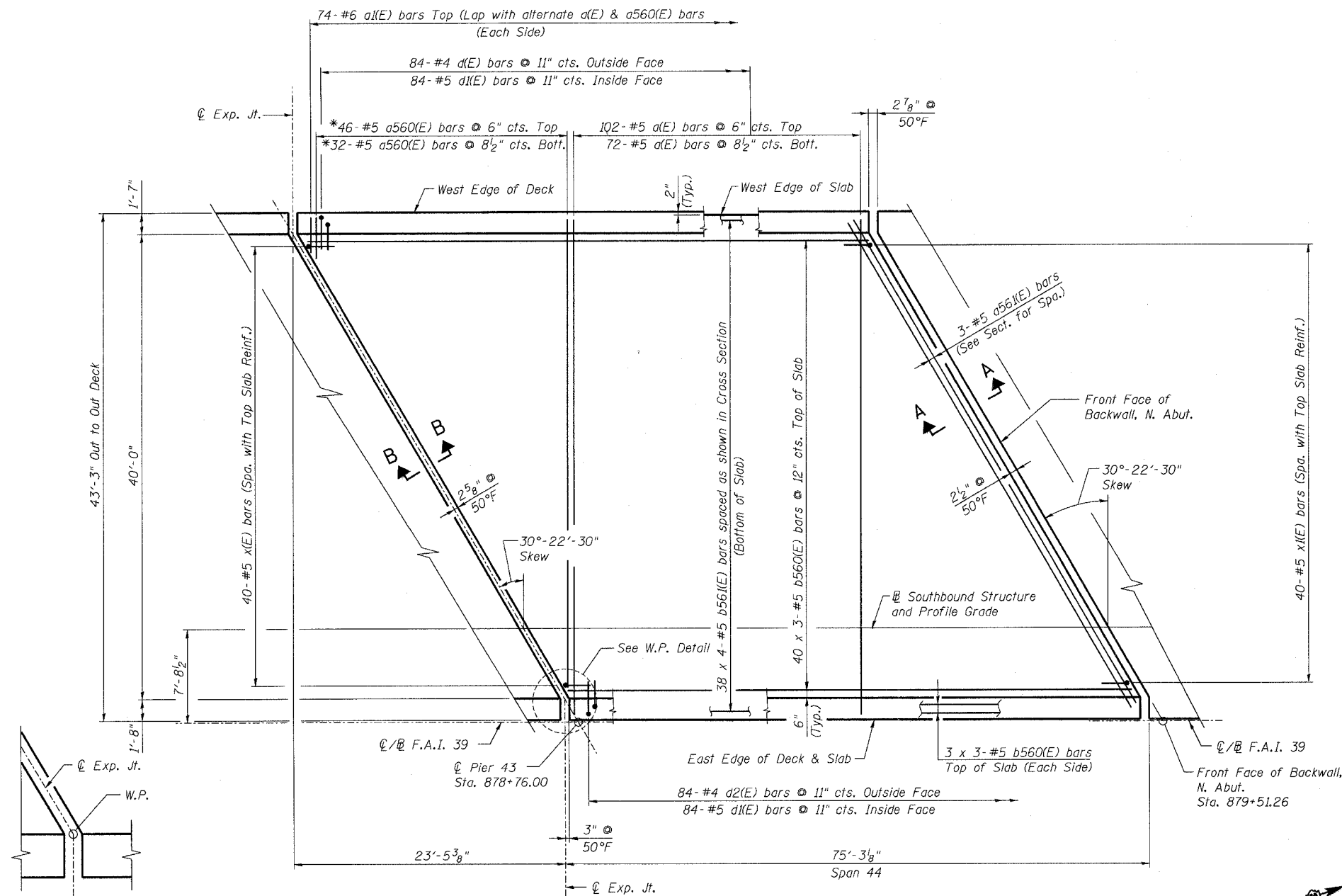

PLAN

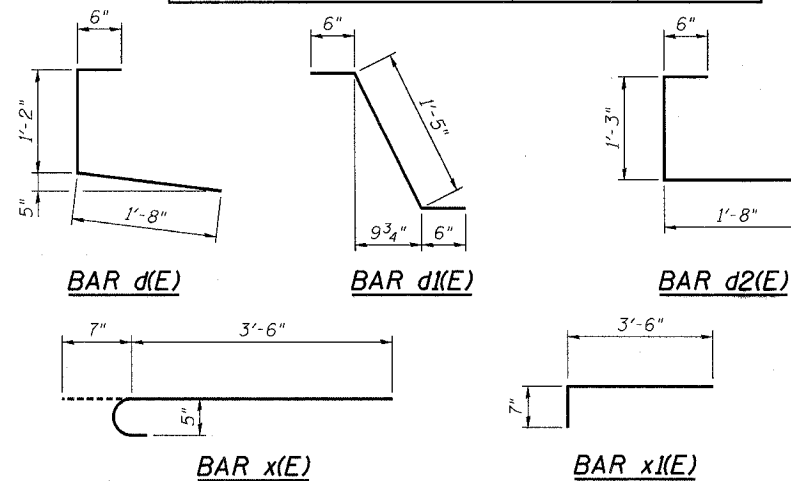

W.P. DETAIL

DESIGNED -	HAA
CHECKED -	MRB
DRAWN -	VH
CHECKED -	KWS

NOTES:

- For Deck Cross Section see sheet 165.
- For Deck Details and Sections A-A & B-B see sheets 166 thru 169.
- Reinforcement bars designated (E) shall be epoxy coated.
- Bars indicated thus 20x3-#5 etc. indicates 20 lines of bars with 3 lengths per line.
- Floor Drains and Scuppers not shown. For locations, see sheets 175 and 176.
- For Scupper Details see sheets 177 and 178.
- For additional deck reinforcement at Scupper locations see sheet 166.

MINIMUM BAR LAP (Slab)

- #5 bar = 2'-2"
- #6 bar = 2'-7"

*Order bars full length. Cut to fit skew & use remainder of bars in opposite end.

benesch

alfred benesch & company
Engineers • Surveyors • Planners
205 North Michigan Avenue, Suite 2400
Chicago, Illinois 60601
312-565-0450
Job # 3856

DECK PLAN - SPAN 44 SB
ABRAHAM LINCOLN BRIDGE OVER
THE ILLINOIS RIVER (PUBLIC WATERS)
F.A.I. ROUTE 39 SEC. (50-4B) BR
LASALLE COUNTY
STATION 863+16.00
STRUCTURE NO. 050-0191 (SB & NB)

x:\3800s\3856\structures\abe.lincoln.memorial\final\plans\AL_dkpl29.sht

3:35:13 PM

8/30/2006