

STATE OF ILLINOIS
DEPARTMENT OF TRANSPORTATION

ROUTE NO. F.A.I. 39	SECTION 50-4B	COUNTY LASALLE	TOTAL SHEETS 24	SHEET NO. 24
FED. ROAD DIST. NO. 7		ILLINOIS	FED. AID PROJECT-	

SHEET NO. 199
313 SHEETS
Contract # 66586

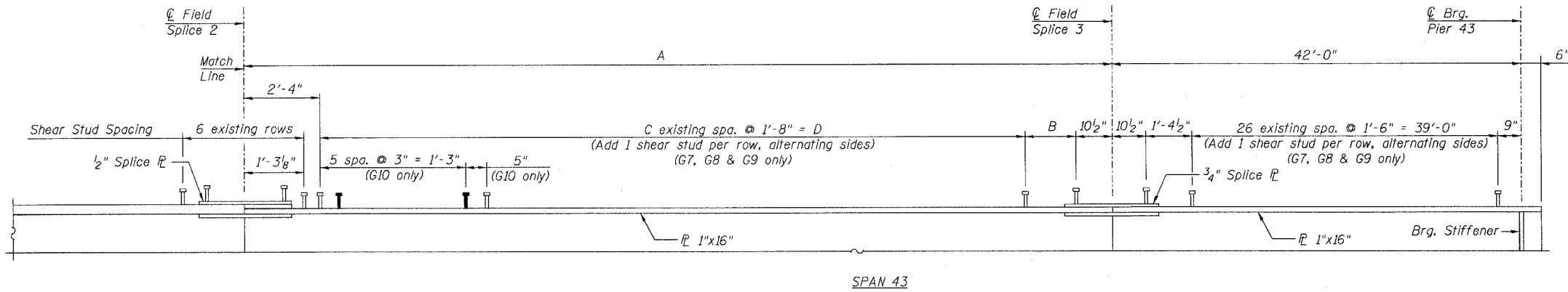

GIRDER ELEVATION
(Dimensions along G Girder)

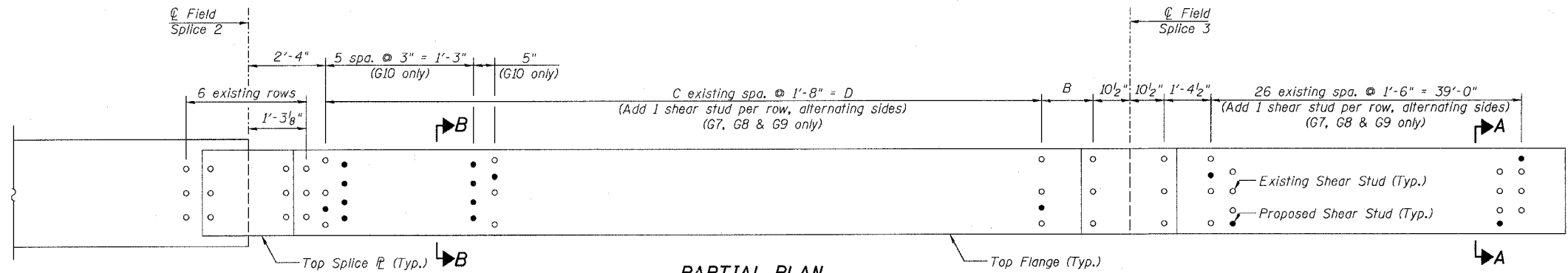

PARTIAL PLAN
(Span 43)

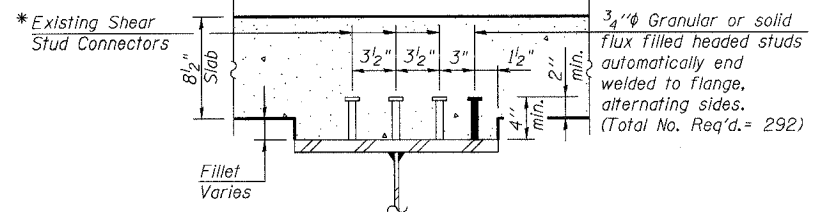

SECTION A-A

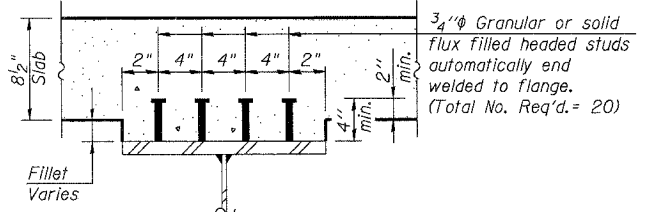

SECTION B-B

* Fillet reinforcement will be required if existing studs do not meet the minimum projection into proposed deck. See detail on sheet 168.

GIRDER VARIABLES

Girder	A	B	C	D
G6	122'-8 7/8"	1'-2 3/8"	71	118'-4"
G7	121'-8 7/8"	1'-10 3/8"	70	116'-8"
G8	119'-8 7/8"	1'-6 3/8"	69	115'-0"
G9	119'-8 7/8"	1'-6 3/8"	69	115'-0"
G10	121'-8 7/8"	1'-10 3/8"	69	115'-0"

DESIGNED -	KWS
CHECKED -	MRB
DRAWN -	JGY
CHECKED -	MTH

LIN ENGINEERING, LTD.
210 W. Chestnut
Chatham, Illinois 62629
(217) 483-4168
FAX (217) 483-4706

benesch
alfred benesch & company
Engineers - Surveyors - Planners
205 North Michigan Avenue, Suite 2400
Chicago, Illinois 60601
312-565-0450
Job # 3856

SHEAR STUDS - SPAN 43 NB
ABRAHAM LINCOLN MEMORIAL BRIDGE OVER
THE ILLINOIS RIVER (PUBLIC WATERS)
F.A.I. ROUTE 39 SEC. (50-4B) BR
LASALLE COUNTY
STATION 863+16.00
STRUCTURE NO. 050-0191 (SB & NB)

x:\3800s\3856\structures\abe lincoln memorial\final\plans\Studs_43NB.sht 3:35:34 PM 8/30/2006