

STATE OF ILLINOIS
DEPARTMENT OF TRANSPORTATION

ROUTE NO. F.A.I. 39	SECTION 50-4B	COUNTY LASALLE	SHEET NO. 329	SHEET NO. 306 313 SHEETS
FED. ROAD DIST. NO. 7		ILLINOIS FED. AID PROJECT		

Contract # 66586

NOTES:

- The quantities shown are for estimating purposes only. The area to be repaired will be determined by the Engineer at the time of construction. Actual repair locations shall be shown on the as-built plans.
- See Sheet 308 for rehabilitation of concrete pedestals.

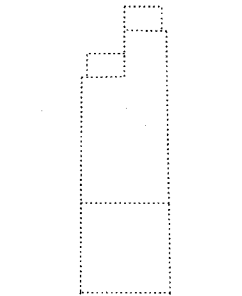
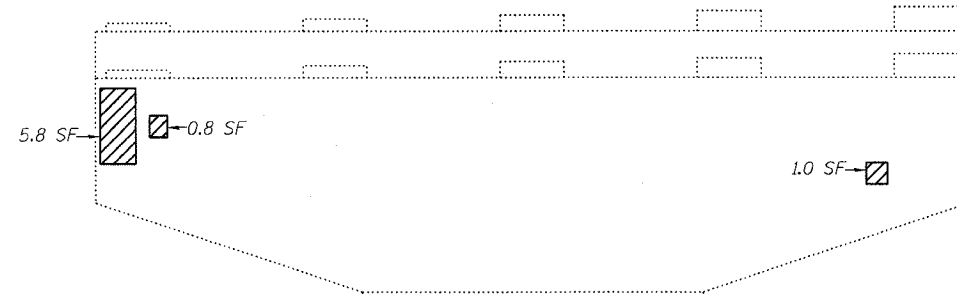
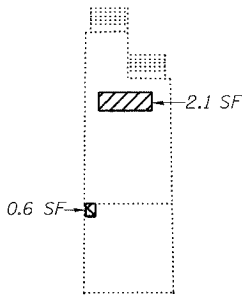
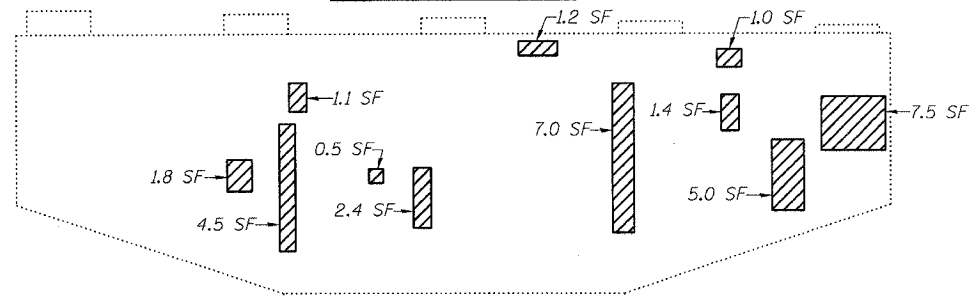
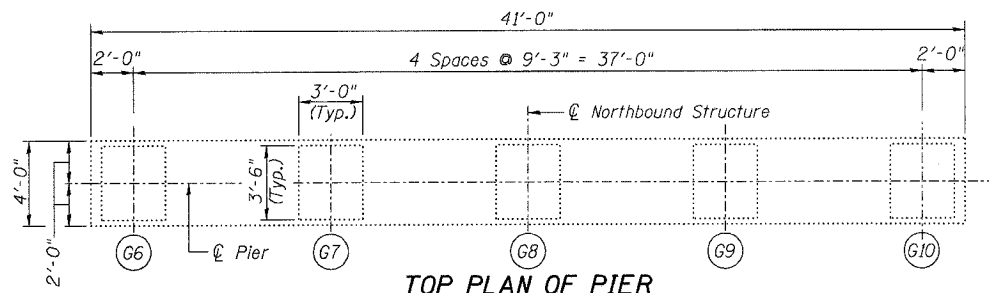

Existing Ground Line (Typ.)

ELEVATION
(Looking North)

END VIEW
(Looking West)

ELEVATION
(Looking South)

END VIEW
(Looking East)

LEGEND

- Structural Repair of Concrete (Depth equal to or less than 5")
- SF Square Feet

BILL OF MATERIAL

ITEM	UNIT	QUANTITY
Structural Repair of Concrete (Depth equal to or less than 5")	SF	43.7

DESIGNED	ADB
CHECKED	BLS
DRAWN	KHH
CHECKED	MTH

LIN ENGINEERING, LTD.
210 W. Chestnut
Chatham, Illinois 62629
(217) 483-4168
FAX (217) 483-4706

benesch
alfred benesch & company
Engineers • Surveyors • Planners
205 North Michigan Avenue, Suite 2400
Chicago, Illinois 60601
312-585-0450
Job # 3856

PIER REPAIR - PIER 41 NB
ABRAHAM LINCOLN MEMORIAL BRIDGE OVER
THE ILLINOIS RIVER (PUBLIC WATERS)
F.A.I. ROUTE 39 SEC. (50-4B) BR
LASALLE COUNTY
STATION 863+16.00
STRUCTURE NO. 050-0191 (SB & NB)

x:\38000s\3856\structures\abe lincoln memorial\final\plans\From_Lin\Pier Repair\41_NB.sht

10:03:32 AM

8/30/2006