

F.A.P. RTE.	SECTION	COUNTY	TOTAL SHEETS	SHEET NO.
315	(34-6.55-1)	HANCOCK/McDONOUGH	433	314
STA. 1442+00.00		TO STA. 1443+00.00		
FED. ROAD DIST. NO.	ILLINOIS	FED. AID PROJECT	STATE CONTRACT NO. 68206	
260	280	300	320	

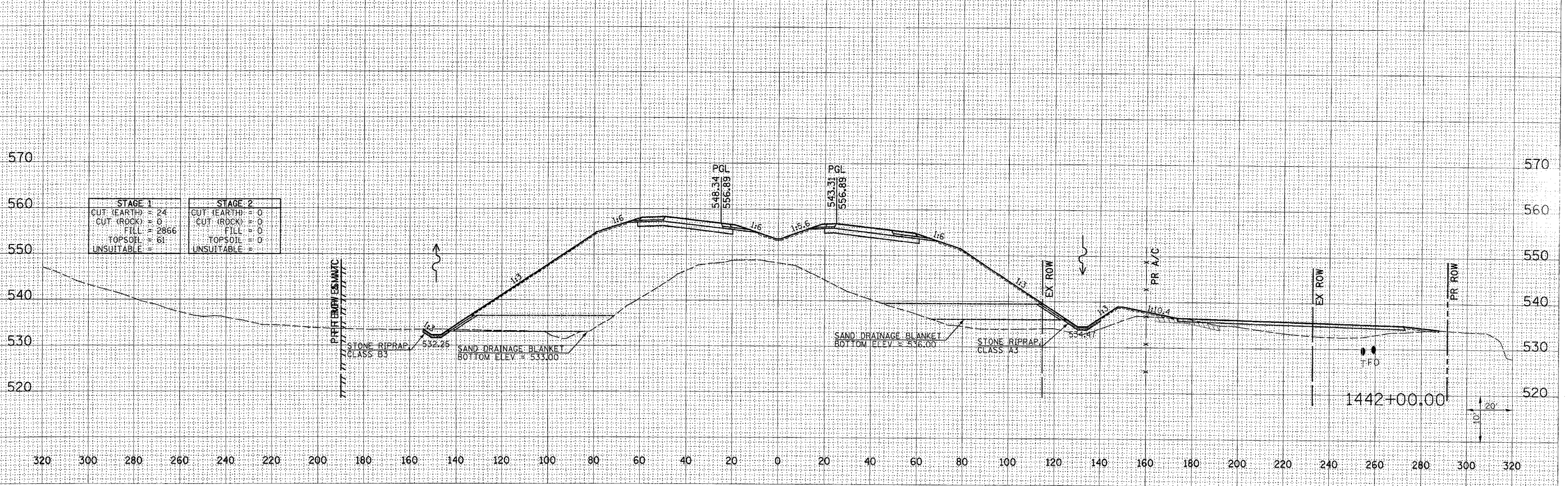
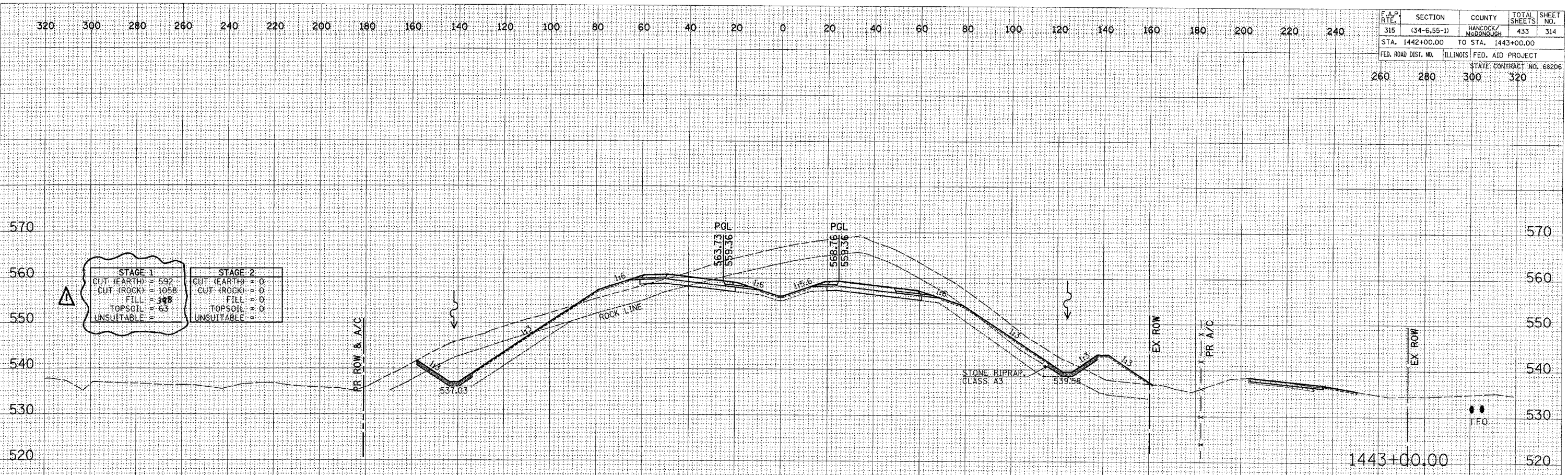

DATE	
BY	
FINAL SURVEY	
NOTE BOOK	
NO.	

DATE	
BY	
ORIGINAL SURVEY	
NOTE BOOK	
NO.	

Plot Date: 8/20/2006  
 Plot Time: 12:50:24 PM  
 Plot By: [Name]  
 Plot File: [Name]  
 Plot Path: [Path]

REVISED 11/10/06

FAP ROUTE 315 (IL 336) CROSS SECTIONS STA 1442+00.00 TO 1443+00.00