

| F.A.P. RTE. | SECTION | COUNTY | TOTAL SHEETS | SHEET NO. |
|--------------------------|-------------|---------------------------|--------------|-----------|
| 315 | (34-6,55-1) | HANCOCK/MCDONOUGH | 433 | 70 |
| STA. 1445+00 | | TO STA. 52+00 | | |
| FED. ROAD DIST. NO. | | ILLINOIS FED. AID PROJECT | | |
| STATE CONTRACT NO. 68206 | | | | |

MAINTENANCE OF TRAFFIC STAGE 1

SEQUENCE OF CONSTRUCTION

- BUILD TR 257 TEMPORARY WIDENING ON LT SIDE BY USING TEMPORARY PIPE & GRANULAR EMBANKMENT (SEE CROSS-SECTIONS)
- INSTALL TEMPORARY PIPE WITH 6' MINIMUM IN DOWNSTREAM END OF BOX CULVERT - BACKFILL W/ GRANULAR EMBANKMENT.
- TRANSFER TRAFFIC TO TEMP WIDENING, REMOVE PORTION OF EX BOX CULVERT, CONSTRUCT PORTION OF PR PIPE CULVERT, BACKFILL TO EX EDGE OF TR 257.
- TRANSFER TRAFFIC BACK TO TR 257, REMOVE TEMPORARY PIPE, REMAINDER OF EX BOX CULVERT, COMPLETE CONSTRUCTION OF PR PIPE CULVERT, COMPLETE CONSTRUCTION OF TR 257 WITH GRANULAR EMBANKMENT
- BUILD TR 28
- BUILD SERVICE DR #1
- BUILD A TEMPORARY CONNECTION TO MAINTAIN ACCESS TO RELOCATED TR 28
- BUILD FUTURE WESTBOUND IL 336 FROM STA 1445+00 TO STA 52+00
- BUILD FUTURE EASTBOUND IL 336 FROM STA 1445+00 TO STA 10+00
- BUILD FUTURE EASTBOUND IL 336 FROM STA 37+00 TO STA 52+00
- BUILD TEMPORARY IL 61 DETOUR
- GRADE EASTBOUND IL 336 FROM STA 10+00 TO STA 37+00 (SEE TYPICAL SECTION AT BOTTOM OF SHEET)

TRAFFIC PLACEMENT

- MAINTAIN WESTBOUND & EASTBOUND TRAFFIC ON EXISTING US 136
- MAINTAIN TRAFFIC ON TR 257 WITH TEMPORARY WIDENING.
- STAGE CONSTRUCT PROPOSED CULVERT AND TR 257
- TR 28 TRAFFIC TO USE EXISTING TR 28 UNTIL RELOCATED TR 28 AND TEMPORARY CONNECTION IS BUILT
- PLACE TRAFFIC ON RELOCATED TR 28 AND ON THE TEMPORARY CONNECTION TO MAINTAIN ACCESS

TRAFFIC CONTROL STANDARDS

701001 701006 701011 701326

PAYMENT

TRAFFIC CONTROL AND PROTECTION, STANDARD 701326

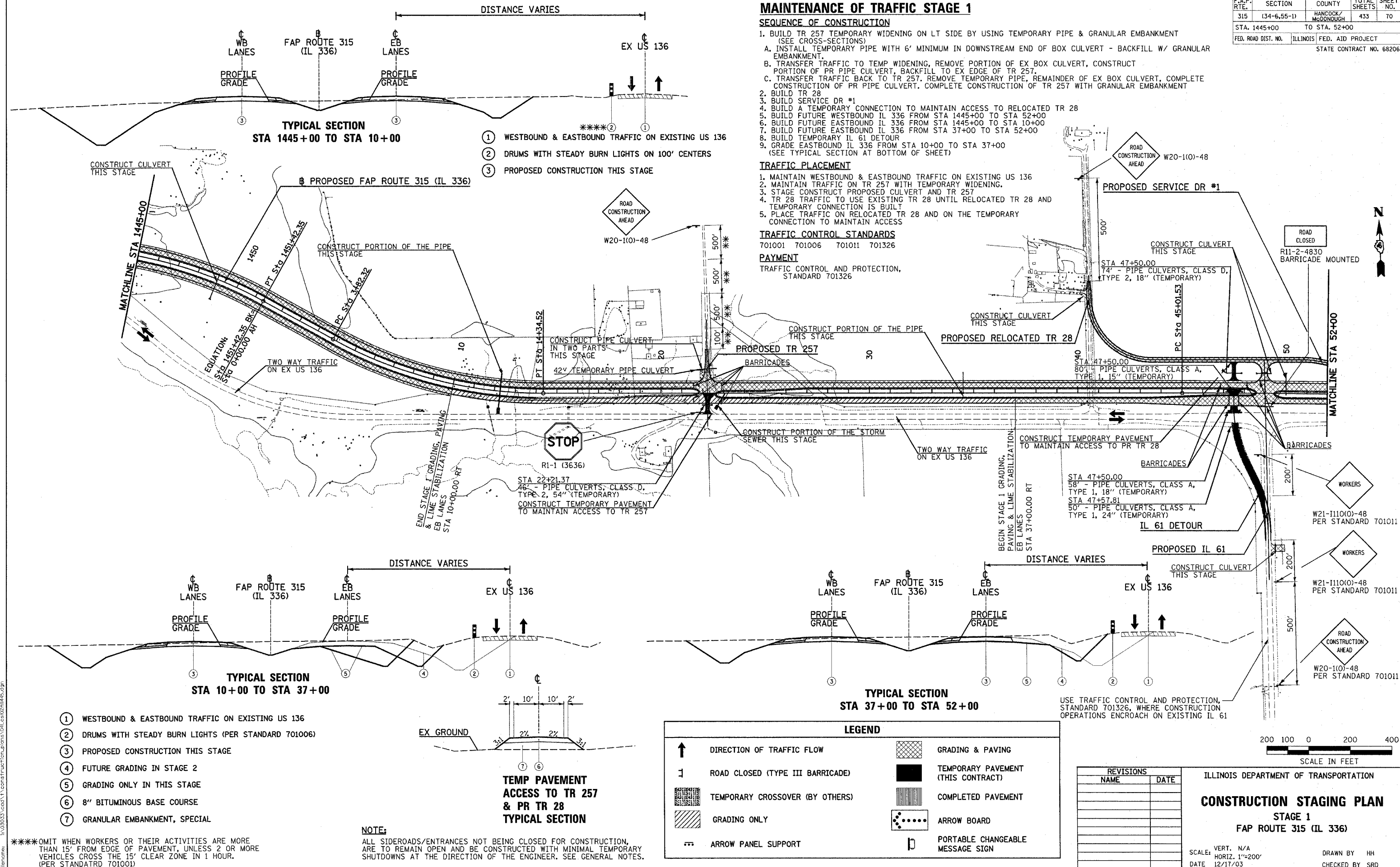

TYPICAL SECTION STA 1445+00 TO STA 10+00

TYPICAL SECTION STA 10+00 TO STA 37+00

TYPICAL SECTION STA 37+00 TO STA 52+00

- WESTBOUND & EASTBOUND TRAFFIC ON EXISTING US 136
- DRUMS WITH STEADY BURN LIGHTS ON 100' CENTERS
- PROPOSED CONSTRUCTION THIS STAGE

- WESTBOUND & EASTBOUND TRAFFIC ON EXISTING US 136
- DRUMS WITH STEADY BURN LIGHTS (PER STANDARD 701006)
- PROPOSED CONSTRUCTION THIS STAGE
- FUTURE GRADING IN STAGE 2
- GRADING ONLY IN THIS STAGE
- 8" BITUMINOUS BASE COURSE
- GRANULAR EMBANKMENT, SPECIAL

TEMP PAVEMENT ACCESS TO TR 257 & PR TR 28 TYPICAL SECTION

NOTE:
ALL SIDEROADS/ENTRANCES NOT BEING CLOSED FOR CONSTRUCTION, ARE TO REMAIN OPEN AND BE CONSTRUCTED WITH MINIMAL TEMPORARY SHUTDOWNS AT THE DIRECTION OF THE ENGINEER. SEE GENERAL NOTES.

| LEGEND | | | |
|----------------------|----------------------------------|------------------------|------------------------------------|
| ↑ | DIRECTION OF TRAFFIC FLOW | [Hatched Box] | GRADING & PAVING |
| [Barricade] | ROAD CLOSED (TYPE III BARRICADE) | [Solid Black Box] | TEMPORARY PAVEMENT (THIS CONTRACT) |
| [Dotted Box] | TEMPORARY CROSSOVER (BY OTHERS) | [Horizontal Lines Box] | COMPLETED PAVEMENT |
| [Diagonal Lines Box] | GRADING ONLY | [Dotted Circle Box] | ARROW BOARD |
| [Arrow Panel] | ARROW PANEL SUPPORT | [Rectangular Sign] | PORTABLE CHANGEABLE MESSAGE SIGN |

| REVISIONS | |
|-----------|------|
| NAME | DATE |
| | |
| | |
| | |
| | |
| | |

ILLINOIS DEPARTMENT OF TRANSPORTATION

CONSTRUCTION STAGING PLAN

STAGE 1
FAP ROUTE 315 (IL 336)

SCALE: VERT. N/A
HORIZ. 1"=200'
DATE 12/17/03

DRAWN BY HH
CHECKED BY SRD

Plot Date: 7/18/2006
Plot Time: 3:25:38 PM
Plotted By: brcmndt
Pen Table: 1000000
Filename: \\s03033\c001\1\construction\p000\04\c002\0445.dgn