

F.A.P. RTE.	SECTION	COUNTY	TOTAL SHEETS	SHEET NO.
315	(34-6,55-1)	HANCOCK/MCDONOUGH	433	74
STA. 1445+00		TO STA. 52+00		
FED. ROAD DIST. NO.	ILLINOIS FED. AID PROJECT		STATE CONTRACT NO. 68206	

NOTE:
ALL SIDEROADS/ENTRANCES NOT BEING CLOSED FOR CONSTRUCTION, ARE TO REMAIN OPEN AND BE CONSTRUCTED WITH MINIMAL TEMPORARY SHUTDOWNS AT THE DIRECTION OF THE ENGINEER. SEE GENERAL NOTE #12.

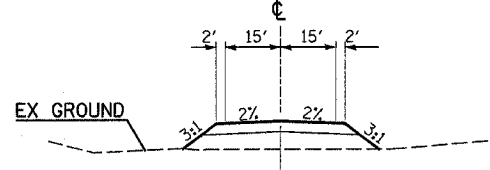

**TYPICAL SECTION
STA 1445+00 TO STA 10+00**

**TEMP PAVEMENT ACCESS TO EX 136
TYPICAL SECTION
STA 9+00.00**

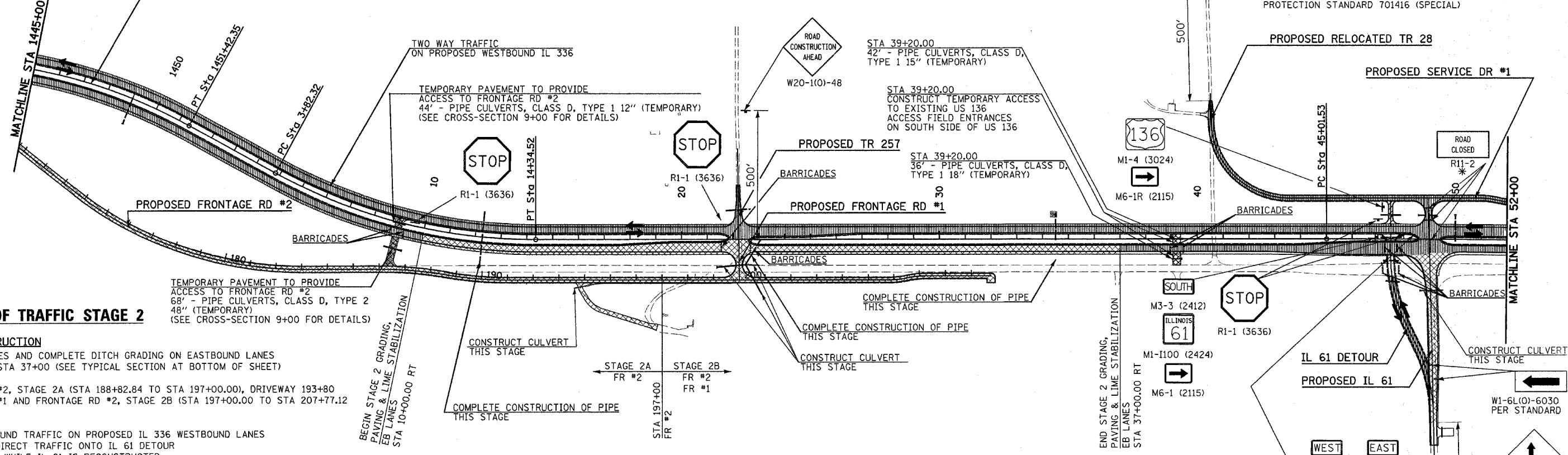

TRAFFIC CONTROL PAYMENT
TRAFFIC CONTROL FOR THE IL 61 DETOUR AND TEMPORARY TR 28 WILL BE PAID FOR AS TRAFFIC CONTROL AND PROTECTION, STANDARD 701331 (SPECIAL)
TRAFFIC CONTROL FOR REMAINING ITEMS SHOWN PAID ON THIS SHEET TO BE INCLUDED IN TRAFFIC CONTROL & PROTECTION STANDARD 701416 (SPECIAL)

MAINTENANCE OF TRAFFIC STAGE 2

- SEQUENCE OF CONSTRUCTION**
- PAVE EASTBOUND LANES AND COMPLETE DITCH GRADING ON EASTBOUND LANES FROM STA 10+00 TO STA 37+00 (SEE TYPICAL SECTION AT BOTTOM OF SHEET)
 - BUILD IL 61
 - BUILD FRONTAGE RD #2, STAGE 2A (STA 188+82.84 TO STA 197+00.00), DRIVEWAY 193+80
 - BUILD FRONTAGE RD #1 AND FRONTAGE RD #2, STAGE 2B (STA 197+00.00 TO STA 207+77.12)
- TRAFFIC PLACEMENT**
- WESTBOUND & EASTBOUND TRAFFIC ON PROPOSED IL 336 WESTBOUND LANES
 - CLOSE IL 61 AND REDIRECT TRAFFIC ONTO IL 61 DETOUR PER STANDARD 701331 WHILE IL 61 IS RECONSTRUCTED
 - PLACE TRAFFIC ON IL 61 AFTER IT HAS BEEN RECONSTRUCTED AND REMOVE DETOUR PAVEMENT
 - DIRECT FRONTAGE RD #2 TRAFFIC TO TEMPORARY ACCESS, AT STA 9+00 UNTIL STAGE 2B IS COMPLETED. THEN DIRECT ALL FR #2 TRAFFIC TO FR #1 AND REMOVE TEMPORARY PAVEMENT AT 9+00

TRAFFIC CONTROL STANDARDS

- 701006 701331 (SPECIAL)

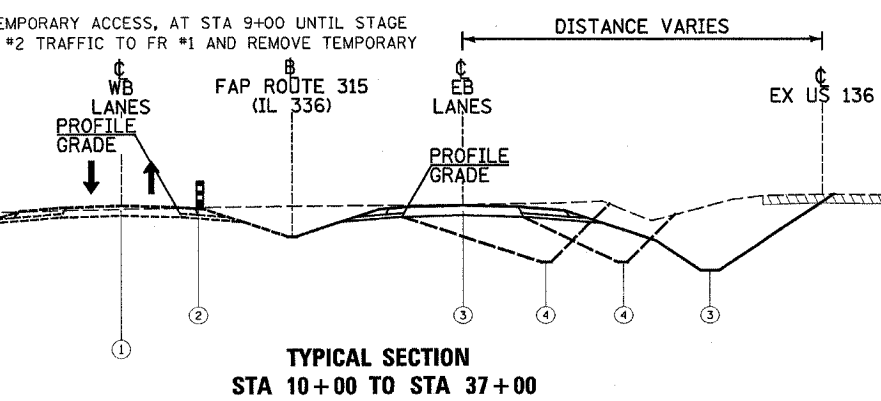

**TYPICAL SECTION
STA 10+00 TO STA 37+00**

- WESTBOUND & EASTBOUND TRAFFIC ON PROPOSED WESTBOUND IL 336 LANES
- DRUMS WITH STEADY BURN LIGHTS (PER STANDARD 701006)
- PROPOSED CONSTRUCTION THIS STAGE
- FROM STAGE 1
- GRADING ONLY FOR FUTURE EASTBOUND LANES
- AGGREGATE SURFACE COURSE, TYPE A 12"

NOTE:
CONTRACTOR SHALL RELOCATE ALL GUIDE SIGNS FOR THE INTERSECTION OF US 136 AND IL 61 TO THE IL 61 DETOUR OR WESTBOUND LANES AS DIRECTED BY THE ENGINEER. SIGN RELOCATION SHALL BE INCLUDED IN THE COST FOR TRAFFIC CONTROL AND PROTECTION, STANDARD 701331 (SPECIAL)

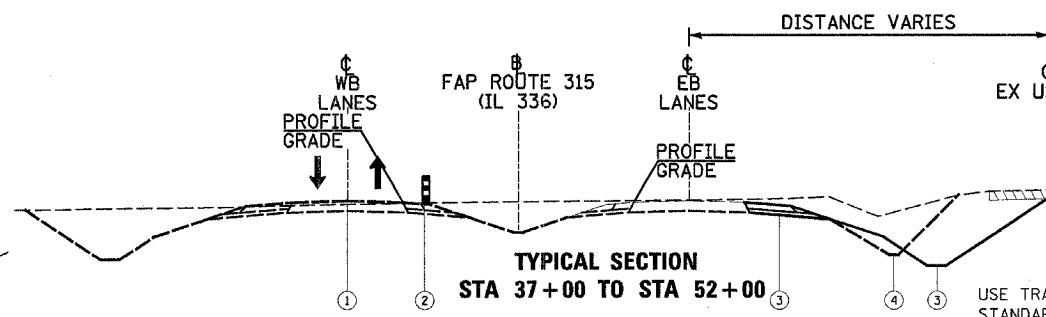

**TYPICAL SECTION
STA 37+00 TO STA 52+00**

LEGEND

↑	DIRECTION OF TRAFFIC FLOW	[Cross-hatch]	GRADING & PAVING
[Bar]	ROAD CLOSED (TYPE III BARRICADE)	[Solid black]	TEMPORARY PAVEMENT (THIS CONTRACT)
[Dotted]	TEMPORARY CROSSOVER (BY OTHERS)	[Horizontal lines]	COMPLETED PAVEMENT
[Diagonal lines]	GRADING ONLY	[Dotted]	ARROW BOARD
[Vertical lines]	ARROW PANEL SUPPORT	[Square with border]	PORTABLE CHANGEABLE MESSAGE SIGN

REVISIONS

NAME	DATE

ILLINOIS DEPARTMENT OF TRANSPORTATION
**CONSTRUCTION STAGING PLAN
STAGE 2
FAP ROUTE 315 (IL 336)**
SCALE: VERT. N/A
HORIZ. 1"=200'
DATE 12/17/03
DRAWN BY HH
CHECKED BY SRD

Plot Date: 7/18/2006
Plot Time: 3:25:46 PM
Plotted By: bschmidt
Pen Table: idc4.tbl
Filename: I:\3333\stage2\constr\staging_plan_05_cad\stage2.dwg