

F.A.P. RTE.	SECTION	COUNTY	TOTAL SHEETS	SHEET NO.
315	(34-6,55-1)	HANCOCK/MCDONOUGH	433	75
STA. 52+00		TO STA. 112+00		
FED. ROAD DIST. NO.	ILLINOIS	FED. AID PROJECT		
			STATE CONTRACT NO. 68206	

**MAINTENANCE OF TRAFFIC STAGE 2**

**SEQUENCE OF CONSTRUCTION**

- BUILD FUTURE EASTBOUND IL 336 FROM STA 66+00 TO STA 112+00
- BUILD TR 36

**TRAFFIC PLACEMENT**

- WESTBOUND & EASTBOUND TRAFFIC ON PROPOSED WESTBOUND IL 336 LANES
- OPEN FRONTAGE RD #3 TO TRAFFIC
- CLOSE TR 36 AND RELOCATE TRAFFIC TO TR 273 (800N) AND THEN TO IL 61

**TRAFFIC CONTROL STANDARDS**

701006 701011 BLR 21-6

**TRAFFIC CONTROL PAYMENT**

PAYMENT FOR SIDEROAD CONSTRUCTION SHALL BE PAID FOR PER BLR 21-6. MAINLINE TO BE INCLUDED IN STANDARD 701416 (SPECIAL)

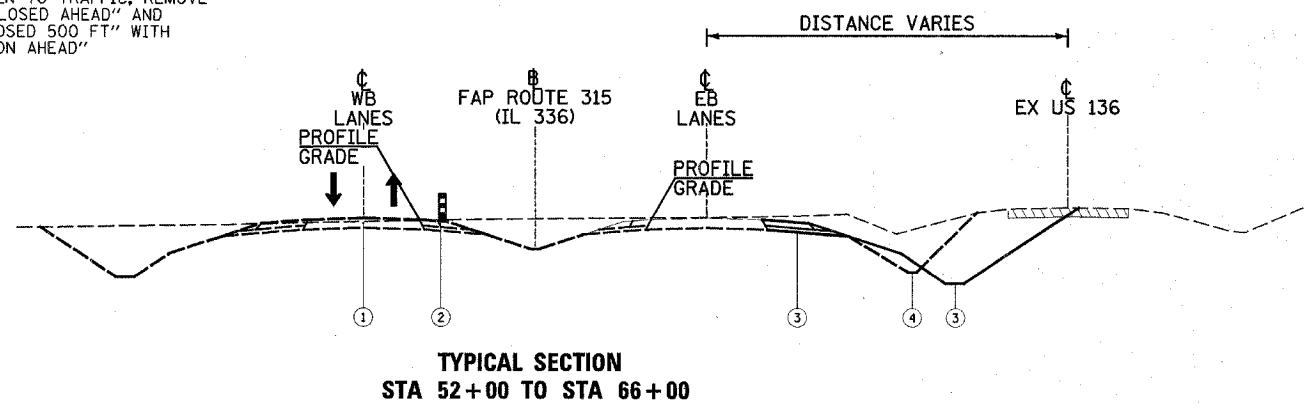
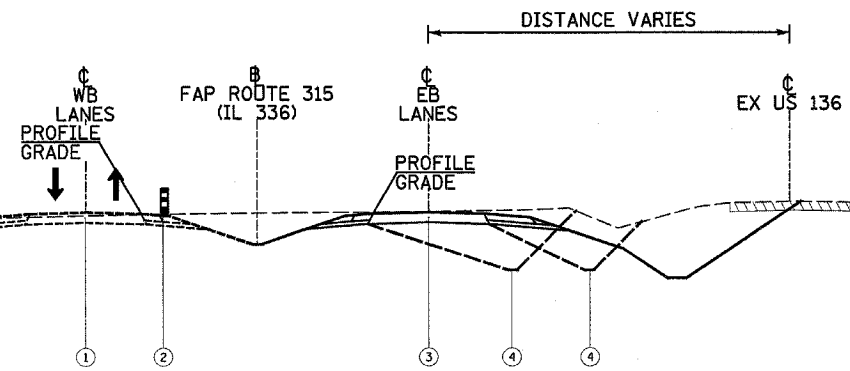
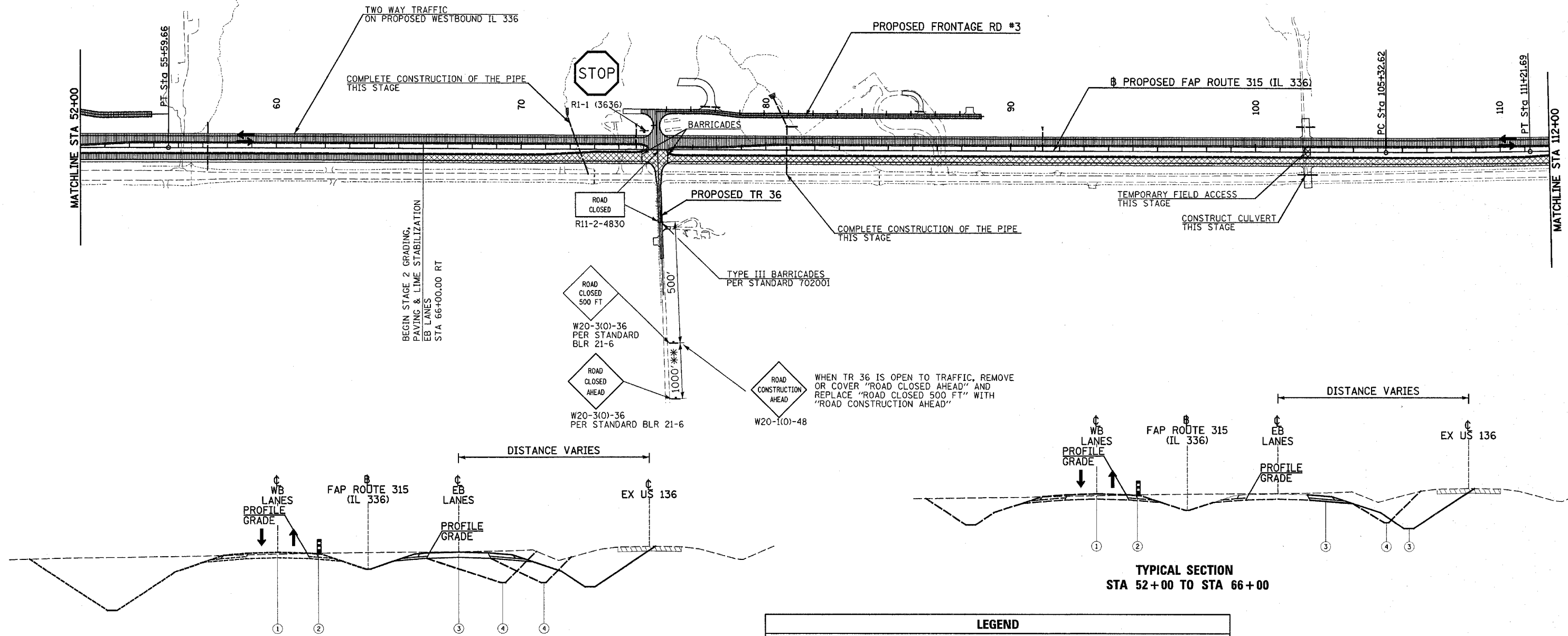

- ① WESTBOUND & EASTBOUND TRAFFIC ON PROPOSED WESTBOUND IL 336 LANES
- ② DRUMS WITH STEADY BURN LIGHTS (PER STANDARD 701006)
- ③ PROPOSED CONSTRUCTION THIS STAGE
- ④ FROM STAGE 1

\*\* NOT TO SCALE, FOLLOW DIMENSIONS

LEGEND			
↑	DIRECTION OF TRAFFIC FLOW		GRADING & PAVING
⌈	ROAD CLOSED (TYPE III BARRICADE)		TEMPORARY PAVEMENT (THIS CONTRACT)
	TEMPORARY CROSSOVER (BY OTHERS)		COMPLETED PAVEMENT
	GRADING ONLY		ARROW BOARD
	ARROW PANEL SUPPORT		PORTABLE CHANGEABLE MESSAGE SIGN

REVISIONS	
NAME	DATE

ILLINOIS DEPARTMENT OF TRANSPORTATION  
**CONSTRUCTION STAGING PLAN**  
 STAGE 2  
 FAP ROUTE 315 (IL 336)

SCALE: VERT. N/A  
 HORIZ. 1"=200'  
 DATE 12/17/03

DRAWN BY HH  
 CHECKED BY SRD

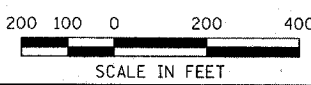

Plot Date: 7/6/2006  
 3:25:41 PM  
 Plotted By: bchoydt  
 Pen Tables: ldot.tbl  
 Filename: I:\03033\cod\1\constr\uc\Hm\plone\046\_cas203m52.dgn