

F.A.P. RTE.	SECTION	COUNTY	TOTAL SHEETS	SHEET NO.
315	(34-6,55-1)	HANCOCK/MCDONOUGH	433	76
STA. 112+00		TO STA. 128+00		
FED. ROAD DIST. NO.	ILLINOIS	FED. AID PROJECT		
STATE CONTRACT NO. 68206				

**NOTE:**  
COORDINATION IS REQUIRED FOR TRAFFIC CONTROL WHERE CONTRACTS MEET.  
(SEE SPECIAL PROVISIONS)

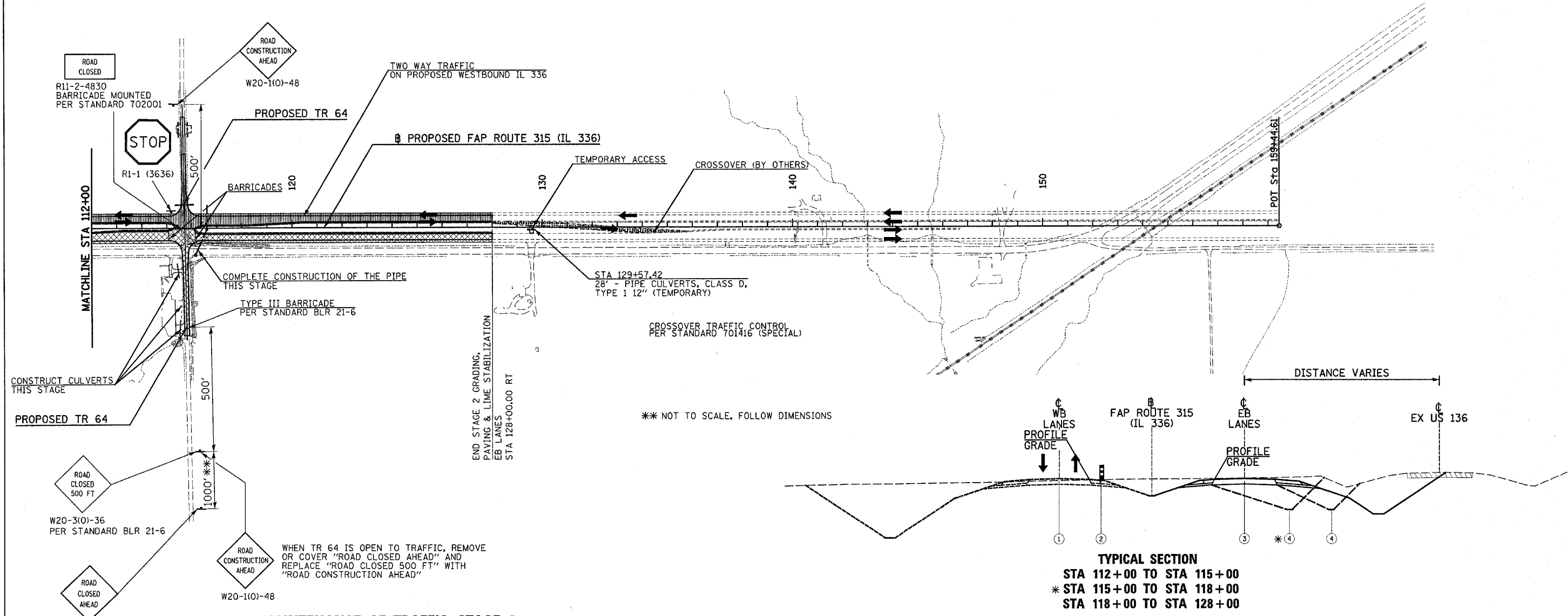

**MAINTENANCE OF TRAFFIC STAGE 2**

- SEQUENCE OF CONSTRUCTION**
- PAVE EASTBOUND LANES AND COMPLETE GRADING ON EASTBOUND LANES FROM STA 112+00 TO STA 128+00
  - BUILD TR 64 SOUTH OF IL 336

- TRAFFIC PLACEMENT**
- WESTBOUND & EASTBOUND TRAFFIC ON PROPOSED WESTBOUND IL 336 LANES
  - OPEN TR 64 NORTH OF IL 336 TO TRAFFIC
  - CLOSE TR 64 SOUTH OF IL 336 TO TRAFFIC PER STANDARD BLR 21-6 RELOCATE TRAFFIC TO TR 273 (800N) AND THEN TO IL 61

**TRAFFIC CONTROL STANDARDS**  
701006 701011 701416 (SPECIAL) BLR 21-6

**TRAFFIC CONTROL PAYMENT**  
TRAFFIC CONTROL FOR MAINLINE & CROSSOVER TO BE PAID FOR AS TRAFFIC CONTROL AND PROTECTION, STANDARD 701416 (SPECIAL)  
TRAFFIC CONTROL FOR TR 64 SHALL BE PAID FOR AS TRAFFIC CONTROL BLR 21-6

- TYPICAL SECTION**  
STA 112+00 TO STA 115+00  
\* STA 115+00 TO STA 118+00  
STA 118+00 TO STA 128+00
- WESTBOUND & EASTBOUND TRAFFIC ON PROPOSED WESTBOUND IL 336 LANES
  - DRUMS WITH STEADY BURN LIGHTS (PER STANDARD 701006)
  - PROPOSED CONSTRUCTION THIS STAGE
  - FROM STAGE 1

LEGEND	
↑	DIRECTION OF TRAFFIC FLOW
⌋	ROAD CLOSED (TYPE III BARRICADE)
▨	TEMPORARY CROSSOVER (BY OTHERS)
▧	GRADING ONLY
⬮	ARROW PANEL SUPPORT
▩	GRADING & PAVING
■	TEMPORARY PAVEMENT (THIS CONTRACT)
▨	COMPLETED PAVEMENT
⬮	ARROW BOARD
⬮	PORTABLE CHANGEABLE MESSAGE SIGN

REVISIONS	
NAME	DATE

ILLINOIS DEPARTMENT OF TRANSPORTATION

**CONSTRUCTION STAGING PLAN**  
STAGE 2  
FAP ROUTE 315 (IL 336)

SCALE: VERT. N/A  
HORIZ. 1"=200'  
DATE: 12/17/03

DRAWN BY: HH  
CHECKED BY: SRD

Plot Date: 7/28/2006  
 Plot Time: 3:25:40 PM  
 Plot By: [unclear]  
 Plot To: [unclear]  
 File Name: I:\03033\cadd\1\constr\trfctn\_plans\047\_cac24mlls.dgn