

F.A.P. RTE.	SECTION	COUNTY	TOTAL SHEETS	SHEET NO.
315	(34-6,55-1)	HANCOCK/McDONOUGH	433	117
STA. 1437+50.00		TO STA. 1451+00.00		
FED. ROAD DIST. NO.		ILLINOIS FED. AID PROJECT		
STATE CONTRACT NO. 68206				

PLAN	SURVEYED	DATE
NOTE BOOK	ALIGNED	
NO.	RT. OF WAY CHECKED	
	FILE NAME	

PROFILE	SURVEYED	DATE
NOTE BOOK	GRADES CHECKED	
NO.	STRUCTURE NOTATIONS CHECKED	

Plot Date: 8/20/2006
 Plot Time: 8:41:09 PM
 Plotted By: sabinoue
 Pen Table: 1501.tbl
 Filename: h:\02033\cadd\1\constr\util-plan\088_cad\dm17r.dgn

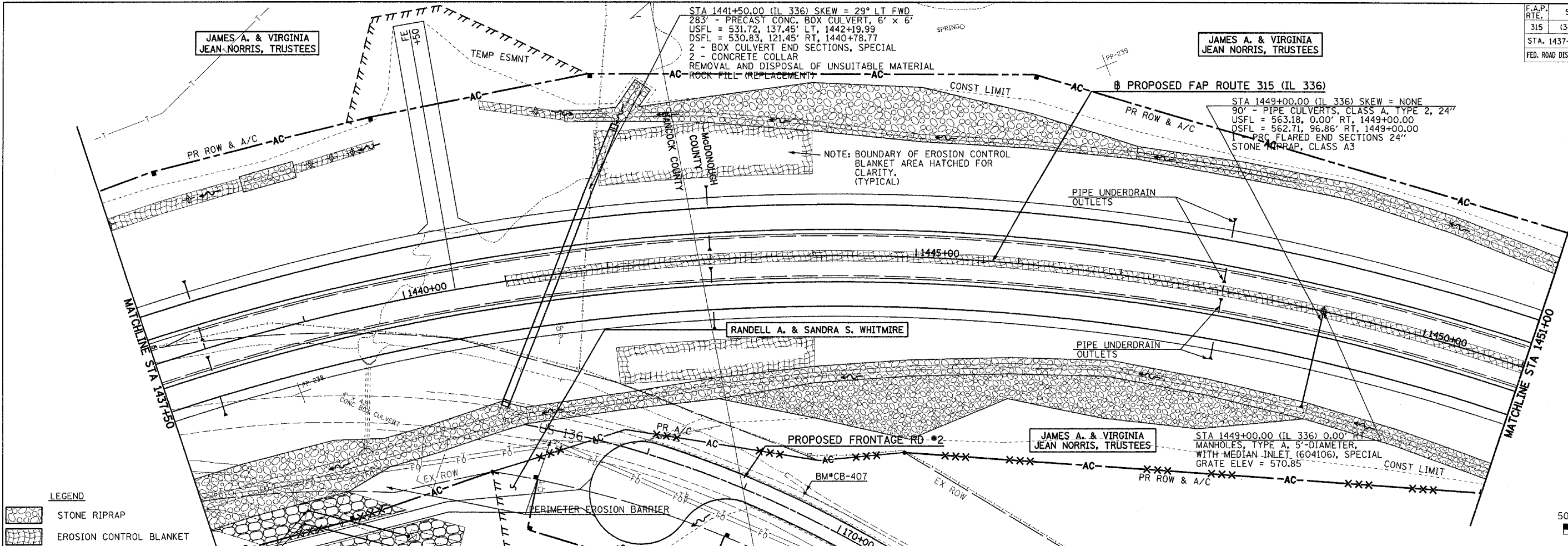

- LEGEND**
- STONE RIPRAP
 - EROSION CONTROL BLANKET
 - HEAVY DUTY EROSION CONTROL BLANKET
 - FABRIC FORMED CONCRETE REVETMENT MAT
 - SEDIMENT BASIN
 - TEMPORARY DITCH CHECK
 - INLET & PIPE PROTECTION

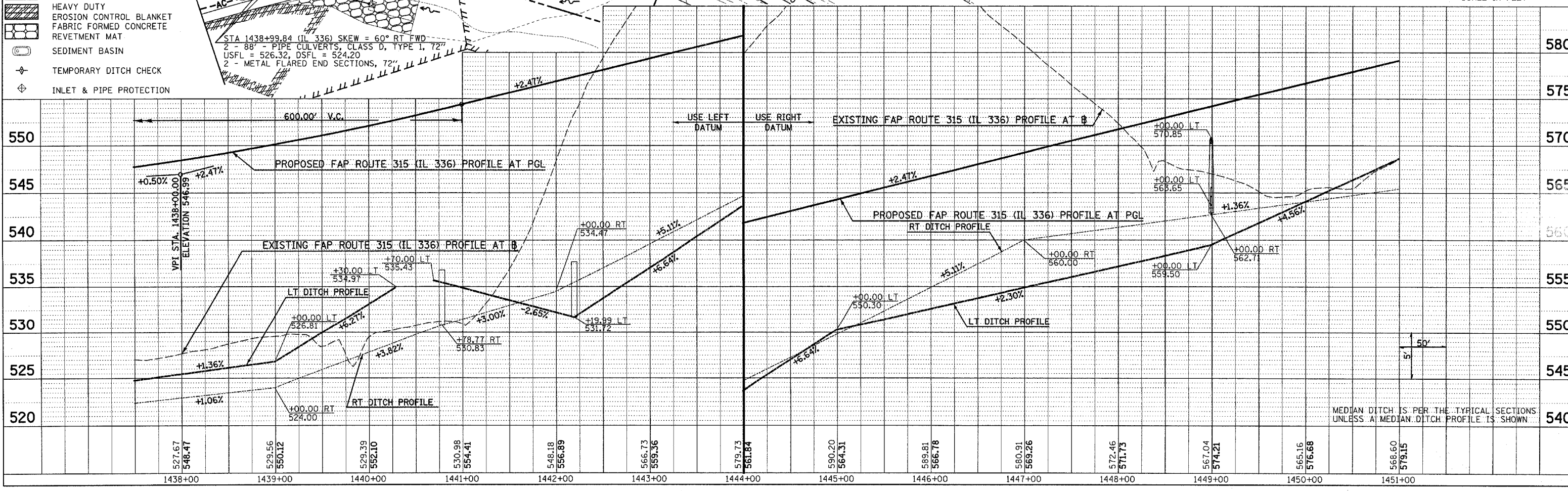
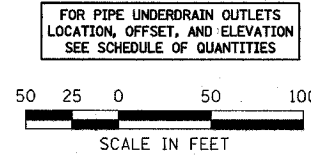

DRAINAGE & UTILITY PLAN & PROFILE - FAP ROUTE 315 (IL 336) STA 1437+50 TO STA 1451+00