

BRIDGE NO 7- 090-0035 IL 8/116/29 OVER IL 29

F.A. RTE.	SECTION	COUNTY	TOTAL SHEETS	SHEET NO.
VAR	D4 BROG PNT 07	VARIOUS	17	16
STA.		TO STA.		
FED. ROAD DIST. NO. 4		ILLINOIS		

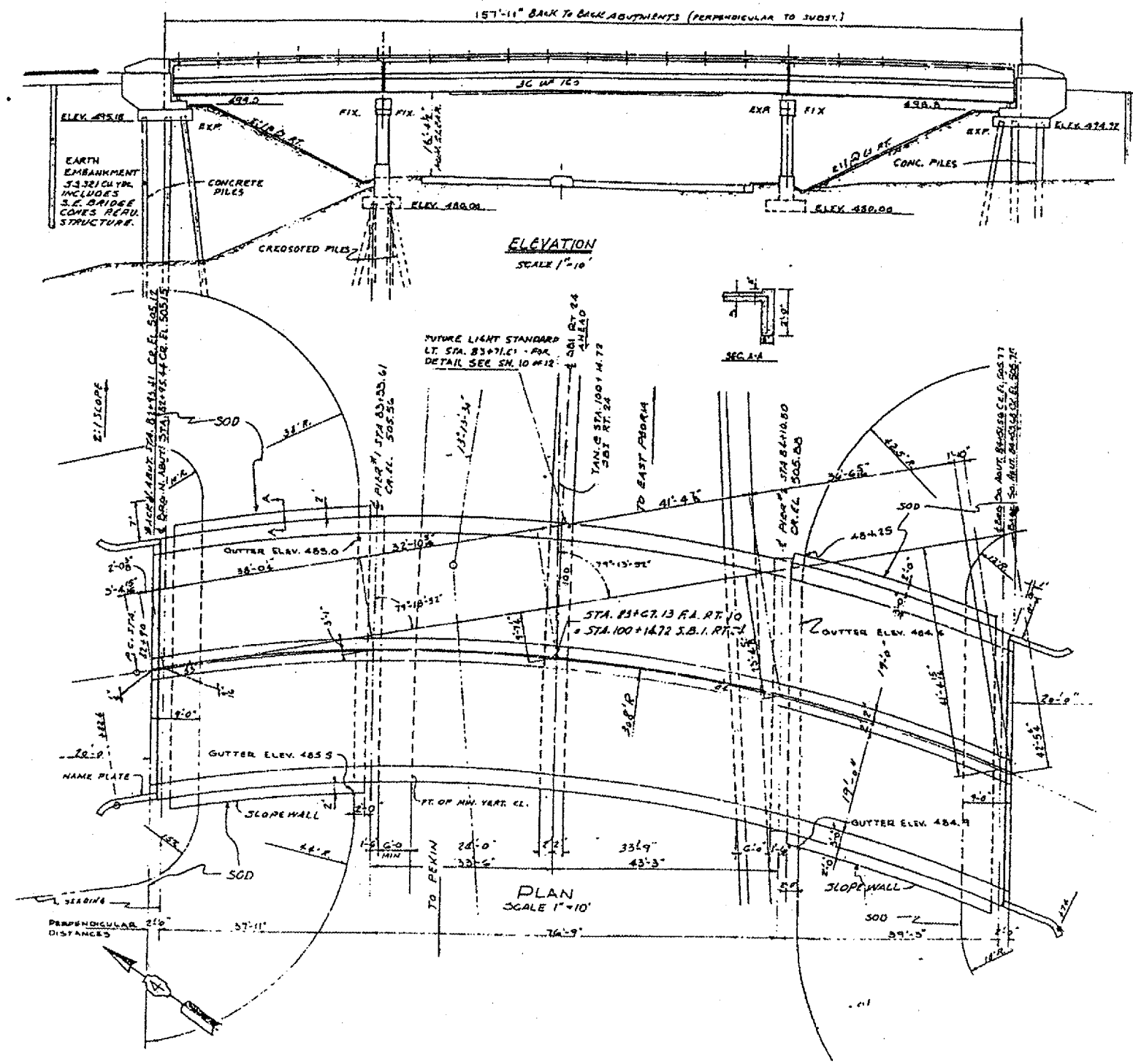

FOR
INFORMATION ONLY

ILLINOIS DEPARTMENT OF TRANSPORTATION
BRIDGE NO 7
PLAN & ELEVATION
DATE 07-26-2006 DRAWN BY