

F.A.P. RTE.	SECTION	COUNTY	TOTAL SHEETS	SHEET NO.
735		MACOUPIN	5	1

\* 6RS-3; 7RS-6

STATE OF ILLINOIS  
DEPARTMENT OF TRANSPORTATION

DIVISION OF HIGHWAYS

**PROPOSED  
HIGHWAY PLANS**

FAS ROUTE 735 (SHIPMAN BLACKTOP)  
SECTION 6RS-3; 7RS-6

MACOUPIN COUNTY  
C-96-521-07

INDEX OF SHEETS

- 1 COVER SHEET
- 2 SUMMARY OF QUANTITIES
- 3 SCHEDULE OF QUANTITIES
- 4-5 TYPICAL SECTIONS

LIST OF STANDARDS

- 000001-04
- 442201-01
- 701001-01
- 701006-02
- 701011-01
- 701301-02
- 701306-01
- 701311-02
- 702001-06
- 780001-01
- 781001-02

PROJECT ENGINEER: JOHN NEGANGARD (782-6990)  
SQUAD LEADER: VINCE MADONIA (785-9046)

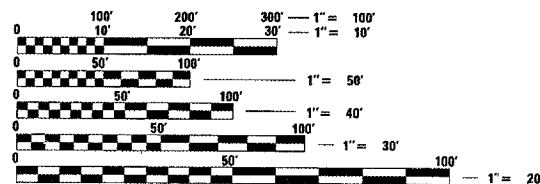

FULL SIZE PLANS HAVE BEEN PREPARED USING STANDARD ENGINEERING SCALES. REDUCED SIZED PLANS WILL NOT CONFORM TO STANDARD SCALES. IN MAKING MEASUREMENTS ON REDUCED PLANS, THE ABOVE SCALES MAY BE USED.

J.U.L.I.E.  
JOINT UTILITY LOCATION INFORMATION FOR EXCAVATION  
1-800-892-0123

CONTRACT NO. 72A67

- BEGIN PROJECT 252+91
- HURRICANE CREEK BRIDGE OMISSION 283+97 TO 285+03
- MACOUPIN CREEK BRIDGE OMISSION 379+28 TO 385+32
- PAVEMENT OMISSION 399+75 TO 558+58
- COOP CREEK BRIDGE OMISSION 655+54 TO 655+94
- END PROJECT 790+58

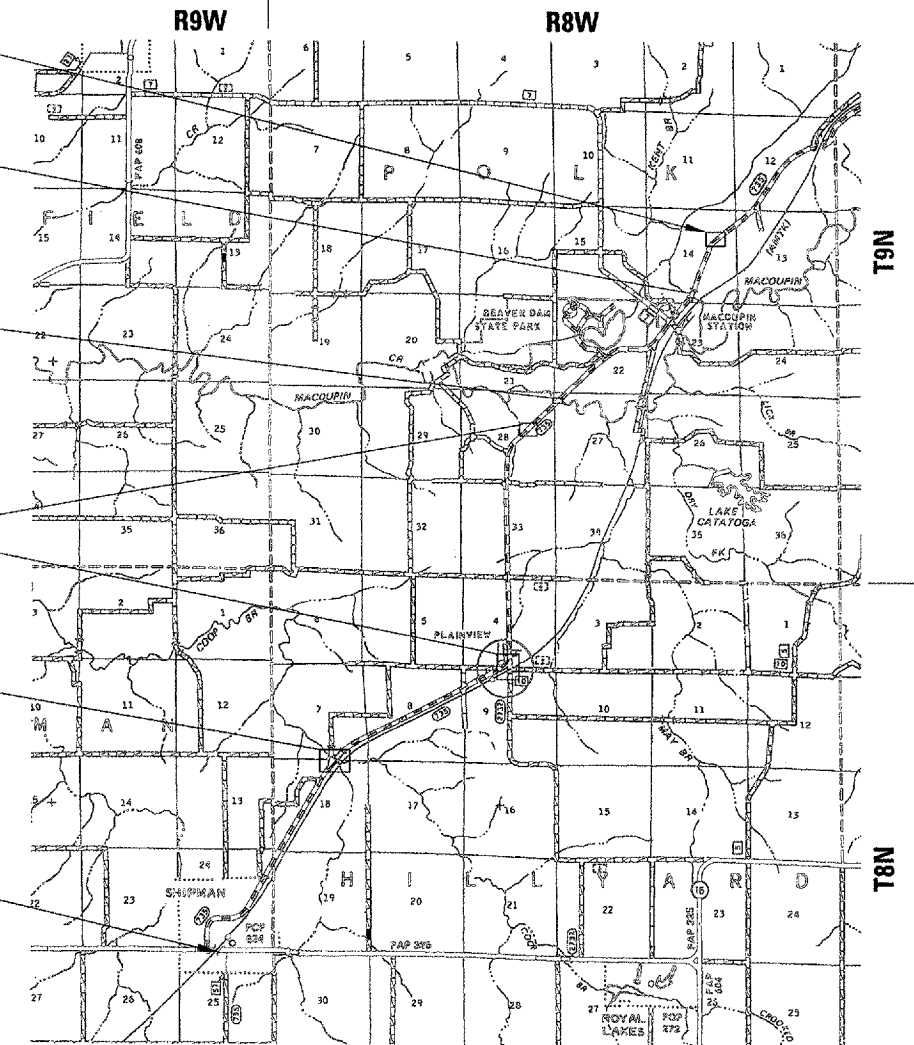

NET PROJECT LENGTH = 7.03 MILES

GROSS PROJECT LENGTH = 10.18 MILES

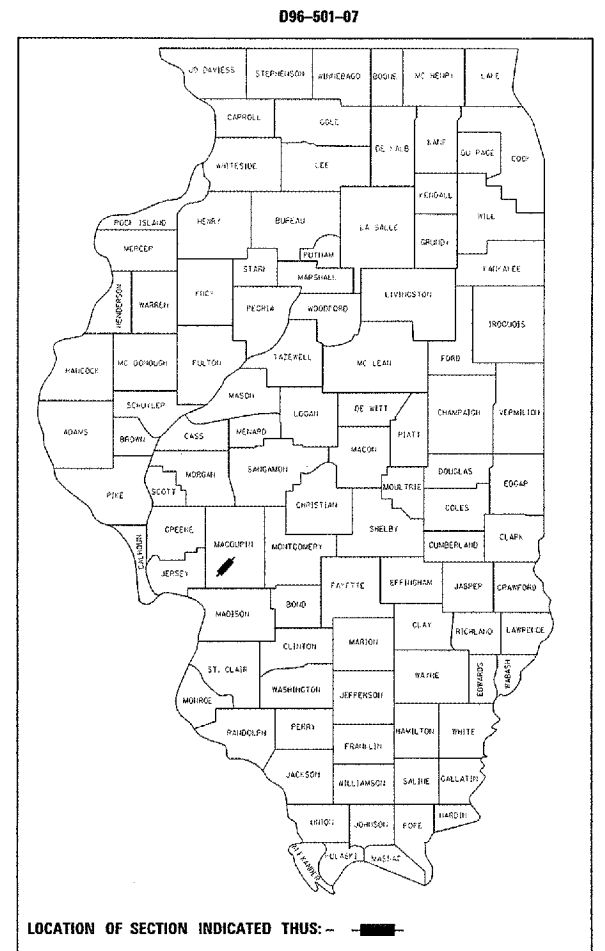

LOCATION OF SECTION INDICATED THUS: - ■ -

ADT 1,300 (2005)  
%MU + %SU = 12%

STATE OF ILLINOIS  
DEPARTMENT OF TRANSPORTATION  
DIVISION OF HIGHWAYS

SUBMITTED Sept 14, 2006  
*Chris M. Reed*  
DEPUTY DIRECTOR OF HIGHWAYS, REGION ENGINEER

October 13, 2006  
*Mike Hene*  
ENGINEER OF DESIGN AND ENVIRONMENT

October 13, 2006  
*Milton R. Seay*  
DIRECTOR OF HIGHWAYS, CHIEF ENGINEER

**PRINTED BY THE AUTHORITY  
OF THE STATE OF ILLINOIS**

F.A.P. RTE.	SECTION	COUNTY	TOTAL SHEETS	SHEET NO.
735	*	MACOUPIN	5	2
STA.		TO STA.		
FED. ROAD DIST. NO.		ILLINOIS FED. AID PROJECT		
* 6RS-3; 7RS-6				

Location 1  
  
SHIPMAN BLACKTOP  
100% STATE  
CONST. CODE F000

Code No.	Item	Unit	Total	Quantity
40300200	BITUMINOUS MATERIALS (PRIME COAT)	TON	32.0	32.0
40600300	AGGREGATE (PRIME COAT)	TON	168	168
44800100	MICRO-SURFACING, 1 PASS	SQ YD	51,467	51,467
67100100	MOBILIZATION	L SUM	1.0	1.0
70100460	TRAFFIC CONTROL AND PROTECTION, STANDARD 701306	L SUM	1.0	1.0
* 78001120	PAINT PAVEMENT MARKING - LINE 5"	FOOT	104,808	104,808
* 78100100	RAISED REFLECTIVE PAVEMENT MARKER	EACH	464	464
78300200	RAISED REFLECTIVE PAVEMENT MARKER REMOVAL	EACH	464	464
X0324951	CAPE SEAL	SQ YD	32,744	32,744

<b>DISTRICT SIX</b>	
EXAMINED <u>Aug 29</u> 20 <u>06</u>	
<i>[Signature]</i>	
OPERATIONS ENGINEER	
EXAMINED <u>Aug 29</u> 20 <u>06</u>	
<i>[Signature]</i>	
PROGRAM IMPLEMENTATION ENGINEER	
EXAMINED <u>AUGUST 30</u> 20 <u>06</u>	
<i>[Signature]</i>	
PROGRAM DEVELOPMENT ENGINEER	

\*SPECIALTY ITEMS

REVISIONS	
NAME	DATE

ILLINOIS DEPARTMENT OF TRANSPORTATION  
SUMMARY OF QUANTITIES

FAP 735  
SECTION 6RS-3; 7RS-6  
MACOUPIN COUNTY

SCALE: VERT. \_\_\_\_\_  
HORIZ. \_\_\_\_\_  
DATE \_\_\_\_\_

DRAWN BY \_\_\_\_\_  
CHECKED BY \_\_\_\_\_

PLOT DATE = 8/31/2006  
 FILE NAME = c:\projects\6828187\ahsaa.dgn  
 USER = ah  
 SCALE = 1/8"=1'-0"  
 USER = ah

F.A.P. RTE.	SECTION	COUNTY	TOTAL SHEETS	SHEET NO.
735	*	MACOUPIN	5	3
STA.		TO STA.		
FED. ROAD DIST. NO.	ILLINOIS	FED. AID PROJECT		
* 6RS-3; 7RS-6				

Application Rates

Bituminous Materials (Prime Coat)                      0.00038 Tons / Sq Yd      ( 0.10 Gal / Sq Yd)  
 Aggregate Materials (Prime Coat)                      0.002 Tons / Sq Yd

<u>Station Range</u>		<u>Width</u> ( FT )	<u>Length</u> ( FT )	<u>Area</u> ( SY )	<u>Micro-Surfacing</u> ( SY )	<u>CAPE Seal</u> ( SY )	<u>Aggregate</u> ( Prime ) ( TONS )	<u>Bituminous</u> ( Prime ) ( TONS )	<u>Raised</u> <u>Reflective Markers</u> <u>Removal</u> ( EACH )	<u>Raised</u> <u>Reflective Markers</u> <u>Installation</u> ( EACH )
252+91	TO 283+97	24	3,106	8,283	--	8,283	16.6	3.1	39	39
285+03	TO 292+00	24	697	1,859	--	1,859	3.7	0.7	9	9
292+00	TO 379+28	20	8,728	19,396	--	19,396	38.8	7.4	109	109
385+32	TO 399+75	20	1,443	3,207	--	3,207	6.4	1.2	18	18
558+58	TO 655+54	20	9,696	21,547	21,547	--	43.1	8.2	121	121
655+94	TO 790+58	20	13,464	29,920	29,920	--	59.8	11.4	168	168
<i>Totals</i>			<i>37,134</i>	<i>84,211</i>	<i>51,467</i>	<i>32,744</i>	<i>168</i>	<i>32.0</i>	<i>464</i>	<i>464</i>
			<i>7,033</i>							

Paint Pavement Marking Line, 5"

<u>Location</u>	<u>Length</u> ( FT )	<u>Edge Line</u> ( FT )	<u>Center Dash</u> ( FT )	<u>Center Solid</u> ( FT )
Passing Zone	13,728	27,456	3,432	0
No Passing - One Way	8,448	16,896	2,112	8,448
No Passing Zones	11,616	23,232	0	23,232
<i>Total</i>		<i>67,584</i>	<i>5,544</i>	<i>31,680</i>
<i>Total</i>		<i>104,808</i>		

**Notes:**

The Fine Aggregate used with the A-1 treatment for the CAPE seal shall be CA-16.

PLOT DATE = 9/1/2006  
 FILE NAME = c:\p\projects\6550187\ah\tsseq.dgn  
 PLOT SCALE = 1/8"=1'-0"  
 USER NAME = laughlin-1

REVISIONS		ILLINOIS DEPARTMENT OF TRANSPORTATION
NAME	DATE	
		SUMMARY OF QUANTITIES
		FAP 735
		SECTION 6RS-3; 7RS-6
		MACOUPIN COUNTY
SCALE:	VERT.      DRAWN BY	CHECKED BY
DATE:	HORIZ.	

F.A.P. RTE.	SECTION	COUNTY	TOTAL SHEETS	SHEET NO.
735	.	MACOUPIN	5	4
STA.		TO STA.		
FED. ROAD DIST. NO.	ILLINOIS	FED. AID PROJECT		

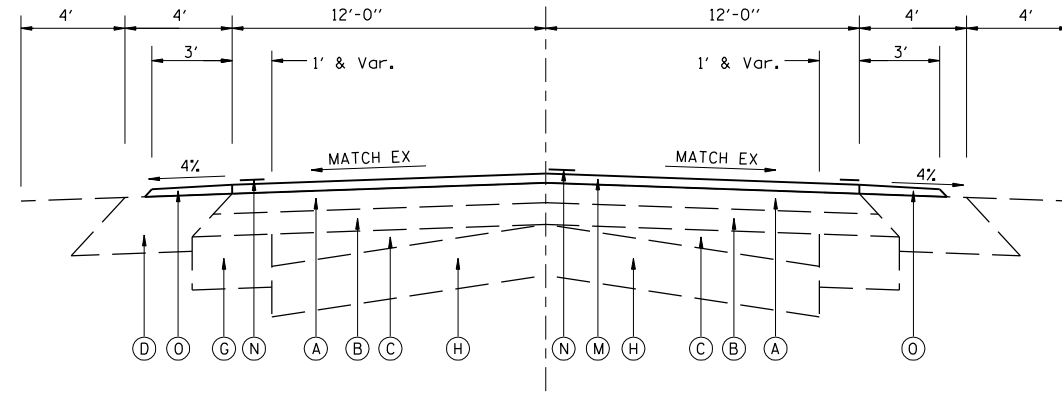

TYPICAL SECTION  
STA. 252+91 TO 292+00  
Bridge Omission  
283+97 to 285+03

- LEGEND
- (A) EX. BITUMINOUS CONCRETE SURFACE, MIX., TYPE 2, 1 1/2"
  - (B) EX. BITUMINOUS CONCRETE BINDER COURSE, TYPE 2, 1 1/2"
  - (C) EX. LEVELING BINDER (MACHINE METHOD), TYPE 2
  - (D) EX. AGG. SHLDS.
  - (E) EX. SUB BASE GRANULAR MATERIAL
  - (F) EX. SEAL COAT
  - (G) EX. BASE COURSE WIDENING, 8"
  - (H) EX AGG. BASE
  - (I) EX. BITUMINOUS CONCRETE SURFACE MIX. C, 3/4"
  - (J) EX. BITUMIONUS SURFACE TREATMENTS
  - (K) EX GUTTER, TYPE A
  - (L) PROPOSED MICRO-SURFACING 1 PASS
  - (M) PROPOSED CAPE SEAL
  - (N) PROPOSED 5" PAINT PAVEMENT MARKING
  - (O) PROPOSED AGGREGATE SHOULDER, TY B (THICKNESS VARIES)

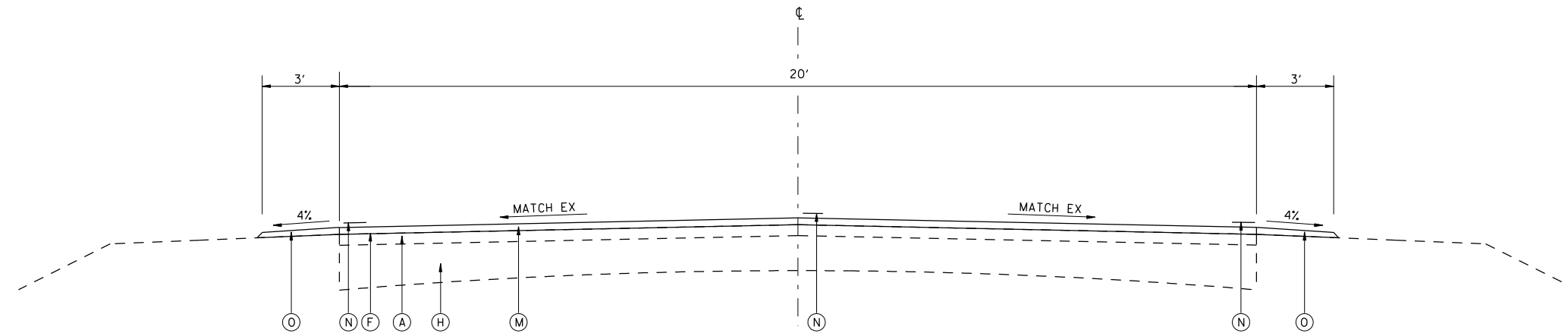

TYPICAL SECTION  
STA. 292+00 TO 399+75  
Bridge Omission  
379+27.9 to 385+32

REVISIONS	
NAME	DATE

ILLINOIS DEPARTMENT OF TRANSPORTATION

TYPICAL SECTIONS

FAP 735  
SECTION 6RS-3; 7RS-6  
MACOUPIN COUNTY

SCALE: VERT. \_\_\_\_\_  
HORIZ. \_\_\_\_\_

DATE \_\_\_\_\_ DRAWN BY \_\_\_\_\_  
CHECKED BY \_\_\_\_\_

PLOT DATE = 9/1/2006  
FILE NAME = c:\projects\650107\h\typical.dgn  
PLOT SCALE = 2:1, 7/8" / 1"  
USER NAME = laughlin-1

F.A.P. RTE.	SECTION	COUNTY	TOTAL SHEETS	SHEET NO.
735	.	MACOUPIN	5	5
STA.		TO STA.		
FED. ROAD DIST. NO.	ILLINOIS	FED. AID PROJECT		

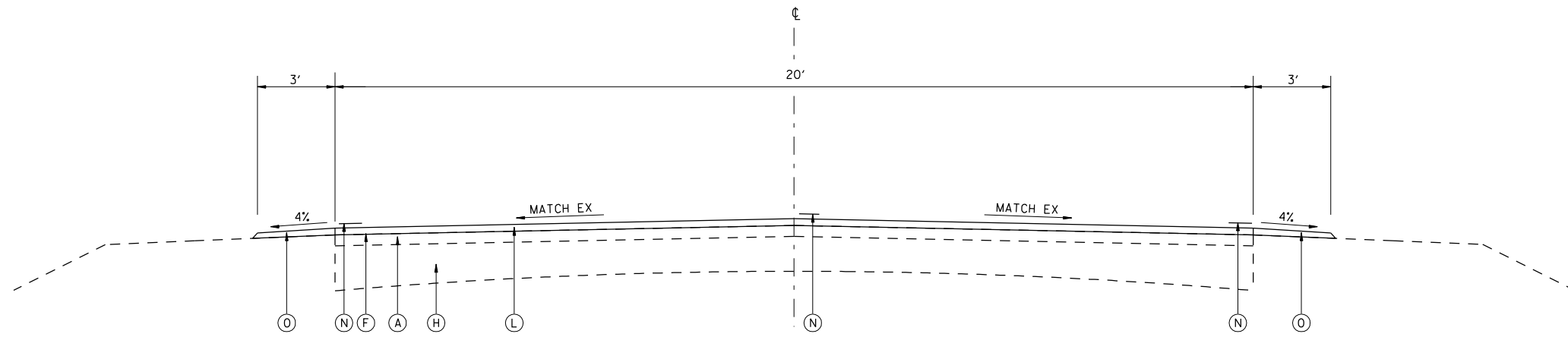

TYPICAL SECTION Bridge Omission  
STA. 558+58 TO 613+9.90 379+27.9 to 385+32

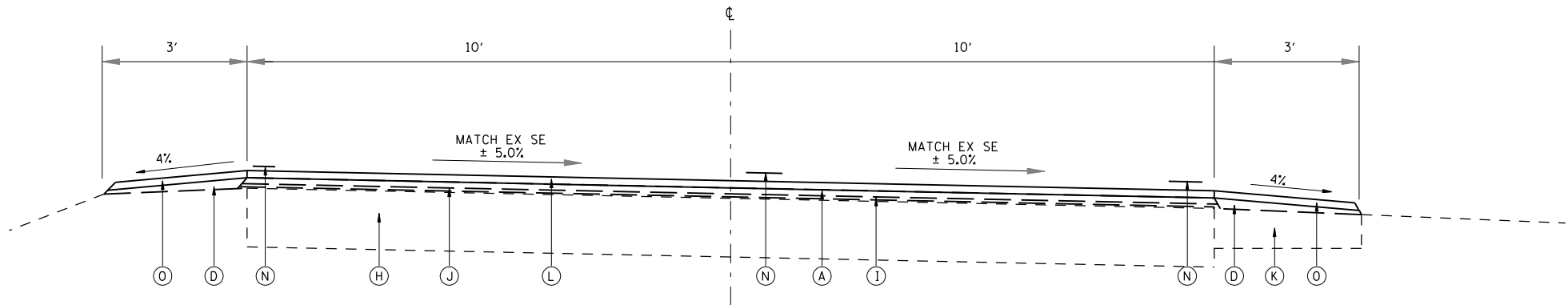

TYPICAL SECTION  
STA. 642+29.1 TO 653+77.1

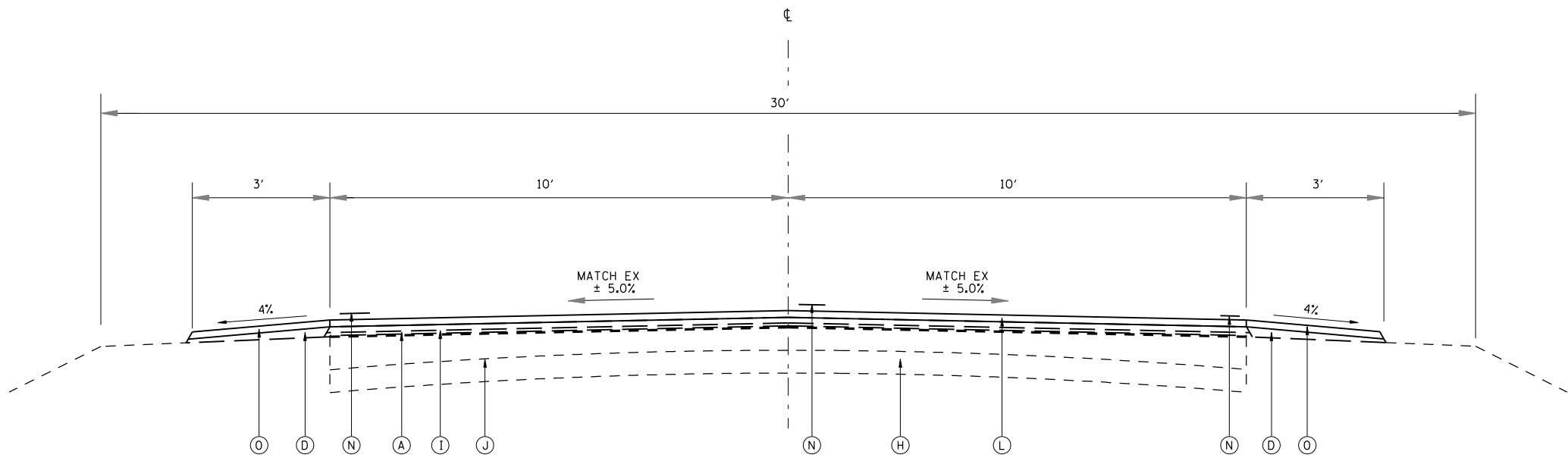

TYPICAL SECTION  
STA. 613+9.90 TO 642+29.1  
STA. 653+77.1 TO 790+58  
Bridge Omission  
655+54.2 to 655+93.8

- LEGEND
- (A) EX. BITUMINOUS CONCRETE SURFACE, MIX., TYPE 2, 1 1/2"
  - (B) EX. BITUMINOUS CONCRETE BINDER COURSE, TYPE 2, 1 1/2"
  - (C) EX. LEVELING BINDER (MACHINE METHOD), TYPE 2
  - (D) EX. AGG. SHLDS.
  - (E) EX. SUB BASE GRANULAR MATERIAL
  - (F) EX. SEAL COAT
  - (G) EX. BASE COURSE WIDENING, 8"
  - (H) EX. AGG. BASE
  - (I) EX. BITUMINOUS CONCRETE SURFACE MIX. C, 3/4"
  - (J) EX. BITUMIONUS SURFACE TREATMENTS
  - (K) EX GUTTER, TYPE A
  - (L) PROPOSED MICRO-SURFACING 1 PASS
  - (M) PROPOSED CAPE SEAL
  - (N) PROPOSED 5" PAINT PAVEMENT MARKING
  - (O) PROPOSED AGGREGATE SHOULDER, TY B (THICKNESS VARIES)

REVISIONS	
NAME	DATE

ILLINOIS DEPARTMENT OF TRANSPORTATION

TYPICAL SECTIONS

FAP 735  
SECTION 6RS-3; 7RS-6  
MACOUPIN COUNTY

SCALE: VERT. \_\_\_\_\_  
HORIZ. \_\_\_\_\_

DATE \_\_\_\_\_ DRAWN BY \_\_\_\_\_  
CHECKED BY \_\_\_\_\_

PLOT DATE = 9/1/2006  
FILE NAME = c:\projects\6550187\h\typical.dgn  
PLOT SCALE = 21,1767 / IN.  
USER NAME = laughlin-1