

SECTION	COUNTY	TOTAL SHEETS	SHEET NO.
02-00034-00-BT	DUPAGE	108	26
STA. TO STA.			
IDOT PROJECT NO. M-8003(216)			
SALT CREEK GREENWAY TRAIL			
CONTRACT NO. 83714			

- ① W1-2L
450mmX450mm
3.7 m TYPE A POST
- ② W1-2R
450mmX450mm
3.7 m TYPE A POST
- ③ STOP
RI-1
450mmX450mm
3.05 m TYPE A POST
- ④ W 1-5
450mmX450mm
3.7 m TYPE A POST

- ⑤ Salt Creek
Trail
Trail Segment Sign
Village of Oak Brook
- ⑥ Salt Creek
Trail
Trail Segment Sign
Village of Oak Brook

SIGN PANELS, TYPE 1 WITH ALUMINUM SIGN POST, SPECIAL (SEE DETAIL)

1.8 SM DETECTABLE WARNING
6 SM PCC SIDEWALK, 150 mm

1.5 m WIDE, 300 mm WHITE THERMOPLASTIC PAVEMENT MARKING WITH 300 mm, 45° DIAGONALS @ 1000 mm C-C

(2) 0.9 SM DETECTABLE WARNINGS
(2) 3 SM PCC SIDEWALK, 150 mm

600 mm WHITE PAINT PAVEMENT MARKING STOP BAR

BEGIN CONSTRUCTION STA. 29+220.000

PROPOSED BICYCLE TRAIL
AGGREGATE BASE COURSE, TYPE B, 150 mm
BIT. CONC. SURF. COURSE, SUPERPAVE, MIX C, N50, 50 mm
PAINT PAVT. MKG. - LINE 100 mm (SOLID YELLOW ☐)

PROP. CURVE OAKB-1
PI STA = 29+234.488
N =
E =
Δ = 72° 02' 17" (RT)
R = 15.000 m
T = 10.906 m
L = 18.860 m
E = 3.546 m

PROP. CURVE OAKB-2
PI STA = 29+275.438
N =
E =
Δ = 24° 33' 14" (RT)
R = 30.000 m
T = 6.528 m
L = 12.856 m
E = 0.702 m

PROP. CURVE OAKB-3
PI STA = 29+315.436
N =
E =
Δ = 94° 27' 32" (LT)
R = 20.000 m
T = 21.620 m
L = 32.972 m
E = 9.452 m

PROPOSED BICYCLE TRAIL
AGGREGATE BASE COURSE, TYPE B, 150 mm
BIT. CONC. SURF. COURSE, SUPERPAVE, MIX C, N50, 50 mm

- ☐ PRECAST REINFORCED CONCRETE FES, 450 mm STA. 29+311.15, 3.9 m RT INV. = 194.10
- ☐ PRECAST REINFORCED CONCRETE FES, 450 mm STA. 29+300.0, 4.0 m LT INV. = 194.50

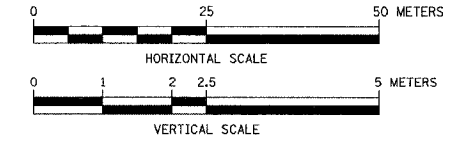

FOR LEGEND SEE SHEET NO. 21

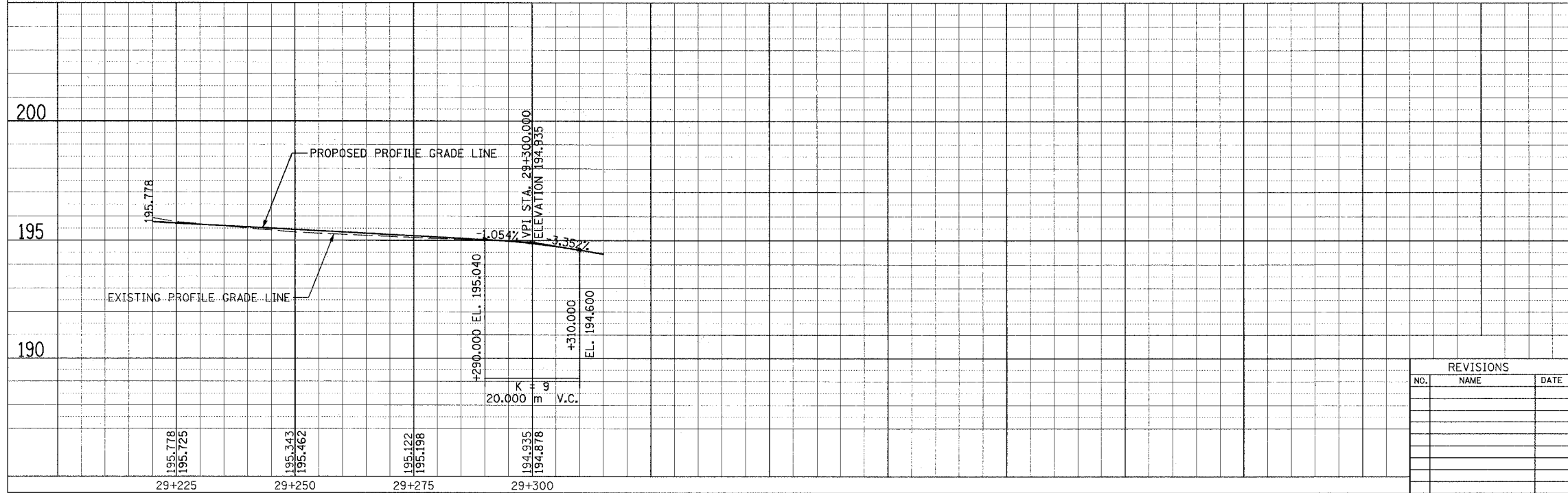

REVISIONS		
NO.	NAME	DATE

URS 1701 GOLF ROAD, SUITE 1000 TEL (847) 228-0707
ROLLING MEADOWS, IL 60008 FAX (847) 228-1115

VILLAGE OF OAK BROOK
**SALT CREEK GREENWAY TRAIL
PLAN & PROFILE**
STA. 29+220 TO STA. 29+311.891

DATE: 09/10/04 DESIGNED BY: KLM
DRAWN BY: KLM CHECKED BY: DDL