

F.A.U. RTE.	SECTION	COUNTY	TOTAL SHEETS	SHEET NO.
1441	00-00059-00-BR	KANE	154	43
STA. N/A		TO STA. N/A		
FED. ROAD DIST. NO.		ILLINOIS FED. AID PROJECT		

### WEEP HOLE LOCATIONS

NORTHING	EASTING	NORTHING	EASTING
1887967.66	991494.22	1887888.91	991495.99
1887961.66	991494.35	1887882.91	991496.13
1887955.66	991494.49	1887876.96	991498.20
1887949.67	991494.62	1887870.96	991498.34
1887943.67	991494.76	1887865.96	991498.45
1887937.67	991494.89	1887866.07	991503.45
1887931.67	991495.03	1887860.96	991498.56
1887925.67	991495.16	1887861.56	991503.05
1887919.67	991495.30	1887854.96	991498.36
1887913.67	991495.43	1887848.96	991498.50
1887907.68	991495.57	1887842.96	991498.64
1887901.68	991495.71	1887836.96	991498.58
1887894.91	991495.86	1887831.16	991497.12

### DRAINAGE STRUCTURE SCHEDULE

NO.	NORTHING	EASTING	TYPE	ELEVATION	
				RIM	INVERT
C	1888047.21	991484.56	SW DRAIN	662.24	660.24
D	1888029.57	991485.03	SW DRAIN	662.22	659.88
E	1888010.51	991486.53	SW DRAIN	662.24	659.70
F	1887987.87	991492.79	SW DRAIN	662.18	660.18
G	1888019.57	991485.29	"T"	N/A	659.52
H	1888019.34	991476.67	OUTFALL	N/A	658.50
I	1887870.20	991507.51	DOWNSPOUT	662.80	659.80
J	1887865.21	991507.61	"L"	N/A	659.50
K	1887864.76	991487.62	OUTFALL	N/A	667.50

### DRAINAGE PIPE SCHEDULE

NO.	FROM	TO	SIZE	TYPE	LENGTH	SLOPE
2	C	D	4"	PVC	18'	2.00%
3	D	G	4"	PVC	10'	3.60%
4	E	G	4"	PVC	9'	2.00%
5	F	E	4"	PVC	24'	2.00%
6	G	H	6"	PVC	9'	11.33%
7	I	J	4"	PVC	5'	6.00%
8	J	K	4"	PVC	20'	10.00%

NOTE: CONTRACTOR TO VERIFY DIMENSION FOR TOTAL DEPTH OF CONCRETE PAVERS AND COMPACTED SAND LAYER WITH CONCRETE PAVEMENT MANUFACTURER FOR EACH STYLE OF CONCRETE PAVER PRIOR TO CONSTRUCTION.

### TABLE OF KEY POINTS

NO.	NORTHING	EASTING	ELEV.	NOTES
01	1888059.87	991527.11	667.11	
02	1888055.37	991527.23	667.20	MATCH EX
03	1888059.72	991521.53	667.26	
04	1888055.23	991522.02	667.35	MATCH EX
05	1888156.10	991502.55	665.83	
06	1888051.62	991503.08	665.83	
07	1888055.96	991498.48	665.47	
08	1888051.50	991498.63	665.47	
09	1888055.82	991492.98	665.41	
10	1888051.32	991493.13	665.41	
11	1888031.47	991499.15	663.87	
12	1888031.33	991493.65	663.81	
13	1888026.47	991499.28	663.87	
14	1888026.33	991493.78	663.81	
15	1888007.23	991499.79	662.33	
16	1888007.08	991494.28	662.30	
17	1888001.93	991499.93	662.33	
18	1888001.61	991494.43	662.30	
19	1888058.46	991474.46	662.33	
20	1888058.77	991477.90	662.34	
21	1888055.50	991477.90	662.33	
22	1888055.57	991492.99	662.33	
23	1888039.79	991493.43	662.33	
24	1888039.34	991476.28	662.33	
25	1888047.21	991484.56	662.24	DRAIN
26	1888019.80	991493.95	662.33	
27	1888019.38	991478.17	662.33	
28	1888029.57	991485.03	662.22	DRAIN
29	1888001.41	991485.47	662.33	STAIRS
30	1888001.28	991479.82	662.33	STAIRS
31	1888002.15	991479.80	662.33	
32	1888010.51	991486.53	662.24	DRAIN
33	1887974.37	991500.65	662.33	
34	1887974.28	991496.76	662.33	
35	1887974.04	991486.09	662.33	
36	1887987.87	991492.79	662.18	DRAIN
37	1887971.39	991486.15	662.36	
38	1887966.40	991491.27	662.40	
39	1887906.02	991492.08	663.06	HIGH POINT
40	1887906.16	991498.27	663.06	HIGH POINT
41	1887897.33	991492.42	663.00	
42	1887897.47	991498.49	663.00	
43	1887897.52	991500.80	663.00	
44	1887878.02	991493.18	662.80	
45	1887878.02	991493.30	662.80	
46	1887876.52	991493.36	N/A	CENTER
47	1887876.58	991494.86	662.74	
48	1887868.43	991495.04	662.57	
49	1887868.57	991501.46	662.71	STAIRS
50	1887868.70	991507.37	662.82	STAIRS
51	1887863.70	991507.15	662.72	
52	1887863.56	991501.15	N/A	CENTER
53	1887857.56	991501.29	662.48	
54	1887857.93	991495.28	662.35	
55	1887839.80	991495.69	661.44	
56	1887839.38	991476.69	N/A	CENTER
57	1887830.26	991493.36	660.95	MATCH EX
58	1887839.94	991501.68	661.50	
59	1887822.90	991495.50	660.82	MATCH EX

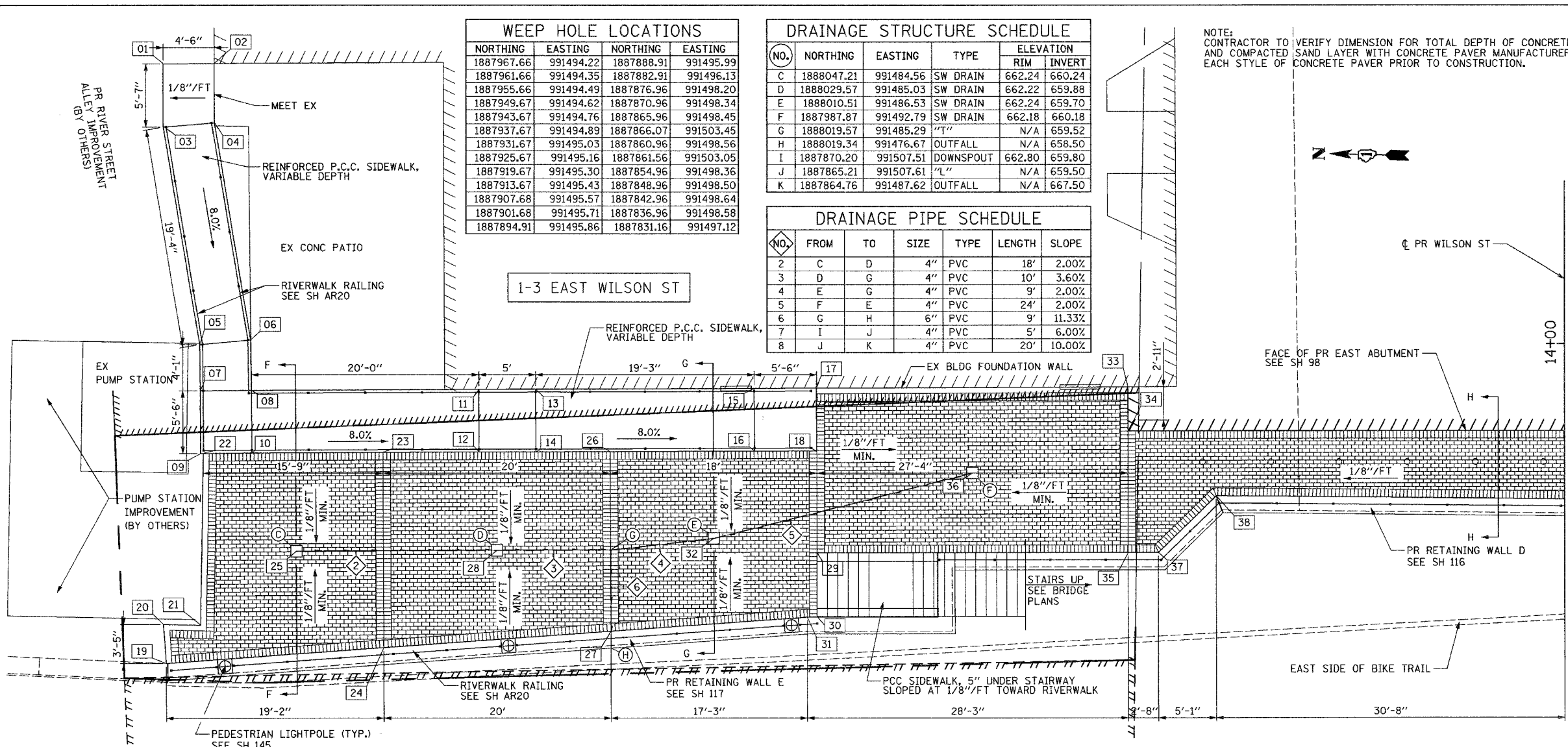

## EAST RIVERWALK - NORTH

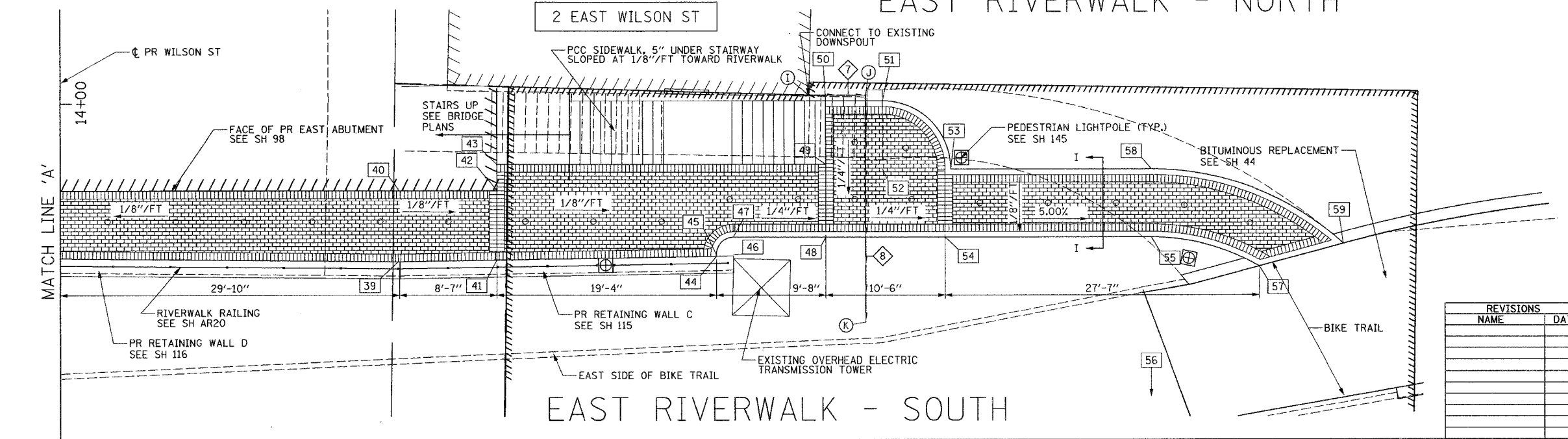

## EAST RIVERWALK - SOUTH

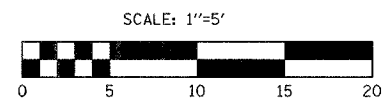

REVISIONS	NAME	DATE

ILLINOIS DEPARTMENT OF TRANSPORTATION  
 WILSON STREET  
 EAST RIVERWALK PLAN

SCALE: 1"=5'  
 DATE: 07/28/2006

DRAWN BY: WAJ  
 CHECKED BY: AKK

PLOT DATE: 7/25/2006  
 FILE NAME: I:\PROJECTS\1006\1006.dwg  
 USER: WAJ